



DEPARTMENT OF  
ENVIRONMENTAL PROGRAMS

**Worcester County**

GOVERNMENT CENTER  
ONE WEST MARKET STREET, ROOM 1306  
SNOW HILL, MARYLAND 21863  
TEL:410.632.1220 / FAX: 410.632.2012

LAND PRESERVATION PROGRAM  
STORMWATER MANAGEMENT  
SEDIMENT AND EROSION CONTROL  
SHORELINE CONSTRUCTION  
AGRICULTURAL PRESERVATION  
ADVISORY BOARD

WELL & SEPTIC  
WATER & SEWER PLANNING  
PLUMBING & GAS  
CRITICAL AREAS/FORESTRY  
COMMUNITY HYGIENE

August 4, 2020

This notification is to advise you that the Department has received and is presently reviewing the following request for a shoreline construction project:

Chester Karlewicz - Request No. 2020-072 – Request to construct a 6' x 30' pier and two (2) mooring poles not to exceed 30' channelward. This project is located at 13232 Rollie Road, Hidden Harbor, also known as Tax Map 4, Parcel 25, Lot 18, in the Fifth Tax District of Worcester County, Maryland.

The Department in considering this application will make specific findings of fact with regard to the environmental impact, navigational impact, recreational potential, commercial benefit to Worcester County, impact of the proposed construction upon the surrounding neighborhood and upon property values therein, and any other pertinent issues. Approval from the Department does not guarantee approval from any other applicable regulatory agencies.

**If you have an interest, which may be adversely affected by the issuance of this permit, you are requested to notify this Department in writing within fifteen (15) calendar days, which will end on August 19, 2020.**

Sincerely,

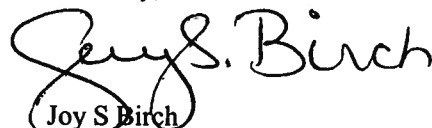
  
Joy S Birch  
Natural Resources Specialist III

cc: Interested Parties  
File



WORCESTER COUNTY
SHORELINE CONSTRUCTION
APPLICATION

Request No.: 2020-072
Submission Date: 7/4/20

[X] Major Construction (\$300.00) [ ] Minor Construction (\$150.00)

Written Description of Proposed Improvement (include channelward distance):

Install a 6' x 30' pier and two (2) mooring poles. Maximum channel ward extension of 30'.

Property Description:

Map: 0004 Parcel: 0025 Lot: 18 Section: Block: Tax District: 5

Street Address: 13232 Rollie Road, Bishopville, MD 21813

Subdivision: 0197

Dwelling on lot: [X] Dwelling under construction: Vacant: Commercial:

Owner: Chester Karlewicz Phone No.:

Mailing Address: 13232 Rollie Road, Bishopville, MD 21813

E-Mail Address: chetjk320@aol.com

Contractor: R. G. Murphy Marine Construction Phone No.: 443-497-0271

Mailing Address: 13239 Rollie Road, Bishopville, MD 21813

E-Mail Address: rgmurphy11@comcast.net

[X] Recorded Adjacent Property Owner: Mark Lowe

Property Address: 13242 Rollie Road, Bishopville, MD 21813

Tax Map: 0004 Parcel: 0025 Lot: 17 Section: Block:

[X] Recorded Adjacent Property Owner: Sousan Kunaish

Property Address: 13230 Rollie Road, Bishopville, MD 21813

Tax Map: 0004 Parcel: 0025 Lot: 19 Section: Block:

As the applicant, I attest that the information presented on this application, site plan and any written documentation attached hereto is known to be accurate. I understand that the proposed shoreline improvement will be constructed to meet or exceed minimum design standards adopted by the Department. Any deviation from these standards will require construction plans sealed by an engineer registered in the State of Maryland. I acknowledge that any falsification of information presented may result in revocation of this approval and of the subsequent Shoreline Construction Permit.

Chester Karlewicz/RWFraud POA

Owner/Applicant's Signature Date

\*\*\*\*\*
LOA = B-50
\*\*\*\*\*

DEPT. USE ONLY:

Notification Distribution Date: 8/4/20 Public Comment Deadline: 8/19/20 (15 calendar days)

Department Approval Date: Expiration:

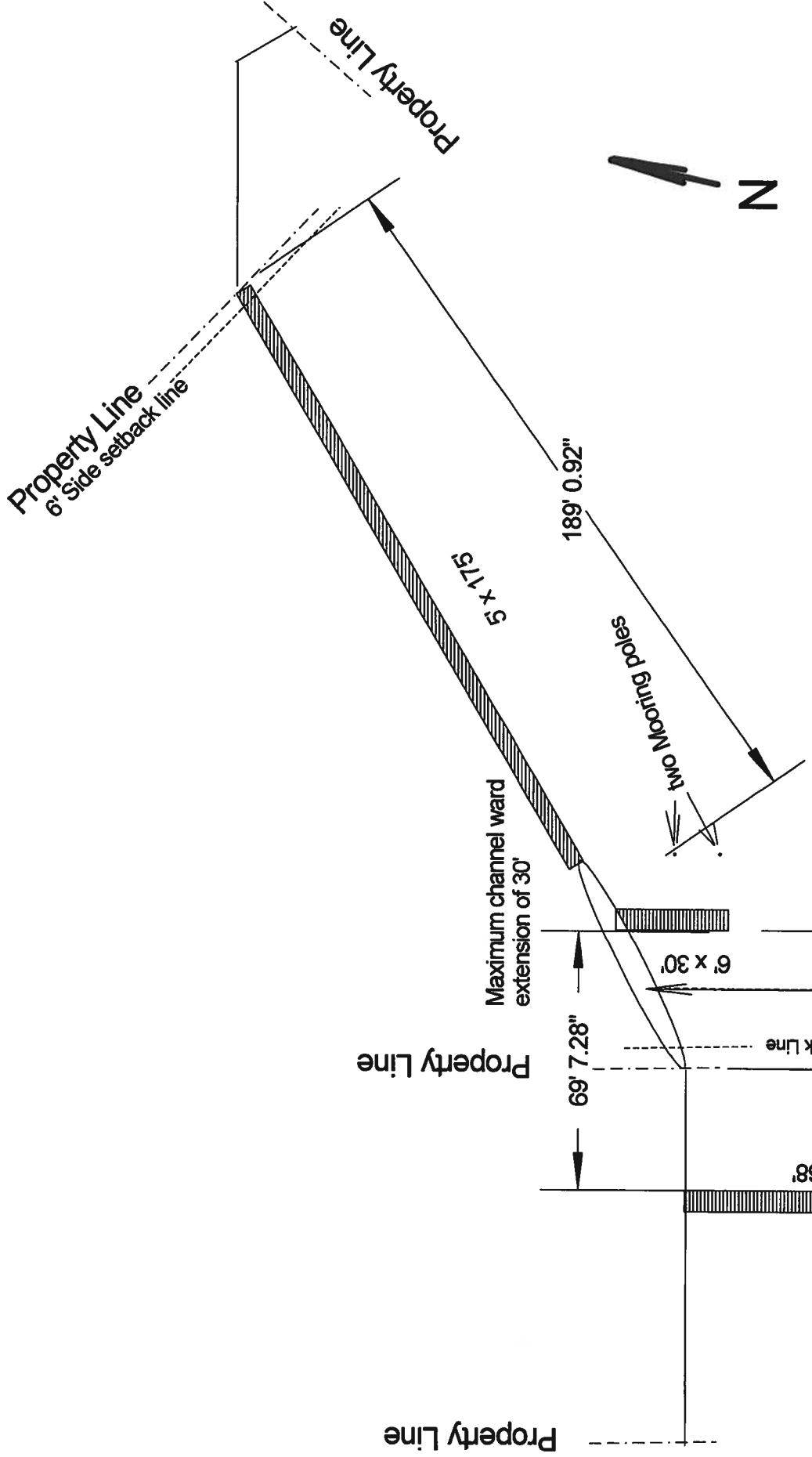

# Gray's Creek

Work Scope: Install a 6' x 30' pier with two (2) mooring poles. Maximum channel ward extension of 30'					
Scale:	1" = 40'	Approved by:		Drawn By: RWF	
Date:	July 17, 2020				
Owner:	Chester Karlewitz 13232 Rollie Road Bishopville, MD 21813	Lot	Blk	Sec	T. Map Parcel
Plat	MLW Output			Drawing Number:	

The opposite shore is in excess of 1,600' away

1. There are no known SAV beds in the area.
2. The soundings were taken June 18, 2020

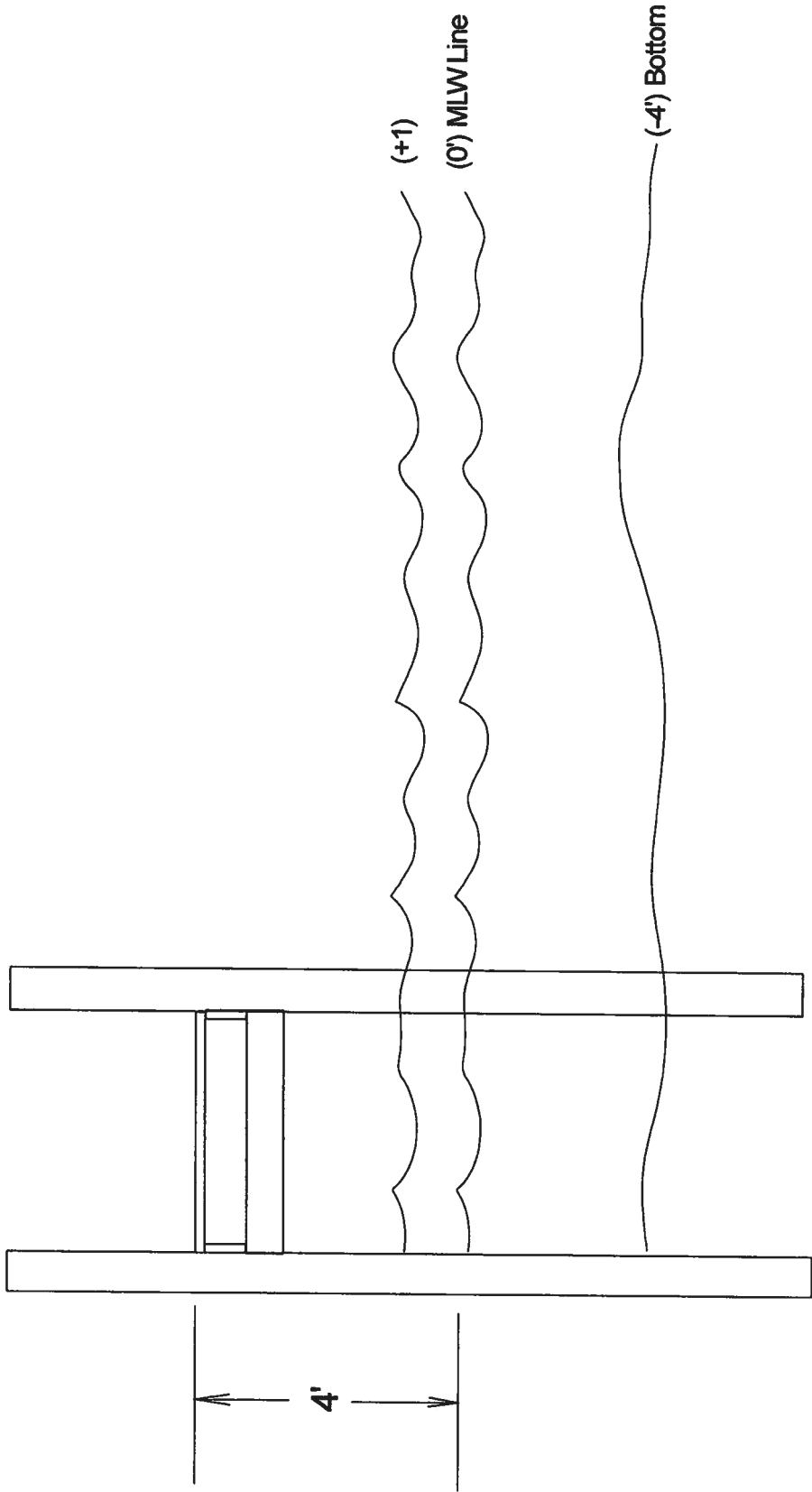

Work Scope: Pier cross section for 13232 Rollie Road E.  
 Bishopville, MD 21813

Scale: 1" = 20'

Date:

Owner:

Lot

Blk



T. Map

Parcel

# Untitled Map

Write a description for your map.

**Legend**

-  134 52nd St
-  Line Measure

13232 Rollie Rd E

100 ft



Google earth

© 2020 Google