



DEPARTMENT OF
ENVIRONMENTAL PROGRAMS

Worcester County

GOVERNMENT CENTER
ONE WEST MARKET STREET, ROOM 1306
SNOW HILL, MARYLAND 21863
TEL: 410.632.1220 / FAX: 410.632.2012

LAND PRESERVATION PROGRAM
STORMWATER MANAGEMENT
SEDIMENT AND EROSION CONTROL
SHORELINE CONSTRUCTION
AGRICULTURAL PRESERVATION
ADVISORY BOARD

WELL & SEPTIC
WATER & SEWER PLANNING
PLUMBING & GAS
CRITICAL AREAS/FORESTRY
COMMUNITY HYGIENE

May 28, 2026

This notification is to advise you that the Department has received and is presently reviewing the following request for a shoreline construction project:

Barbara Freimuth & John Dougherty Rev Living Trust - Request No. 2026-037 – Request to construct 180 linear feet of bulkhead. Max channelward extension 18”. Request to install 85’ x 6’ pier to a 10’ x20’ “T” Platform. Request to install two boat lifts. Max channelward extension 95’. This project is located at 12306 Duck Lane, Bishopville, also known as Tax Map 10, Parcel 182, Lot 5. Fifth Tax District of Worcester County, Maryland.

The Department in considering this application will make specific findings of fact with regard to the environmental impact, navigational impact, recreational potential, commercial benefit to Worcester County, impact of the proposed construction upon the surrounding neighborhood and upon property values therein, and any other pertinent issues. Approval from the Department does not guarantee approval from any other applicable regulatory agencies.

If you have an interest which may be adversely affected by the issuance of this permit, you are requested to notify this Department in writing within fifteen (15) calendar days which will end on June 12, 2026.

Sincerely,

Brandy Whitlock
Natural Resources Specialist II

cc: Interested Parties
David Bradford, Deputy Director
File



WORCESTER COUNTY
SHORELINE CONSTRUCTION
APPLICATION

Request No.: 2026-037
Submission Date: 5-28-26

X Major Construction (\$300.00) _____ Minor Construction (\$150.00)

Written Description of Proposed Improvement (include channelward distance):
To construction 180 linear feet of bulkhead 1.5 feet channelward and to install an 85 foot long
by 6 foot wide pier to a 10 ft by 20 ft T platform with two boatlifts. Max Channelward 95'

Property Description:
Map: 10 Parcel: 182 Lot: 5 Section: _____ Block: _____ Tax District: _____
Street Address: 12306 Duck Lane, Bishopville MD 21813
Subdivision: _____
 Dwelling on lot: X Dwelling under construction: _____ Vacant: _____ Commercial: _____

Owner: BARABARA A FREIMUTH REVOCABLE LIVING TRUST, JOHN P DOUGHERTY REVOCABLE LIVING TRUST Phone No. _____
Mailing Address: 12306 Duck Lane, Bishopville MD 21813
E-Mail Address: jdoc3rd@yahoo.com

Contractor: Newport Bay Marine Construction Phone No.: 724 372 3201
Mailing Address: 64 Burr Hill Drive, Berlin MD 21811
E-Mail Address: info@newportbayconstruction.com

Recorded Adjacent Property Owner: CALTON HEATHER & CARROLL GEORGE
Property Address: 12310 Duck Lane, Bishopville MD 21813
Tax Map: 10 Parcel: 182 Lot: 6 Section: _____ Block: _____

Recorded Adjacent Property Owner: COLLIER ROBERT E JR
Property Address: 12302 Duck Lane, Bishopville MD 21813 - 113 Carriage Lane Queenstown MD 21658
Tax Map: 10 Parcel: 182 Lot: _____ Section: _____ Block: _____

As the applicant, I attest that the information presented on this application, site plan and any written documentation attached hereto is known to be accurate. I understand that the proposed shoreline improvement will be constructed to meet or exceed minimum design standards adopted by the Department. Any deviation from these standards will require construction plans sealed by an engineer registered in the State of Maryland. I acknowledge that any falsification of information presented may result in revocation of this approval and of the subsequent Shoreline Construction Permit.

[Signature] 3-29-26
Owner/Applicant's Signature Date

DEPT. USE ONLY:

Notification Distribution Date: 5-28-26 Public Comment Deadline: 6-12-26 (5 calendar days)
Department Approval Date: _____ Expiration: _____

PLAN DATA AND NOTES:

- 1. TAX PARCEL NO: TAX MAP 10, PARCEL 182 (LOT 5)
- 2. SITE ADDRESS: 12306 DUCK LANE
BISHOPVILLE, MD 21813
- 3. DEED REFERENCE: 8851/0105
- 4. PROPERTY AREA: 35,000 S.F.
- 5. OWNER: BARBARA A. FREIMUTH REVOCABLE LIVING TRUST AND
JOHN P. DOUGHERTY REVOCABLE LIVING TRUST
12306 DUCK LANE
BISHOPVILLE, MD 21813
- 6. ENGINEER: CARPENTER ENGINEERING, LLC, c/o RONNIE B. CARPENTER, PE
P.O. BOX 3460, OCEAN CITY, MD 21843 (302) 438-6745 PHONE (888) 372-2844 FAX

7. THE PURPOSE OF THIS PLAN IS TO SERVE AS A REFERENCE DRAWING FOR A SHORELINE PERMIT APPLICATION PREPARED ON BEHALF OF THE PROPERTY OWNER. THE APPLICATION PROPOSES TO CONSTRUCT 180+/- LINEAR FEET OF BULKHEAD WITH A CHANNELWARD ENCROACHMENT NOT TO EXCEED 18 INCHES. ADDITIONALLY, THE APPLICATION PROPOSES THE FOLLOWING: A 85' LONG BY 6' WIDE TIMBER PIER, A 10' LONG BY 20' WIDE TIMBER PLATFORM; TWO (QUANTITY) 13' LONG BY 13' WIDE BOAT LIFTS; AND TWO (QUANTITY) 6' LONG BY 6' WIDE PWC LIFTS. THE TOTAL CHANNELWARD ENCROACHMENT SHALL NOT EXCEED 95 FEET.

8. THE CONTRACTOR IS SOLELY RESPONSIBLE FOR ALL SAFETY REGULATIONS, PROGRAMS AND PRECAUTION RELATED TO ALL WORK ON THIS PROJECT AND FOR THE PROTECTION OF PERSONS AND PROPERTY EITHER ON OR ADJACENT TO THE PROJECT AND SHALL PROTECT SAME AGAINST INJURY, DAMAGE OR LOSS.

9. THE CONTRACTOR SHALL PROTECT FROM DAMAGES EXISTING BUILDING(S), OWNER EQUIPMENT, ROADS, WALKS AND UTILITIES. THE CONTRACTOR SHALL MAINTAIN THESE DURING THE COURSE OF THE WORK, AND SHALL REPAIR ALL DAMAGES AT NO ADDITIONAL EXPENSE TO THE OWNER.

10. ALL HARDWARE SHALL BE HOT DIPPED GALVANIZED, AND EXPOSED HARDWARE SHALL BE TREATED WITH ASPHALT ROOFING CEMENT. ALL TIMBER MATERIALS SHALL BE TREATED WITH 2.5 LB TREATED LUMBER. CMI SHOREGUARD VINYL SHEET PILING SHALL BE SG-425, AND SHALL BE INSTALLED IN ACCORDANCE WITH THE MANUFACTURER'S RECOMMENDATIONS, INCLUDING FALSEWORK. SHEET PILING SHALL BE 12 FEET LONG AND SHALL BE DRIVEN TO A MINIMUM DEPTH OF 7.0 FEET.

INDEX OF SHEETS

- 1 COVER SHEET AND NOTES
- 2 LOCATION SKETCH
- 3 PLAN VIEW, ORTHOMETRIC PHOTO
- 4 PLAN VIEW, SITE PLAN
- 5 BULKHEAD CROSS SECTION
- 6 PIER CROSS SECTION
- 7 PLATFORM CROSS SECTION
- 8 BOAT LIFT SCHEMATIC DETAIL
- 9 PWC LIFT SCHEMATIC DETAIL

PROFESSIONAL CERTIFICATION:

PROFESSIONAL CERTIFICATION. I HEREBY CERTIFY THAT THESE DOCUMENTS WERE PREPARED OR APPROVE BY ME, AND THAT I AM A DULY LICENSED PROFESSIONAL ENGINEER UNDER THE LAWS OF THE STATE OF MARYLAND. LICENSE NO. 32667, EXPIRATION DATE JANUARY 17, 2028.

RONNIE B. CARPENTER, PE
PRINT NAME



32667
LICENSE NO.

05-27-2026
DATE

PLAN TO ACCOMPANY
SHORELINE PERMIT APPLICATION
TO
**LOT #5 CAPE PLEASANT
PARCEL 182, TAX MAP 10**
PREPARED FOR
JOHN P. DOUGHERTY
BISHOPVILLE, WORCESTER COUNTY, MARYLAND



**CARPENTER
ENGINEERING, LLC**

Professional Civil Engineering Services

P.O. Box 3460
Ocean City, Maryland 21843
Tel: (302) 438-6745 Fax: (888) 372-2844
Ronnie@CarpenterEngineeringLLC.com

DATE	09-15-2025	SCALE	NONE
DRAWN BY	R. CARPENTER	DRAWING NO.	7083-SP1(Rev.2)
CHECKED BY	R. CARPENTER	SHEET NO.	SP1 OF SP9

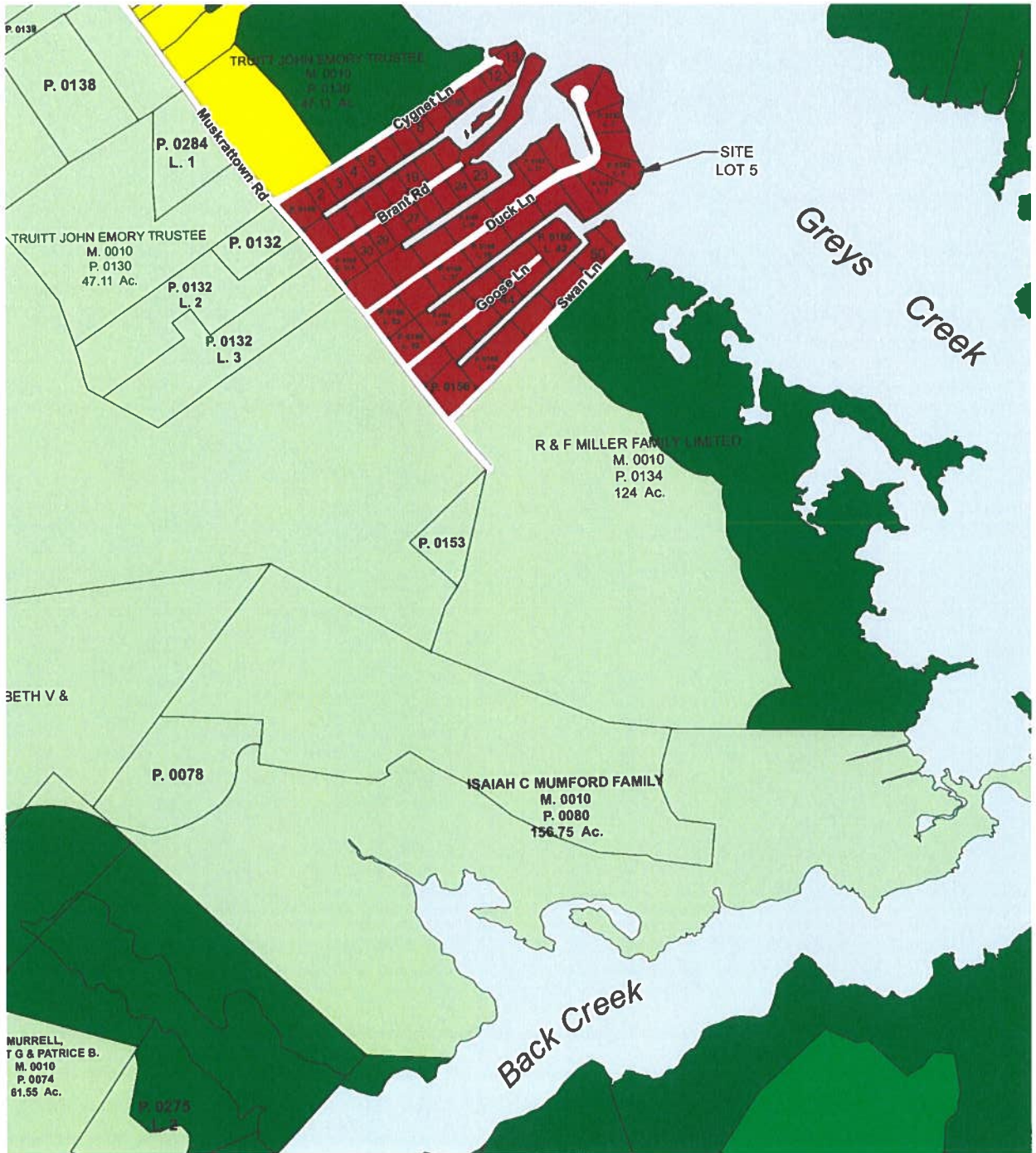

PLAN TO ACCOMPANY
SHORELINE PERMIT APPLICATION
TO
**LOT #5 CAPE PLEASANT
PARCEL 182, TAX MAP 10**
PREPARED FOR
JOHN P. DOUGHERTY

BISHOPVILLE, WORCESTER COUNTY, MARYLAND



**CARPENTER
ENGINEERING, LLC**

Professional Civil Engineering Services

P.O. Box 3460
Ocean City, Maryland 21843
Tel: (302) 438-6745 Fax: (888) 372-2844
Ronnie@CarpenterEngineeringLLC.com

DATE 09-15-2025 SCALE 1" = 800'

DRAWN BY R. CARPENTER DRAWING NO. 7083-SP2(Rev.2)

CHECKED BY R. CARPENTER SHEET NO. SP2 OF SP9

NOTE: NO SAVs WITHIN THE VICINITY OF THE PLANNED WORK / STAGING AREA



GREY'S CREEK

LOT #6

MEAN HIGH WATER FOLLOWS FACE OF EXISTING BULKHEAD

PROPOSED 10' x 20' TIMBER PLATFORM (SEE CROSS SECTION, SHEET 7)

1,200' +/- TO OPPOSITE SHORE LINE

PROPOSED PWC LIFTS, 2 QTY. (SEE CROSS SECTION, SHEET 9)

SITE LOT #5

EXISTING BULKHEAD TO REMAIN

LOT #4

PROPOSED 6' x 85' TIMBER PIER (SEE CROSS SECTION, SHEET 6)

PROPOSED BOAT LIFTS, 2 QTY. (SEE CROSS SECTION, SHEET 8)

PROPOSED TIMBER AND VINYL BULKHEAD, 180 L.F. +/- WITH A MAXIMUM CHANNELWARD ENCROACHMENT OF 18 INCHES (SEE CROSS SECTION, SHEET 5)



SIDE PROPERTY LINE PROJECTED CHANNELWARD

BATHYMETRY BASED ON M.L.W. = 0.0

PLAN TO ACCOMPANY SHORELINE PERMIT APPLICATION

TO LOT #5 CAPE PLEASANT PARCEL 182, TAX MAP 10

PREPARED FOR JOHN P. DOUGHERTY

BISHOPVILLE, WORCESTER COUNTY, MARYLAND



CARPENTER ENGINEERING, LLC

Professional Civil Engineering Services

P.O. Box 3460
Ocean City, Maryland 21843
Tel: (302) 438-6745 Fax: (888) 372-2844
Ronnie@CarpenterEngineeringLLC.com

DATE 09-15-2025 SCALE 1" = 40'
DRAWN BY R. CARPENTER DRAWING NO. 7083-SP4(Rev.2)
CHECKED BY R. CARPENTER SHEET NO. SP4 OF SP9

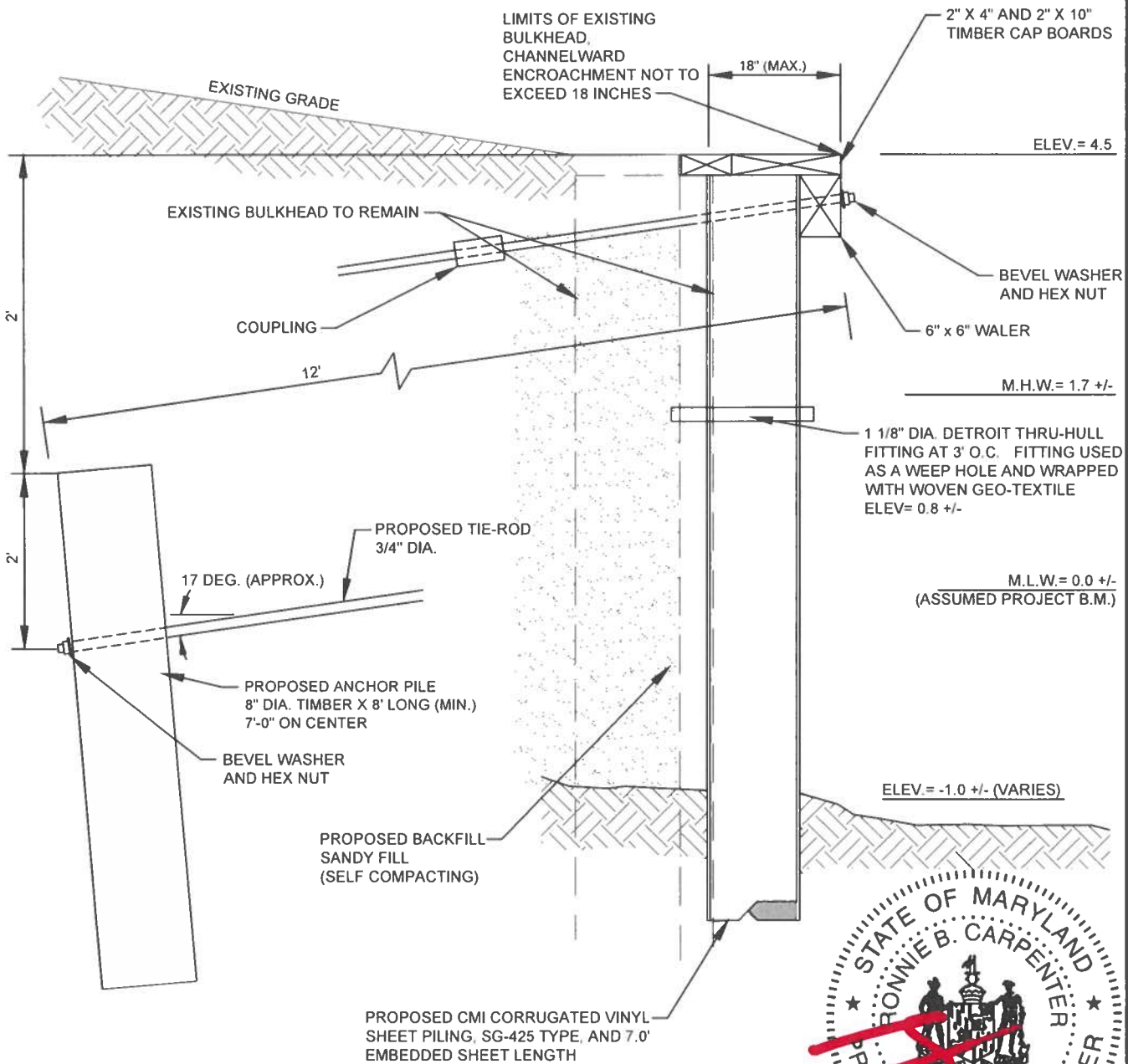

TIMBER AND VINYL BULKHEAD DETAIL
NOT TO SCALE



PLAN TO ACCOMPANY
SHORELINE PERMIT APPLICATION
TO
**LOT #5 CAPE PLEASANT
PARCEL 182, TAX MAP 10**
PREPARED FOR
JOHN P. DOUGHERTY

BISHOPVILLE, WORCESTER COUNTY, MARYLAND



Professional Civil Engineering Services
P.O. Box 3460
Ocean City, Maryland 21843
Tel: (302) 438-6745 Fax: (888) 372-2844
Ronnie@CarpenterEngineeringLLC.com

DATE 09-15-2025 SCALE NONE
DRAWN BY R. CARPENTER DRAWING NO. 7083-SP5(Rev.2)
CHECKED BY R. CARPENTER SHEET NO. SP5 OF SP9

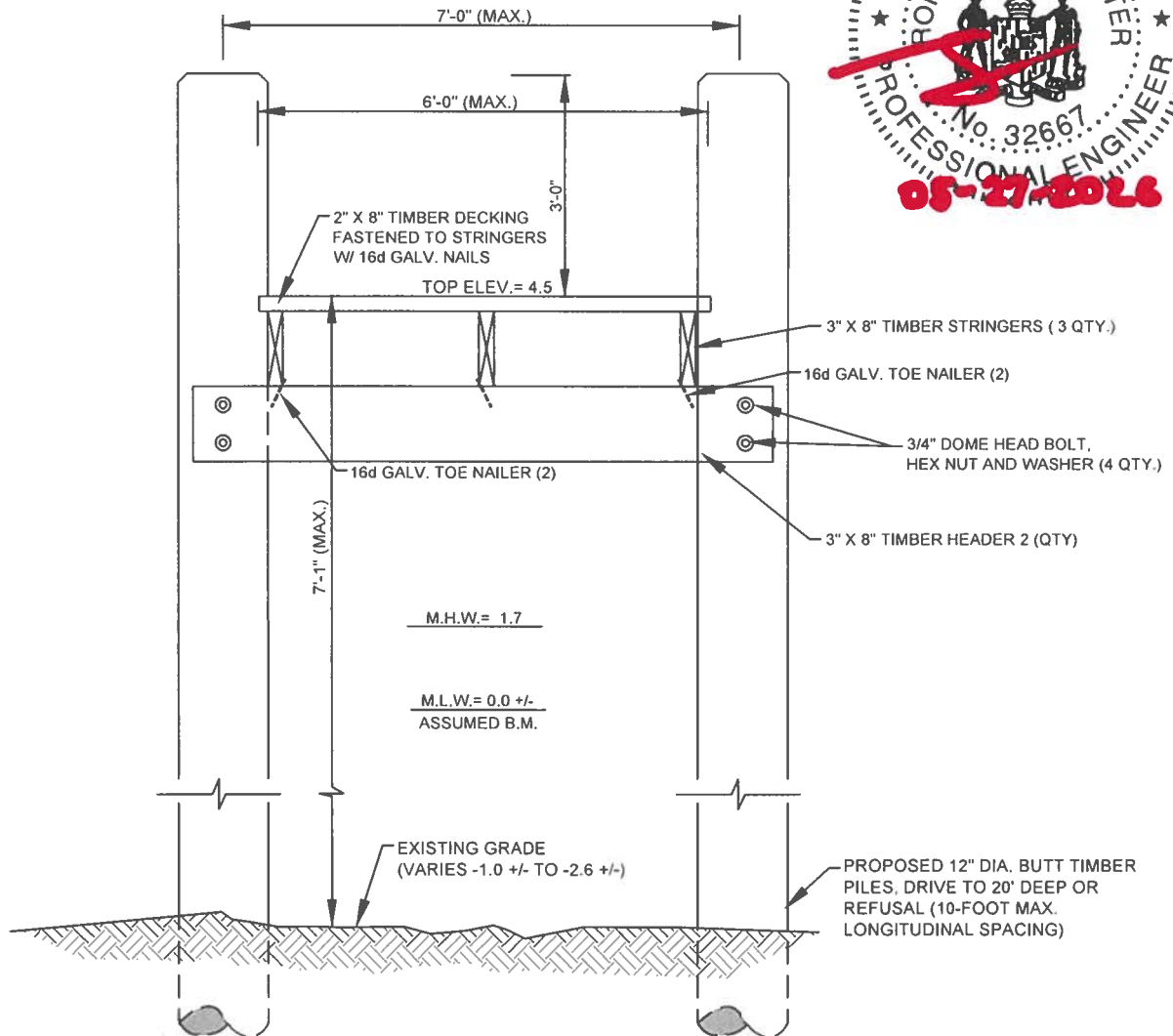

DETAIL OF 6-FOOT WIDE x 85-FOOT LONG TIMBER PIER
SCALE: NONE

PLAN TO ACCOMPANY
SHORELINE PERMIT APPLICATION
TO

**LOT #5 CAPE PLEASANT
PARCEL 182, TAX MAP 10**

PREPARED FOR

JOHN P. DOUGHERTY

BISHOPVILLE, WORCESTER COUNTY, MARYLAND



**CARPENTER
ENGINEERING, LLC**

Professional Civil Engineering Services

P.O. Box 3460
Ocean City, Maryland 21843
Tel: (302) 438-6745 Fax: (888) 372-2844
Ronnie@CarpenterEngineeringLLC.com

DATE 09-15-2025 SCALE NONE
DRAWN BY R. CARPENTER DRAWING NO. 7083-SP6(Rev.2)
CHECKED BY R. CARPENTER SHEET NO. SP6 OF SP9

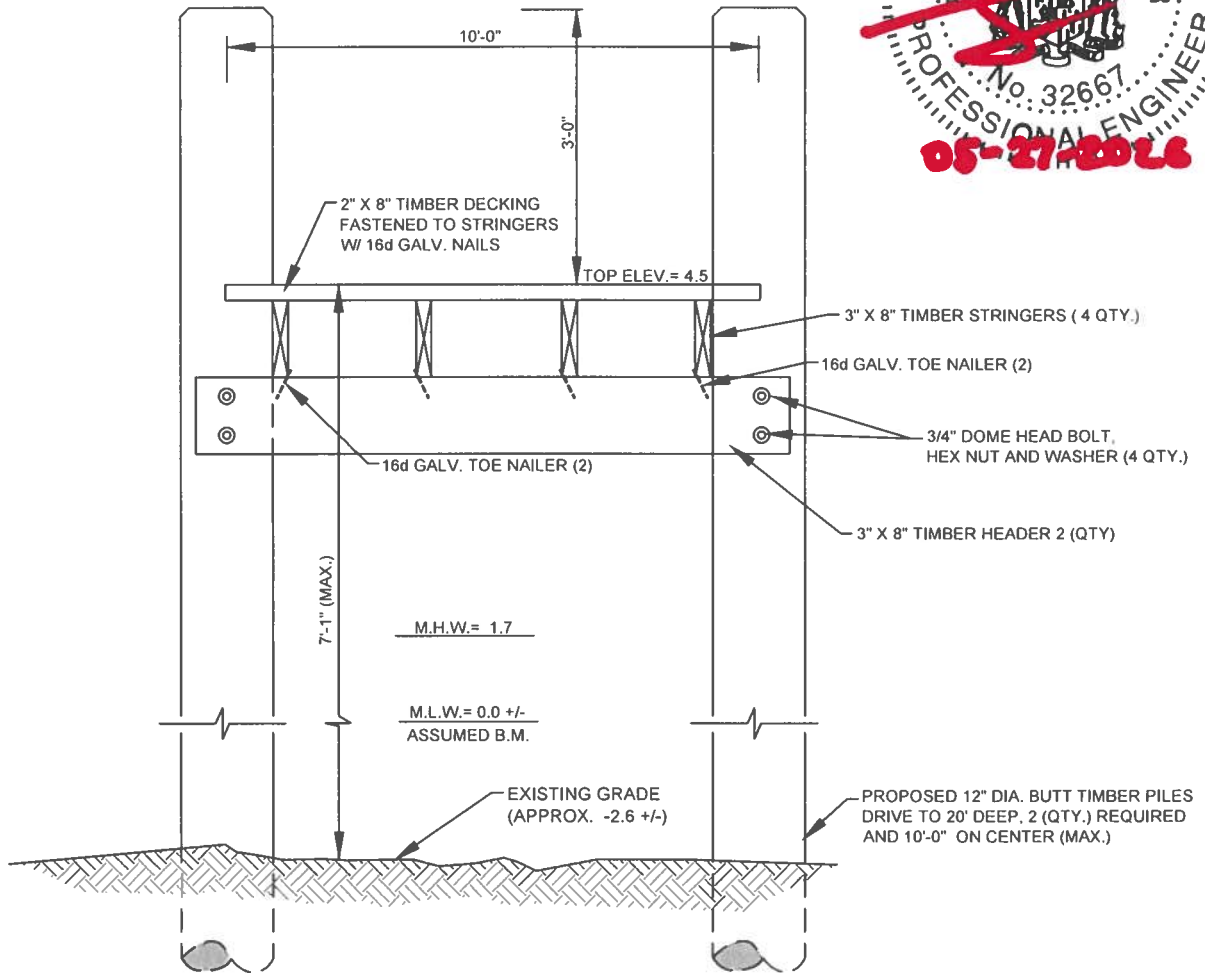
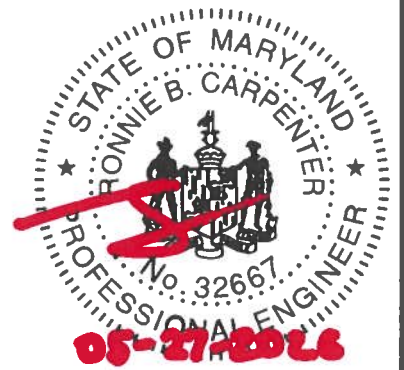

DETAIL OF 10-FOOT WIDE BY 20-FOOT LONG PLATFORM
SCALE: NONE

PLAN TO ACCOMPANY
SHORELINE PERMIT APPLICATION
TO

**LOT #5 CAPE PLEASANT
PARCEL 182, TAX MAP 10**

PREPARED FOR

JOHN P. DOUGHERTY

BISHOPVILLE, WORCESTER COUNTY, MARYLAND



**CARPENTER
ENGINEERING, LLC**

Professional Civil Engineering Services

P.O. Box 3460
Ocean City, Maryland 21843
Tel: (302) 438-6745 Fax: (888) 372-2844
Ronnie@CarpenterEngineeringLLC.com

DATE 09-15-2025 SCALE NONE
DRAWN BY R. CARPENTER DRAWING NO. 7083-SP7(Rev.2)
CHECKED BY R. CARPENTER SHEET NO. SP7 OF SP9

CAPPED PVC
GUIDE POLE

MECHANICS FOR LIFT

12'-0" +/-

13'-0" +/-
(CENTER TO CENTER)

PROPOSED TIMBER
PLATFORM. SEE SHEET 7,
ELEV.= 4.5 +/-

BOAT LIFT CARRIAGE

M.H.W.= 1.7 +/-

M.L.W.= 0 +/-

PROPOSED 12" DIA. TIMBER
PILES FOR LIFTS, DRIVEN TO
20' OR REFUSAL

EXISTING GRADE
(APPROX. -2.6 +/-)

DETAIL OF TYPICAL BOAT LIFT

SCALE: NONE



05-27-2026

PLAN TO ACCOMPANY
SHORELINE PERMIT APPLICATION
TO

**LOT #5 CAPE PLEASANT
PARCEL 182, TAX MAP 10**

PREPARED FOR

JOHN P. DOUGHERTY

BISHOPVILLE, WORCESTER COUNTY, MARYLAND



**CARPENTER
ENGINEERING, LLC**

Professional Civil Engineering Services

P.O. Box 3460

Ocean City, Maryland 21843

Tel: (302) 438-6745 Fax: (888) 372-2844

Ronnie@CarpenterEngineeringLLC.com

DATE 09-15-2025 SCALE NONE

DRAWN BY R. CARPENTER DRAWING NO. 7083-SP8(Rev.2)

CHECKED BY R. CARPENTER SHEET NO. SP8 OF SP9

CAPPED PVC
GUIDE POLE

MECHANICS FOR LIFT

7'-6" +/-

PROPOSED TIMBER
PLATFORM, SEE SHEET 7,
ELEV.= 4.5 +/-

PVC LIFT CARRIAGE

M.H.W.= 1.7 +/-

M.L.W.= 0 +/-

EXISTING GRADE
(APPROX. -2.2 +/-)

PROPOSED 12" DIA. TIMBER
PILES FOR LIFTS, DRIVEN TO
15' OR REFUSAL

DETAIL OF TYPICAL PVC LIFT

SCALE: NONE



05-27-2016

PLAN TO ACCOMPANY
SHORELINE PERMIT APPLICATION
TO

**LOT #5 CAPE PLEASANT
PARCEL 182, TAX MAP 10**

PREPARED FOR

JOHN P. DOUGHERTY

BISHOPVILLE, WORCESTER COUNTY, MARYLAND



**CARPENTER
ENGINEERING, LLC**

Professional Civil Engineering Services

P.O. Box 3460

Ocean City, Maryland 21843

Tel: (302) 438-6745 Fax: (888) 372-2844

Ronnie@CarpenterEngineeringLLC.com

DATE 09-15-2025

SCALE NONE

DRAWN BY R. CARPENTER

DRAWING NO. 7083-SP9(Rev.2)

CHECKED BY R. CARPENTER

SHEET NO. SP9 OF SP9



12306 Duck Lane, Bishopville MD