



DEPARTMENT OF
ENVIRONMENTAL PROGRAMS

Worcester County

GOVERNMENT CENTER
ONE WEST MARKET STREET, ROOM 1306
SNOW HILL, MARYLAND 21863
TEL: 410.632.1220 / FAX: 410.632.2012

LAND PRESERVATION PROGRAM
STORMWATER MANAGEMENT
SEDIMENT AND EROSION CONTROL
SHORELINE CONSTRUCTION
AGRICULTURAL PRESERVATION
ADVISORY BOARD

WELL & SEPTIC
WATER & SEWER PLANNING
PLUMBING & GAS
CRITICAL AREAS/FORESTRY
COMMUNITY HYGIENE

July 14, 2025

This notification is to advise you that the Department has received and is presently reviewing the following request for a shoreline construction project:

Augustus Papandrea - Request No. 2025-052 – Request to remove existing dock. Request to install one elevator style boat lift with associated pilings. Max channelward extension 12'. This project is located at 13 Cove Lane, Ocean Pines, also known as Tax Map 16, Parcel 38, Lot 522A. Third Tax District of Worcester County, Maryland.

The Department in considering this application will make specific findings of fact with regard to the environmental impact, navigational impact, recreational potential, commercial benefit to Worcester County, impact of the proposed construction upon the surrounding neighborhood and upon property values therein, and any other pertinent issues. Approval from the Department does not guarantee approval from any other applicable regulatory agencies.

If you have an interest which may be adversely affected by the issuance of this permit, you are requested to notify this Department in writing within fifteen (15) calendar days which will end on July 29, 2025.

Sincerely,

Brandy Whitlock
Environmental Inspector

cc: Interested Parties
David Bradford, Deputy Director
File



WORCESTER COUNTY
SHORELINE CONSTRUCTION
APPLICATION

Request No.: 2025-052
Submission Date: 7-14-25

_____ Major Construction (\$300.00)

_____ Minor Construction (\$150.00)

Written Description of Proposed Improvement (include channelward distance):

Remove existing dock - Install (1) Elevator style boat lift w/ associate pilings - Max Chnl 12'

Property Description:

Map: 0016 Parcel: 0038 Lot: 522A Section: 1 Block: _____ Tax District: _____

Street Address: 13 Cove Lane, Ocean Pines, MD 21811

Subdivision: _____

Dwelling on lot: _____ Dwelling under construction: _____ Vacant: _____ Commercial: _____

Owner: Augustus Papandrea

Phone No. 717-433-7937

Mailing Address: 1293 Geraldine Dr. Harrisburg PA 17112

E-Mail Address: irish1949@verizon.net

Contractor: Ocean City Boat Lifts & Marine Construction Inc Phone No.: 410-352-5095

Mailing Address: 12010 Industrial Park Road Unit 11 Bishopville MD 21813

E-Mail Address: oceancitylifts.kayla@aol.com

Recorded Adjacent Property Owner: Mary E Thomas & George B Thomas Revocable Trust

Property Address: 1 Dabney Ct., Rockville, MD 20853

• 19 Windjammer Rd

Tax Map: 0016 Parcel: 0038 Lot: 526 Section: _____ Block: _____

Recorded Adjacent Property Owner: Carl & Patricia Kelly

Property Address: 15 Cove Ln., Ocean Pines, MD 21842

Tax Map: 0016 Parcel: 0038 Lot: 521A Section: _____ Block: _____

As the applicant, I attest that the information presented on this application, site plan and any written documentation attached hereto is known to be accurate. I understand that the proposed shoreline improvement will be constructed to meet or exceed minimum design standards adopted by the Department. Any deviation from these standards will require construction plans sealed by an engineer registered in the State of Maryland. I acknowledge that any falsification of information presented may result in revocation of this approval and of the subsequent Shoreline Construction Permit.

Augustus Papandrea 6/30/25
Owner/Applicant's Signature Date

DEPT. USE ONLY:

Notification Distribution Date: 7-14-25 Public Comment Deadline: 7-29-25 (15 calendar days)

Department Approval Date: _____ Expiration: _____

Site:	13 Cove LN Berlin MD 21811	Property Owner:	Papandrea	Project ID:	25-245	Plan:	Existing	Notes:	Ocean City Boat Lifts (410) 352-5095 oceancitylifts.kayla@aol.com
Scope of Work:	Remove Existing Dock - Install (1) Elevator Style lift w/ associate pilings	Scale:	1"=10'	Date:	06/03/2025	Contractor:	OC Boat Lifts		12010 Industrial Park Rd., Unit 11, Bishopville, MD 21813

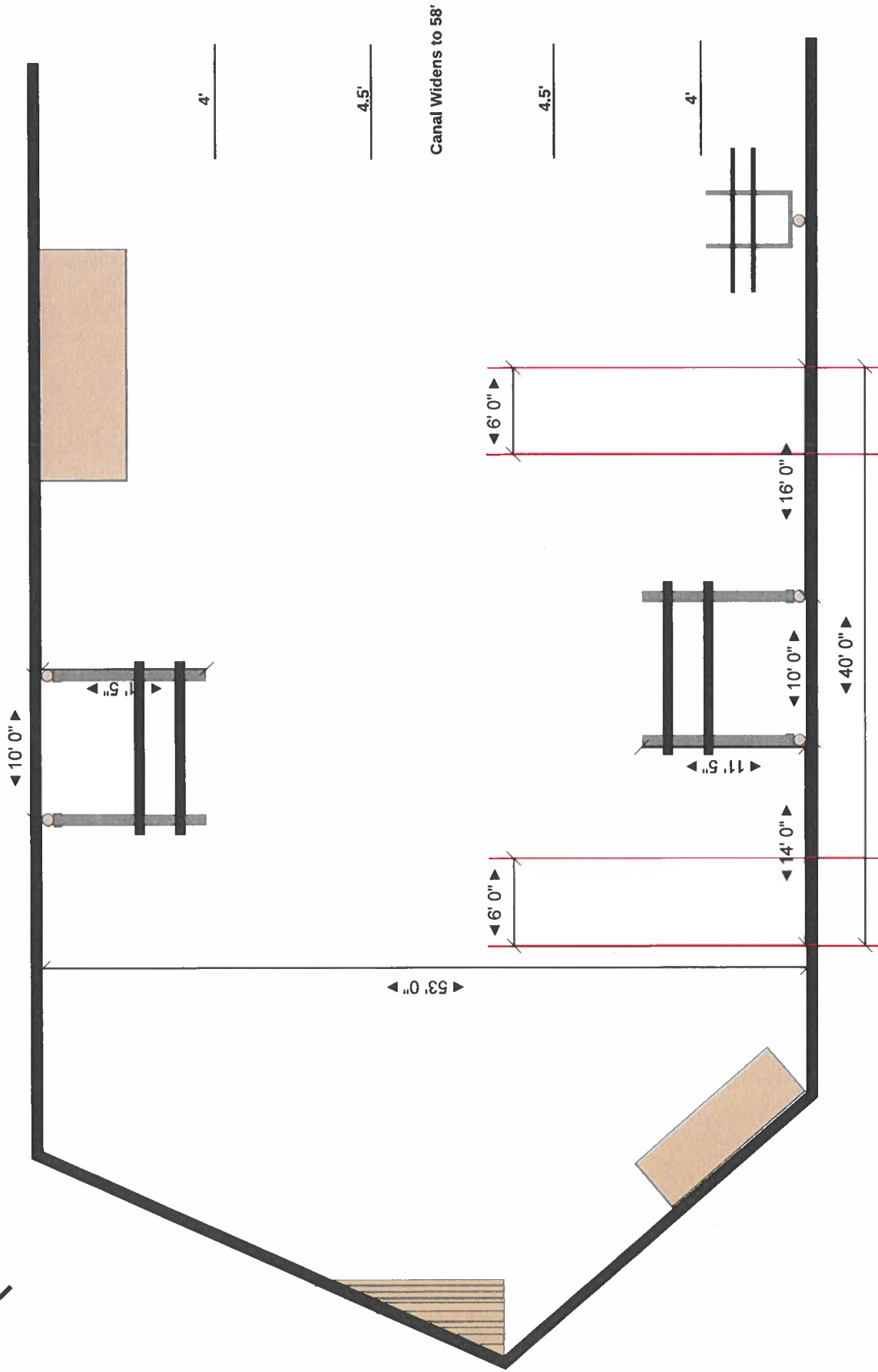

Site:	13 Cove LN Berlin MD 21811	Property Owner:	Papandrea	Project ID:	25-245	Plan:	Proposed	Notes:	Ocean City Boat Lifts (410) 352-5095 oceancitylifts.kayla@aol.com 12010 Industrial Park Rd., Unit 11, Bishopville, MD 21813
Scope of Work:	Remove Existing Dock - Install (1) Elevator Style lift w/ associate pilings	Scale:	1"=10'	Date:	06/03/2025	Contractor:	OC Boat Lifts		

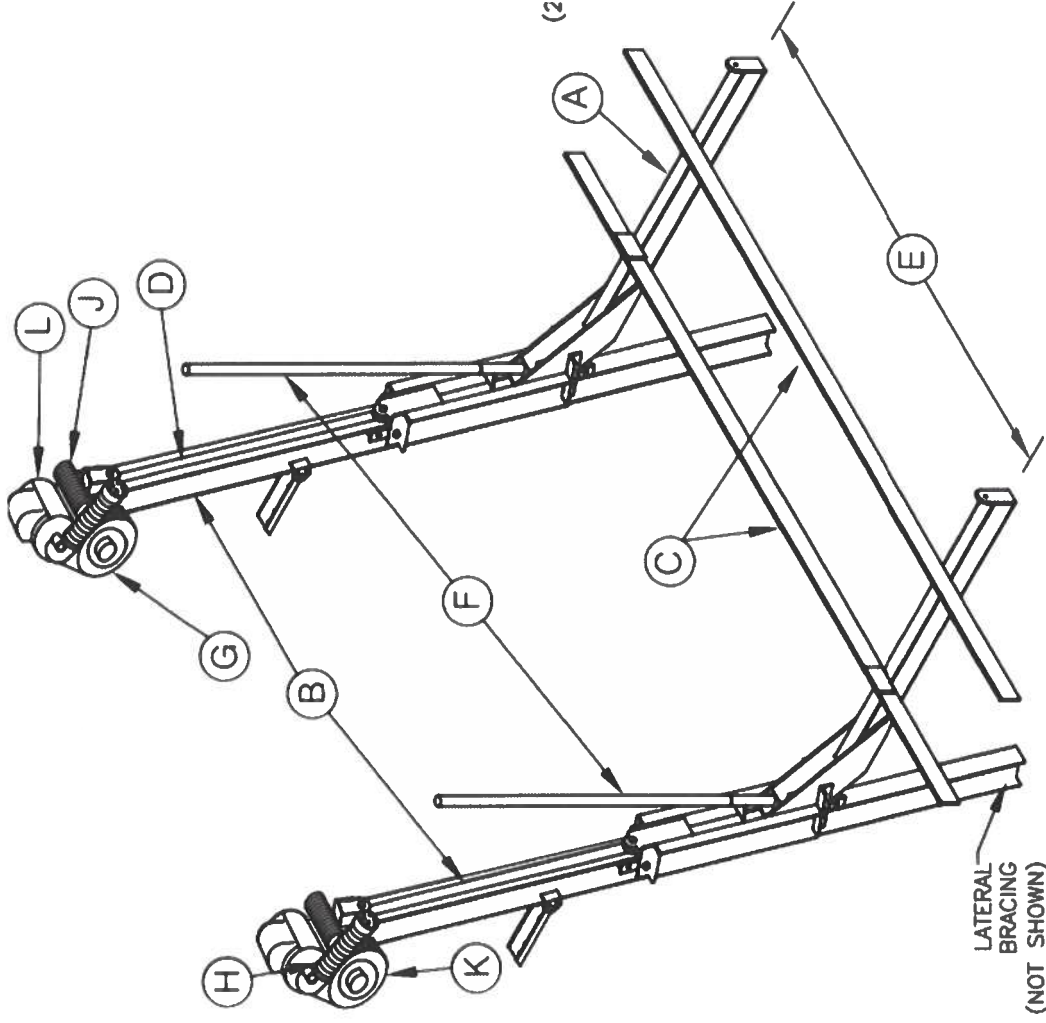

Site: 13 Cove LN Berlin MD 21811	Property Owner: Papandrea	Project ID: 25-245	Plan: Map/ Spec	Notes: -No known SAV -Max Chnl. 12'	Ocean City Boat Lifts (410) 352-5095 oceancitylifts.kayla@aol.com 12010 Industrial Park Rd., Unit 11, Bishopville, MD 21813
Scope of Work: Remove Existing Dock - Install (1) Elevator Style lift w/ associate pilings	Scale: 1"=10'	Date: 06/03/2025	Contractor: OC Boat Lifts		

