



DEPARTMENT OF  
ENVIRONMENTAL PROGRAMS

**Worcester County**

GOVERNMENT CENTER  
ONE WEST MARKET STREET, ROOM 1306  
SNOW HILL, MARYLAND 21863  
TEL: 410.632.1220 / FAX: 410.632.2012

LAND PRESERVATION PROGRAM  
STORMWATER MANAGEMENT  
SEDIMENT AND EROSION CONTROL  
SHORELINE CONSTRUCTION  
AGRICULTURAL PRESERVATION  
ADVISORY BOARD

WELL & SEPTIC  
WATER & SEWER PLANNING  
PLUMBING & GAS  
CRITICAL AREAS/FORESTRY  
COMMUNITY HYGIENE

May 21, 2025

This notification is to advise you that the Department has received and is presently reviewing the following request for a shoreline construction project:

Joseph & Mary Jo Rodgers - Request No. 2025-037 – Request to stabilize 144 linear feet of shoreline with living shoreline. Max channleward extension 20'. This project is located at 11308 Marie Dr, Bishopville, also known as Tax Map 10, Parcel 181, Lot 6. Fifth Tax District of Worcester County, Maryland.

The Department in considering this application will make specific findings of fact with regard to the environmental impact, navigational impact, recreational potential, commercial benefit to Worcester County, impact of the proposed construction upon the surrounding neighborhood and upon property values therein, and any other pertinent issues. Approval from the Department does not guarantee approval from any other applicable regulatory agencies.

**If you have an interest which may be adversely affected by the issuance of this permit, you are requested to notify this Department in writing within fifteen (15) calendar days which will end on June 5, 2025.**

Sincerely,

Brandy Whitlock  
Environmental Inspector

cc: Interested Parties  
David Bradford, Deputy Director  
File



WORCESTER COUNTY  
SHORELINE CONSTRUCTION  
APPLICATION

Request No.: 2025-037  
Submission Date: 5-21-25



Major Construction (\$300.00)

Minor Construction (\$150.00)

**Written Description of Proposed Improvement (include channelward distance):**

This project proposes to stabilize 144 linear feet of shoreline with a living shoreline.

**Property Description:**

Map: 10 Parcel: 181 Lot: 6 Section: \_\_\_\_\_ Block: \_\_\_\_\_ Tax District: 5

Street Address: 11308 Marie Drive, Bishopville, MD 21813

Subdivision: \_\_\_\_\_

Dwelling on lot: ☒ Dwelling under construction: \_\_\_\_\_ Vacant: \_\_\_\_\_ Commercial: \_\_\_\_\_

**Owner:** Mary Jo & Joseph Rodgers

Phone No. (443) 880-0342

Mailing Address: 11308 Marie Drive, Bishopville, MD 21813

E-Mail Address: maryjor9@gmail.com

**Contractor:** R.G. Murphy, LLC

Phone No.: (410) 352-5015

Mailing Address: 13239 Rollie Road E Bishopville, MD 21813

E-Mail Address: rgmurphy11@comcast.net

**Recorded Adjacent Property Owner:** Tony & Kelly Earhart

Property Address: 11300 Marie Dr, Bishopville, MD 21813

Tax Map: 10 Parcel: 181 Lot: 5 Section: \_\_\_\_\_ Block: \_\_\_\_\_

**Recorded Adjacent Property Owner:** Joseph + Mary Jo Rodgers

Property Address: Marie Ct, Bishopville, MD 21813

Tax Map: 10 Parcel: 181 Lot: 7 Section: \_\_\_\_\_ Block: \_\_\_\_\_

As the applicant, I attest that the information presented on this application, site plan and any written documentation attached hereto is known to be accurate. I understand that the proposed shoreline improvement will be constructed to meet or exceed minimum design standards adopted by the Department. Any deviation from these standards will require construction plans sealed by an engineer registered in the State of Maryland. I acknowledge that any falsification of information presented may result in revocation of this approval and of the subsequent Shoreline Construction Permit.

Mary Jo Rodgers April 16, 2025  
Owner/Applicant's Signature Date

DEPT. USE ONLY:

Notification Distribution Date: 5-21-25 Public Comment Deadline: 6-5-25 (15 calendar days)

Department Approval Date: \_\_\_\_\_ Expiration: \_\_\_\_\_

# SHORELINE PERMIT DRAWINGS

## PREPARED FOR

### MARY JO RODGERS

#### IN THE FIFTH ELECTION DISTRICT

#### WORCESTER COUNTY, MARYLAND

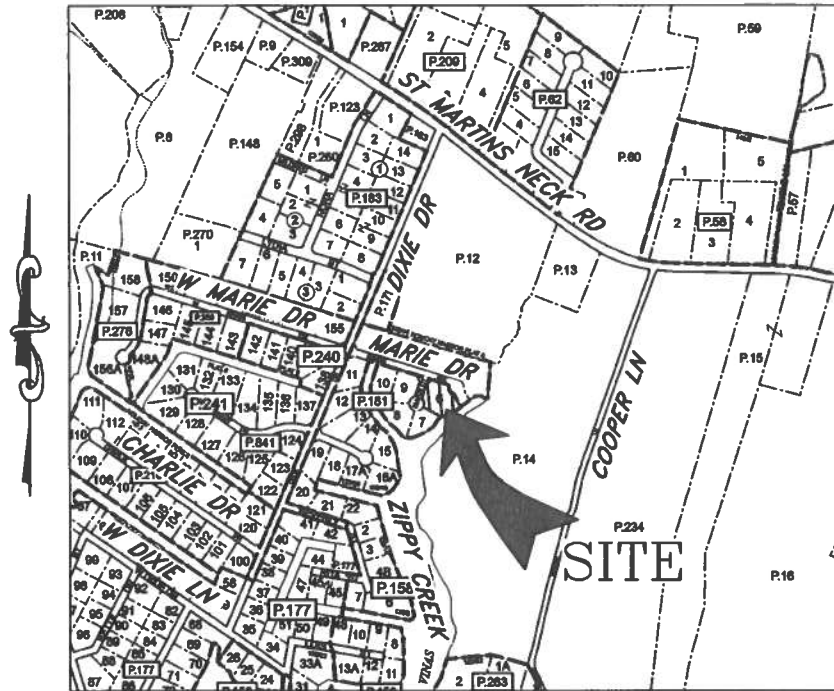

**VICINITY MAP**  
SCALE: 1" = 1,000'

**ENGINEER**

**Lane Engineering, LLC**  
117 BAY STREET  
EASTON, MARYLAND 21601  
(410) 822-8003

**OWNER/DEVELOPER**

**MARY JO & JOSEPH RODGERS**  
11308 MARIE DRIVE  
BISHOPVILLE, MD 21813  
(443) 880-0342

**PROJECT LOCATION**

11308 MARIE DRIVE  
BISHOPVILLE, MD 21813

ISSUE FOR:	DATE:	BY:	No.	DATE:	REVISION:	BY:

FILE NO. 240583	JOB NO. 240583	SCALE: AS NOTED	DATE: AS NOTED	SHEET NO.  1	TITLE SHEET		<div>Lane Engineering, LLC</div> <div>Established 1986</div> <div>Civil Engineers • Land Planning • Land Surveyors</div> <div></div> <div>E-mail: general@leinc.com</div> <div>117 Bay St. Easton, MD 21601 (410) 822-8003</div> <div>15 Washington St. Cambridge, MD 21613 (410) 221-0818</div> <div>354 Pennsylvania Ave. Centreville, MD 21617 (410) 758-2095</div>
					ON THE LANDS OF		
					JOSEPH C. RODGER & MARY JO RODGERS		
					IN THE FIFTH ELECTION DISTRICT, WORCESTER COUNTY TAX MAP 10, GRID 20, PARCEL 181, LOT 6		
Date: 05/20/2025 - 4:18pm User: efreund Project Manager: SJF Drawing Path: J:\2024\0500\240583\CMI3D-240583\Draw\Plots\HMP-PLTS-240583.dwg   Sheet XREF File(s): RAR-BASE-240583\RLD-BASE-240583\GBS-BASE-LETR-240583\CSP-BASE-MARINE-240583							

## LEGEND & ABBREVIATIONS

MHW MEAN HIGH WATER (APPROXIMATE)  
MLW MEAN LOW WATER (APPROXIMATE)

PROPERTY LINE \_\_\_\_\_

SPOT ELEVATION/SOUNDING     x -2.15

## PROJECT NOTES

1. THE PROPERTY BOUNDARY AND EXISTING CONDITIONS SHOWN HEREON WERE TAKEN FROM GENERAL MAPS, DEED, PLAT, SITE SKETCH AND AERIAL PHOTO INTERPRETATION. THESE MAPS ARE BELIEVED TO BE THE BEST, READILY AVAILABLE SOURCE OF INFORMATION FOR MARINE PERMITTING PURPOSES. A BOUNDARY AND/OR EXISTING CONDITIONS SURVEY HAS NOT BEEN COMPLETED. LANE ENGINEERING IS NOT RESPONSIBLE FOR ANY INACCURACIES ASSOCIATED WITH THE LOCATION OF THE ABOVE REFERENCED EXISTING FEATURES AND RELATED LATERAL LINES, SETBACKS, ETC.
2. THESE DRAWINGS ARE FOR PERMIT PURPOSES ONLY AND ARE NOT TO BE USED AS AN ACCURATE CONSTRUCTION DOCUMENT.
3. SOUNDINGS SHOWN HEREON PROVIDED BY CONTRACTOR FOR PERMITTING PURPOSES ONLY.
4. TIDAL DATUM, I.E. MEAN LOW WATER ELEVATION, IS ESTIMATED FROM ENVIRONMENTAL INDICATORS SUCH AS RACK LINES, WATER MARKS, PLANT COMMUNITY COMPOSITIONS.
5. THERE IS NO SAV MAPPED IN THE SUBJECT AREA WITHIN THE LAST 5 YEARS OF MAPPING.
6. UNLESS OTHERWISE NOTED, ELEVATIONS SHOWN HEREIN ARE REFERENCED TO MEAN LOW WATER = 0.0'.
7. MEAN TIDAL RANGE = 1.12'
8. LOT SIZE = 27,297 SF±
9. DISTANCE TO CHANNEL CENTERLINE = 43'±
10. MAXIMUM CHANNELWARD ENCROACHMENT = 20'±
11. ZONING CLASSIFICATION = R-1 (RURAL RESIDENTIAL)
12. 911 ADDRESS = 11308 MARIE DR, BISHOPVILLE, MD 21813

### SITE & PROJECT NOTES

ON THE LANDS OF  
JOSEPH C. RODGER &  
MARY JO RODGERS

IN THE FIFTH ELECTION DISTRICT, WORCESTER COUNTY  
TAX MAP 10, GRID 20, PARCEL 181, LOT 6

### Lane Engineering, LLC

Established 1986  
Civil Engineers • Land Planning • Land Surveyors



E-mail: general@leinc.com  
117 Bay St. Easton, MD 21601 (410) 822-8003  
15 Washington St. Cambridge, MD 21613 (410) 221-0818  
354 Pennsylvania Ave. Centreville, MD 21617 (410) 758-2095

SHEET No. 2  
DATE: AS NOTED  
SCALE: AS NOTED  
JOB No. 240583  
FILE No. 240583

Date: 05/20/2025 - 4:19pm User: efreund Project Manager: SJF Drawing Path: J:\2024\0500\240583\Civil3D-240583\Draw\Plots\HMP-PLTS-240583.dwg | Sheet 2 LANE ENGINEERING, LLC  
XREF File(s): RAR-BASE-240583/RLD-BASE-240583/CBS-BASE-LETR-240583/CSP-BASE-MARINE-240583





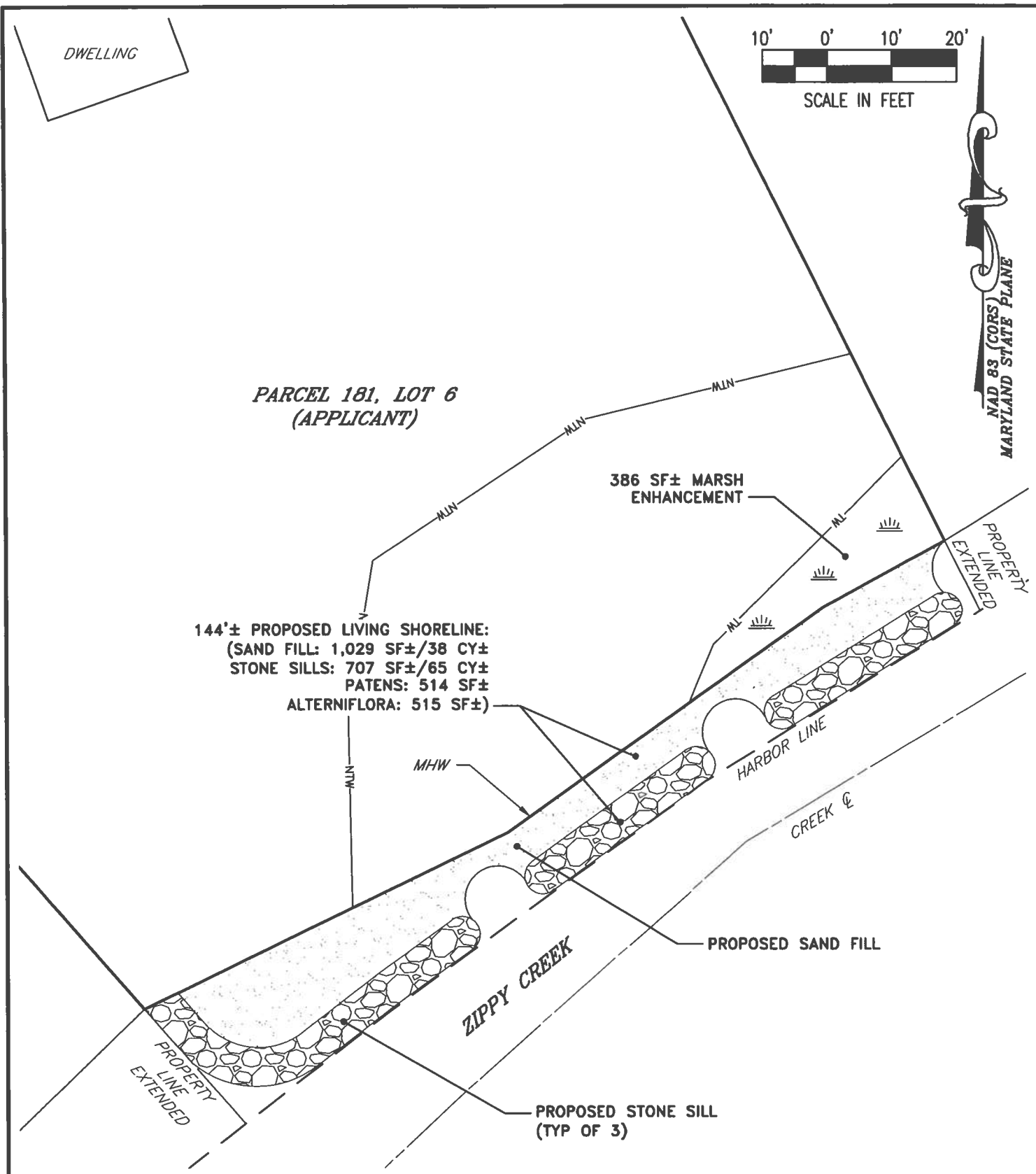

<p><b>SHEET No.</b> 5</p> <p><b>DATE:</b> AS NOTED</p> <p><b>SCALE:</b> AS NOTED</p> <p><b>JOB No.</b> 240583</p> <p><b>FILE No.</b> 240583</p>	<p><b>PROPOSED IMPROVEMENTS</b></p> <p><b>ON THE LANDS OF</b>  <b>JOSEPH C. RODGER &amp;</b>  <b>MARY JO RODGERS</b></p> <p><b>IN THE FIFTH ELECTION DISTRICT, WORCESTER COUNTY</b>  <b>TAX MAP 10, GRID 20, PARCEL 181, LOT 6</b></p>	<p><b>Lane Engineering, LLC</b></p> <p>Established 1986        Civil Engineers • Land Planning • Land Surveyors</p> <p>E-mail: general@leinc.com</p> <p>117 Bay St. Easton, MD 21601 (410) 822-8003        15 Washington St. Cambridge, MD 21613 (410) 221-0818        354 Pennsylvania Ave. Centreville, MD 21617 (410) 758-2095</p> <p>Date: 05/20/2025 -- 4:19pm User: sfreund Project Manager: SJF        XREF File(s): RAR-BASE-240583/RLD-BASE-240583/CBS-BASE-LETR-240583/CSP-BASE-MARINE-240583</p>
-----------------------------------------------------------------------------------------------------------------------------------------------------	----------------------------------------------------------------------------------------------------------------------------------------------------------------------------------------------------------------------------------------------------	-----------------------------------------------------------------------------------------------------------------------------------------------------------------------------------------------------------------------------------------------------------------------------------------------------------------------------------------------------------------------------------------------------------------------------------------------------------------------------------------------------------------------------

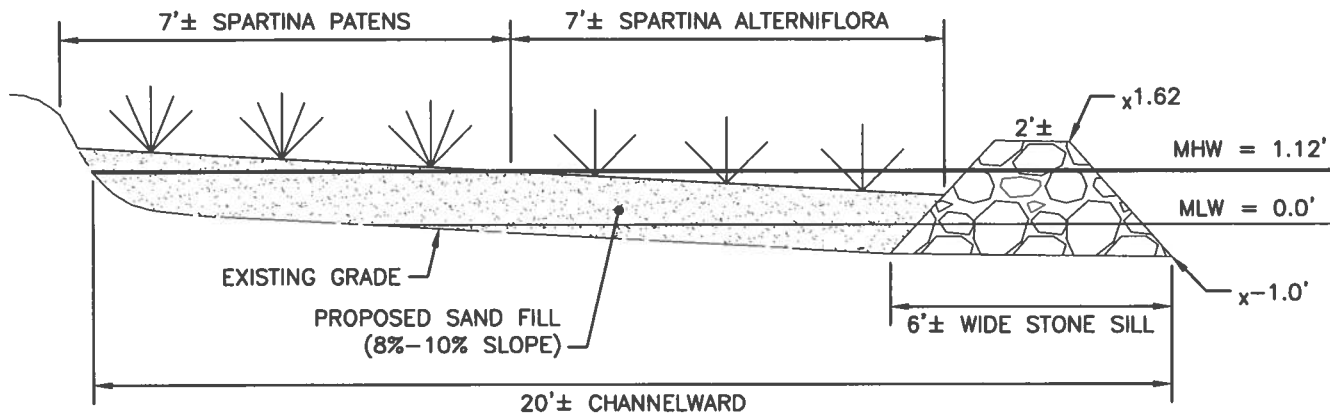

### LIVING SHORELINE DETAIL

NOT TO SCALE

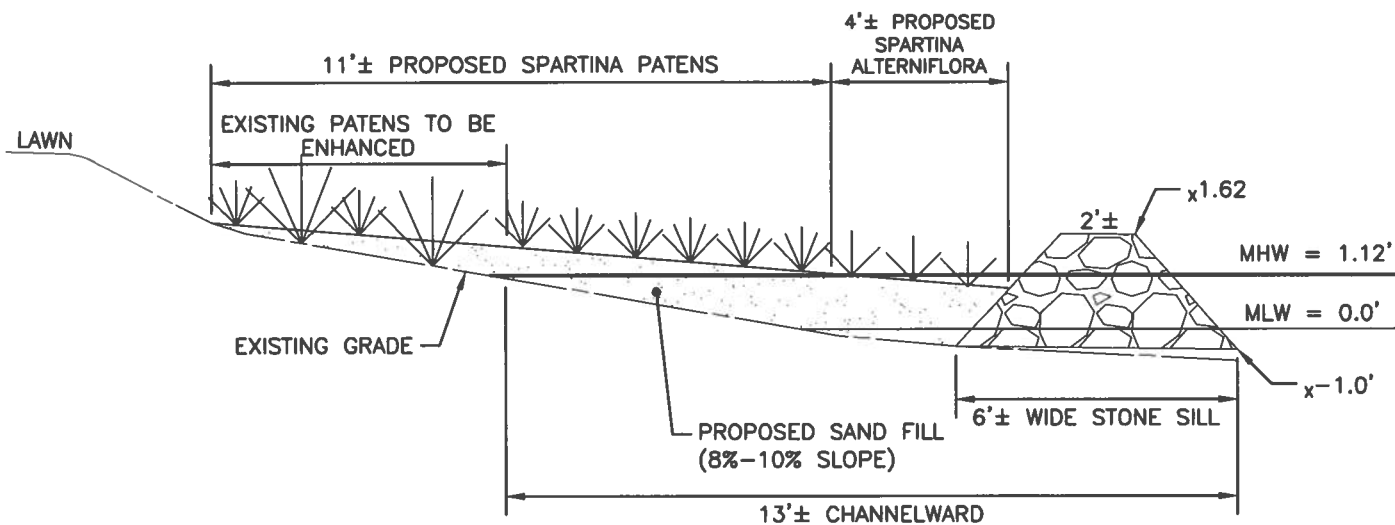

### LIVING SHORELINE DETAIL

NOT TO SCALE

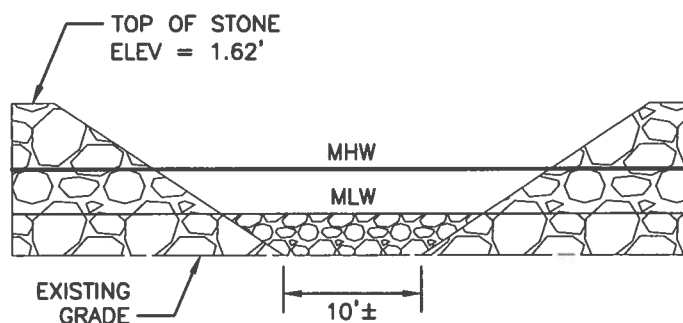

### STONE SILL VENT DETAIL

NOT TO SCALE

DATE: AS NOTED

SCALE: AS NOTED

JOB No. 240583

FILE No. 240583

SHEET No. 6

**DETAILS**

**ON THE LANDS OF**

**JOSEPH C. RODGER &**

**MARY JO RODGERS**

IN THE FIFTH ELECTION DISTRICT, WORCESTER COUNTY

TAX MAP 10, GRID 20, PARCEL 181, LOT 6

**Lane Engineering, LLC**

Established 1986

Civil Engineers • Land Planning • Land Surveyors



E-mail: general@leinc.com

117 Bay St. Easton, MD 21601 (410) 822-8003

15 Washington St. Cambridge, MD 21613 (410) 221-0818

354 Pennsylvania Ave. Centreville, MD 21617 (410) 758-2095







