



DEPARTMENT OF  
ENVIRONMENTAL PROGRAMS

**Worcester County**

GOVERNMENT CENTER  
ONE WEST MARKET STREET, ROOM 1306  
SNOW HILL, MARYLAND 21863  
TEL: 410.632.1220 / FAX: 410.632.2012

LAND PRESERVATION PROGRAM  
STORMWATER MANAGEMENT  
SEDIMENT AND EROSION CONTROL  
SHORELINE CONSTRUCTION  
AGRICULTURAL PRESERVATION  
ADVISORY BOARD

WELL & SEPTIC  
WATER & SEWER PLANNING  
PLUMBING & GAS  
CRITICAL AREAS/FORESTRY  
COMMUNITY HYGIENE

February 25, 2025

This notification is to advise you that the Department has received and is presently reviewing the following request for a shoreline construction project:

Scott Murrell- Request No. 2025-013 – Request to install two boat lifts with associated pilings. Max channelward 15'. This project is located at 12532 Selsey Rd, Ocean City, also known as Tax Map 21, Parcel 8, Lot 9-10. Tenth Tax District of Worcester County, Maryland.

The Department in considering this application will make specific findings of fact with regard to the environmental impact, navigational impact, recreational potential, commercial benefit to Worcester County, impact of the proposed construction upon the surrounding neighborhood and upon property values therein, and any other pertinent issues. Approval from the Department does not guarantee approval from any other applicable regulatory agencies.

**If you have an interest which may be adversely affected by the issuance of this permit, you are requested to notify this Department in writing within fifteen (15) calendar days which will end on March 12, 2025.**

Sincerely,

Brandy Whitlock  
Environmental Inspector

cc: Interested Parties  
David Bradford, Deputy Director  
File



WORCESTER COUNTY  
SHORELINE CONSTRUCTION  
APPLICATION

Request No.: 2025-013  
Submission Date: 2-25-25

X Major Construction (\$300.00) \_\_\_\_\_ Minor Construction (\$150.00)

**Written Description of Proposed Improvement (include channelward distance):**

install two (2) boat lifts with associated pilings a maximum of 15' channelward

**Property Description:**

Map: 21 Parcel: 8 Lot: 9-10 Section: A Block: 19 Tax District: 10  
Street Address: 12532 Selsey Road  
Subdivision: Cape Isle of Wight  
 Dwelling on lot: X Dwelling under construction: \_\_\_\_\_ Vacant: \_\_\_\_\_ Commercial: \_\_\_\_\_

Owner: Scott G. Murrell Phone No. 410-251-8332  
Mailing Address: 12532 Selsey Road, West Ocean City, MD 21842  
E-Mail Address: ocmurrell@msn.com

Contractor: J. Stacey Hart & Associates, Inc. Phone No.: 410-390-8096  
Mailing Address: PO Box 6, Snow Hill, MD 21863  
E-Mail Address: stacey@jstaceyhart.com

Recorded Adjacent Property Owner: AGG Properties LLC  
Property Address: 3900 Goose Harbor Road, Middle River, MD 21220  
Tax Map: 21 Parcel: 8 Lot: 11 Section: A Block: 19

Recorded Adjacent Property Owner: Robert & Marianna Freeman  
Property Address: 12530 Selsey Road, West Ocean City, MD 21842  
Tax Map: 21 Parcel: 8 Lot: 8 Section: A Block: 19

As the applicant, I attest that the information presented on this application, site plan and any written documentation attached hereto is known to be accurate. I understand that the proposed shoreline improvement will be constructed to meet or exceed minimum design standards adopted by the Department. Any deviation from these standards will require construction plans sealed by an engineer registered in the State of Maryland. I acknowledge that any falsification of information presented may result in revocation of this approval and of the subsequent Shoreline Construction Permit.

[Signature]  
Owner/Applicant's Signature

1/12/25  
Date

\*\*\*\*\*  
**DEPT. USE ONLY:**

Notification Distribution Date: 2-25-25 Public Comment Deadline: 3-12-25 (15 calendar days)

Department Approval Date: \_\_\_\_\_ Expiration: \_\_\_\_\_

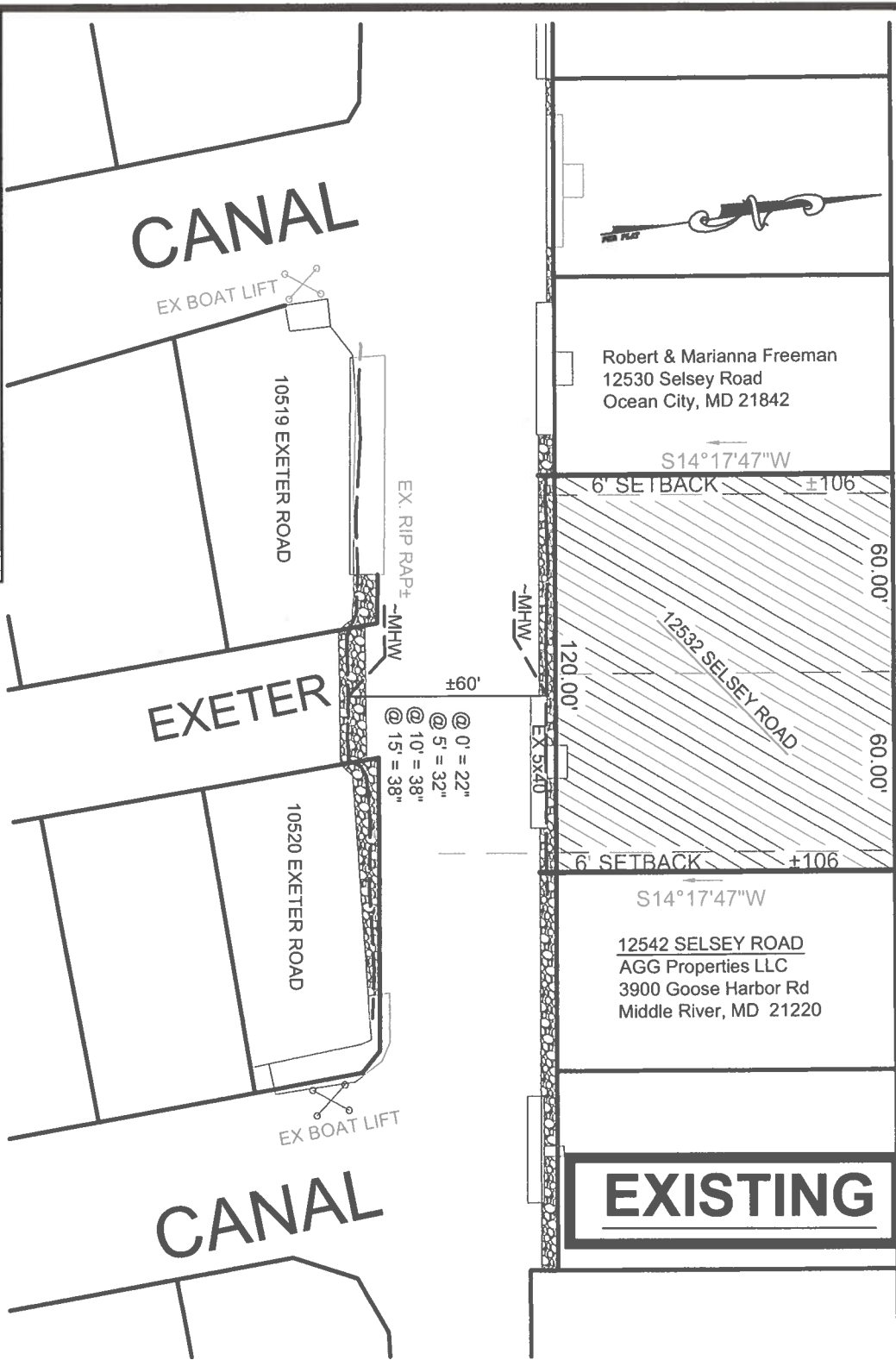
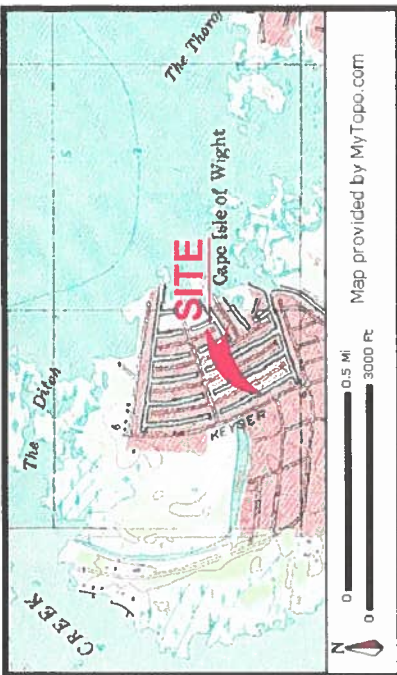

**PROJECT DESCRIPTION:**

Install two (2) boat lifts with associated pilings a maximum of 15' channelward of approximate MHW.

**MURRELL PROPERTY  
PROPOSED BOAT LIFTS  
12532 SELSEY ROAD  
WEST OCEAN CITY**

**APPLICANT:**  
Scott Murrell  
12532 Selsey Road  
West Ocean City, MD 21842  
Phone: 410-251-8332  
Email: ocmurrell@msn.com

**LOCATION:** CAPE ISLE OF WIGHT  
**WATERWAY:** UNNAMED CANAL ON ISLE OF WIGHT BAY  
**WATER DEPTH MEASUREMENTS:** 01/17/2025  
REFERENCED TO MLW 1:30 P.M.

**NO SAV'S**  
TAX MAP: 21  
PARCEL: 8  
SECTION: A  
BLOCK: 19  
LOT: 9 & 10

<b>JOB NUMBER:</b> P25-006	<b>SCALE:</b> 1"=50'	<b>SHEET NO:</b> 1 of 2	<b>DATE:</b> 02/2025	<b>REVISED:</b> n/a
-------------------------------	-------------------------	----------------------------	-------------------------	------------------------

COPYRIGHT © 2025

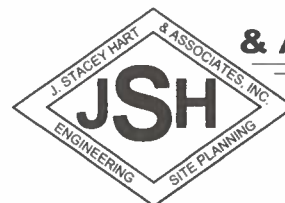

**J. STACEY HART  
& ASSOCIATES, INC.**

POST OFFICE BOX 6  
SNOW HILL, MD 21863  
PHONE: 410-390-8096  
EMAIL: stacey@jstaceyhart.com

# CANAL

EX BOAT LIFT

10519 EXETER ROAD

EX. RIP RAP ± MHW

# EXETER

10520 EXETER ROAD

EX BOAT LIFT

±60'  
@ 0' = 22"  
@ 5' = 32"  
@ 10' = 38"  
@ 15' = 38"

15' MAX  
1' MIN

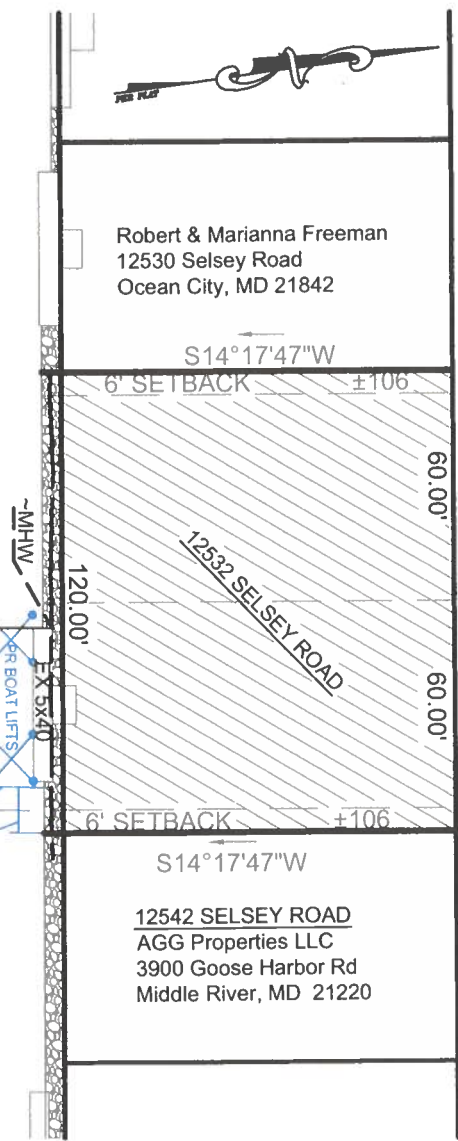

# SELSEY ROAD

Robert & Marianna Freeman  
12530 Selsey Road  
Ocean City, MD 21842

S14°17'47\"/>

6' SETBACK ±106

12532 SELSEY ROAD

120.00'

6' SETBACK ±106

S14°17'47\"/>

12542 SELSEY ROAD  
AGG Properties LLC  
3900 Goose Harbor Rd  
Middle River, MD 21220

LIFT SECTION: NO SCALE

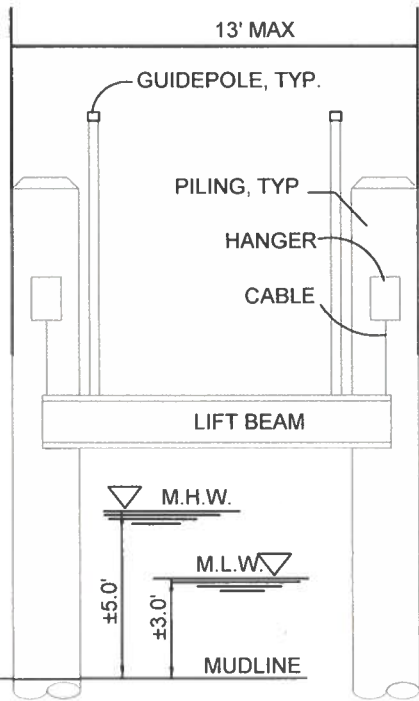

# PROPOSED

**MURRELL PROPERTY  
PROPOSED BOAT LIFTS  
12532 SELSEY ROAD  
WEST OCEAN CITY**

APPLICANT: Scott Murrell  
12532 Selsey Road  
West Ocean City, MD 21842  
Phone: 410-251-8332  
Email: ocmurrell@msn.com

COPYRIGHT © 2025

LOCATION: CAPE ISLE OF WIGHT  
WATERWAY: UNNAMED CANAL ON ISLE OF WIGHT BAY  
WATER DEPTH MEASUREMENTS: 01/17/2025  
REFERENCED TO MLW 1:30 P.M.

NO SAV'S

TAX MAP: 21  
PARCEL: 8  
SECTION: A  
BLOCK: 19  
LOT: 9 & 10

JOB NUMBER: P25-006	SCALE: 1"=50'	SHEET NO: 2 of 2	DATE: 02/2025	REVISED: n/a
------------------------	------------------	---------------------	------------------	-----------------

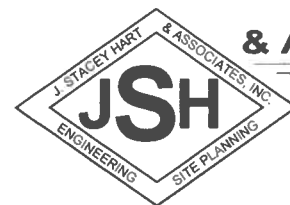

**J. STACEY HART  
& ASSOCIATES, INC.**

POST OFFICE BOX 6  
SNOW HILL, MD 21863  
PHONE: 410-390-8096  
EMAIL: stacey@jstaceyhart.com



