



DEPARTMENT OF
ENVIRONMENTAL PROGRAMS

Worcester County

GOVERNMENT CENTER
ONE WEST MARKET STREET, ROOM 1306
SNOW HILL, MARYLAND 21863
TEL: 410.632.1220 / FAX: 410.632.2012

LAND PRESERVATION PROGRAM
STORMWATER MANAGEMENT
SEDIMENT AND EROSION CONTROL
SHORELINE CONSTRUCTION
AGRICULTURAL PRESERVATION
ADVISORY BOARD

WELL & SEPTIC
WATER & SEWER PLANNING
PLUMBING & GAS
CRITICAL AREAS/FORESTRY
COMMUNITY HYGIENE

December 6, 2023

This notification is to advise you that the Department has received and is presently reviewing the following request for a shoreline construction project:

Mark Wittmyer – Request No. 2023-0101 - Request to install 48’ of replacement vinyl bulkhead with a 15’ return along side of the boat ramp. Resurface boat ramp and contain the channel ward extension of the ramp. Replace in kind 4’x48’ walkway between old and new bulkhead. Maximum of 1.5’ channelward. This project is located at 10404 New Quay Rd, Ocean City, also known as Tax map 21, Parcel 8, Lot 14. Tenth Tax District of Worcester County, Maryland.

The Department in considering this application will make specific findings of fact with regard to the environmental impact, navigational impact, recreational potential, commercial benefit to Worcester County, impact of the proposed construction upon the surrounding neighborhood and upon property values therein, and any other pertinent issues. Approval from the Department does not guarantee approval from any other applicable regulatory agencies.

If you have an interest which may be adversely affected by the issuance of this permit, you are requested to notify this Department in writing within fifteen (15) calendar days which will end on December 21, 2023.

Sincerely,

Brandy Whitlock
Environmental Inspector

cc: Interested Parties
Joy Birch
File



WORCESTER COUNTY
SHORELINE CONSTRUCTION
APPLICATION

Request No.: 2023-0101
Submission Date: 12-6-23

 Major Construction (\$300.00)

 ✓ Minor Construction (\$150.00)

Written Description of Proposed Improvement (include channelward distance):

Install 48' of replacement vinyl bulkhead with a 15' return along the side of the boat ramp. Resurface the boat ramp and contain the channel ward extension of the ramp. Replace in kind a 4' x 48' walkway between the old and new bulkheads.

Map: 0021 Parcel: 0008 Lot: 14 Section: A Block: 8 Tax District:
Street Address: 10404 New Quay Road, Ocean City, MD 21842
Subdivision: 71G3
Dwelling on lot: ✓ Dwelling under construction: Vacant: Commercial:

Owner: Mark Wittmyer Phone No. 410-430-5852
Mailing Address: 10404 New Quay Road, Ocean City, MD 21842
E-Mail Address: mjw1170@live.com

Contractor: Newport Bay Marine Construction Phone No.: 724-372-3201
Mailing Address: S. Main Street, Berlin, MD 21811
E-Mail Address: info@newportconstruction.com

Recorded Adjacent Property Owner: Bruce Howe
Property Address: 10406 New Quay Road, Ocean City, MD 21811
Tax Map: 0021 Parcel: 0008 Lot: 15 Section: A Block: 8

Recorded Adjacent Property Owner: Melissa Crawford
Property Address: 10402 New Quay Road, Ocean City, MD 21842
Tax Map: 0021 Parcel: 0008 Lot: 13 Section: A Block: 8

As the applicant, I attest that the information presented on this application, site plan and any written documentation attached hereto is known to be accurate. I understand that the proposed shoreline improvement will be constructed to meet or exceed minimum design standards adopted by the Department. Any deviation from these standards will require construction plans sealed by an engineer registered in the State of Maryland. I acknowledge that any falsification of information presented may result in revocation of this approval and of the subsequent Shoreline Construction Permit.

Mark Wittmyer
Owner/Applicant's Signature Date: 12-6-23 PSA

DEPT. USE ONLY:

Notification Distribution Date: 12-6-23 Public Comment Deadline: 12-21-23 (15 calendar days)
Department Approval Date: Expiration:

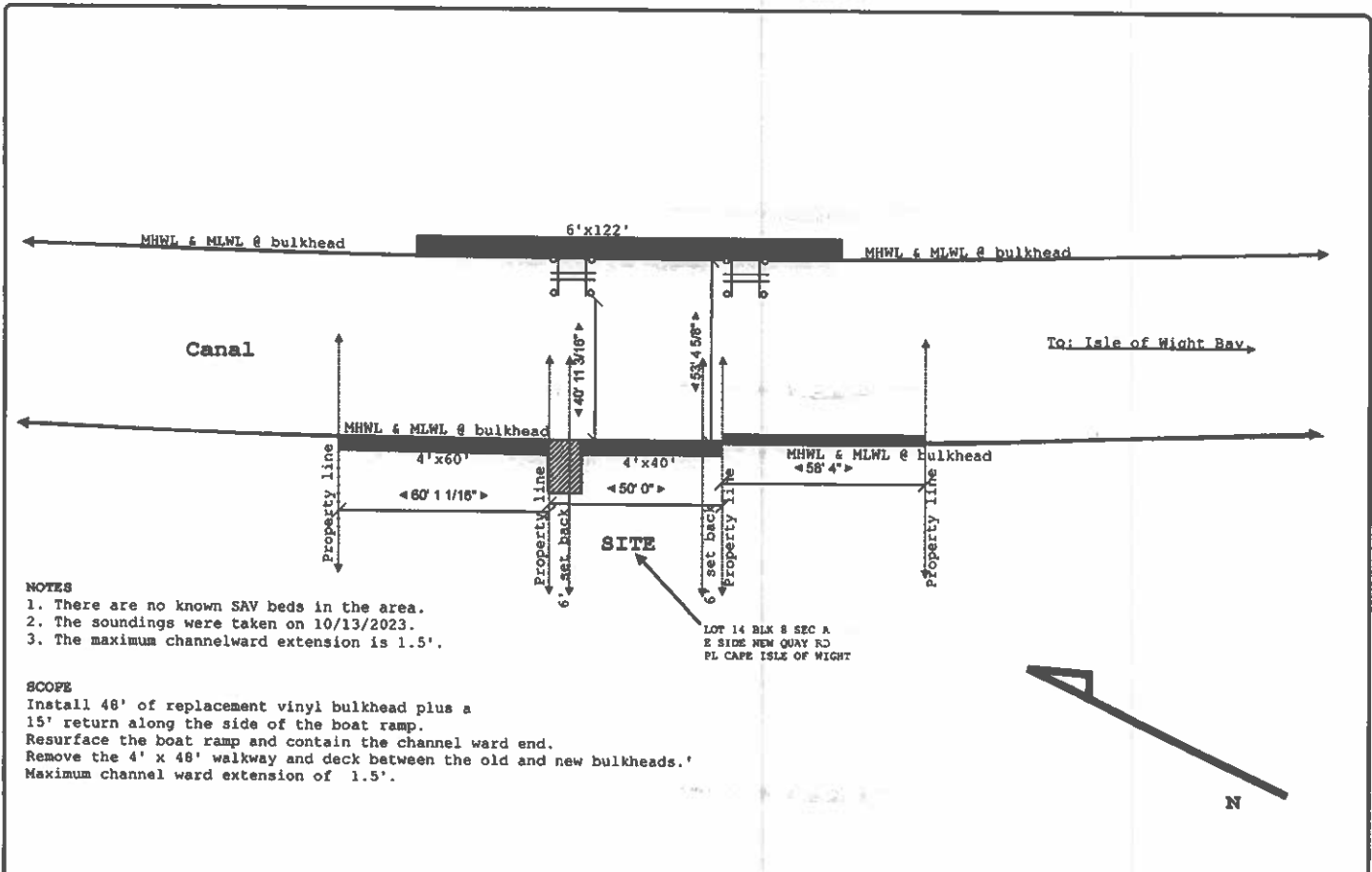

NOTES

1. There are no known SAV beds in the area.
2. The soundings were taken on 10/13/2023.
3. The maximum channelward extension is 1.5'.

SCOPE

Install 48' of replacement vinyl bulkhead plus a 15' return along the side of the boat ramp.
 Resurface the boat ramp and contain the channel ward end.
 Remove the 4' x 48' walkway and deck between the old and new bulkheads.
 Maximum channel ward extension of 1.5'.

Site:	10404 New Quay Road, OC MD	Wittmyer	Project:	1	Drawn:	Carouge	Notes:	Hidden Oak Farms, LLC
Title:	EXISTING CONDITIONS	Scale:	1/4" = 10' 0"	Date:	010/17/2023	Rev:	A	

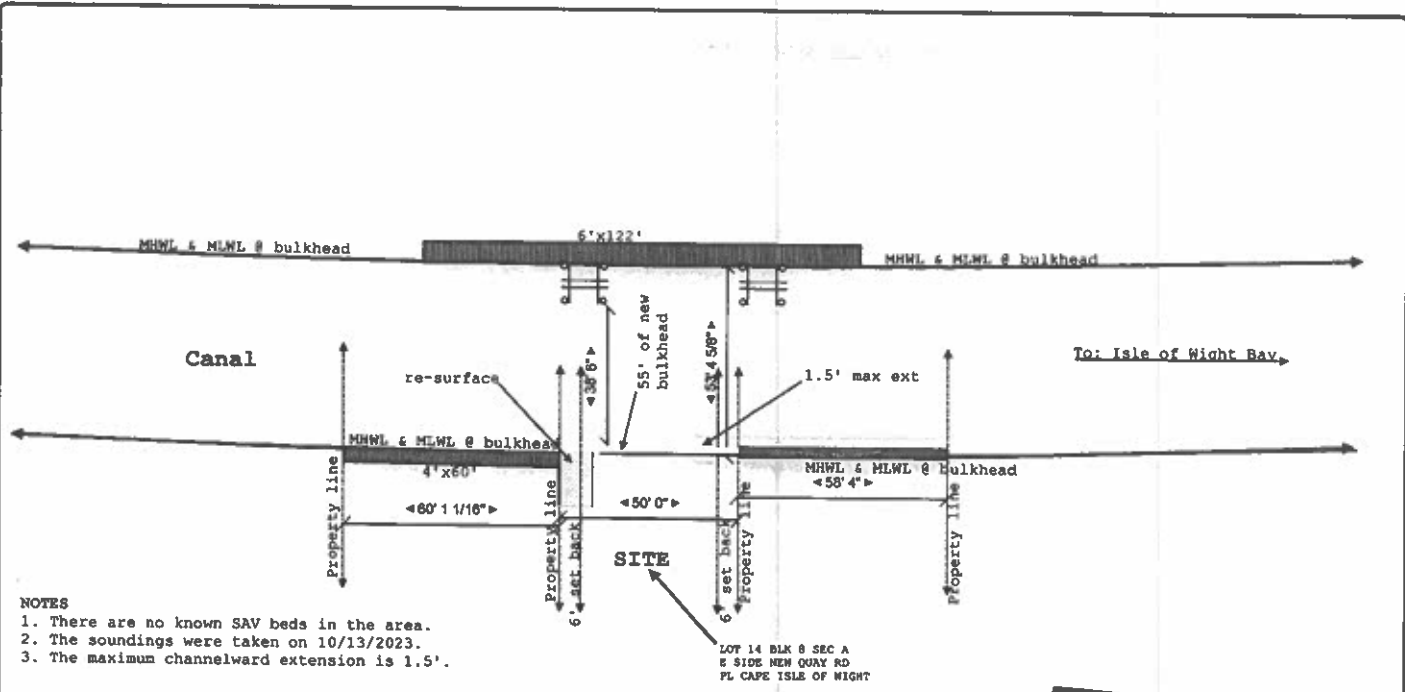

NOTES

1. There are no known SAV beds in the area.
2. The soundings were taken on 10/13/2023.
3. The maximum channelward extension is 1.5'.

SCOPE

Install 48' of replacement vinyl bulkhead plus a 15' return along the side of the boat ramp. Resurface the boat ramp and contain the channel ward end. Remove the 4' x 48' walkway and deck between the old and new bulkheads. Maximum channel ward extension of 1.5'.

LOT 14 BLK 8 SEC A
E SIDE NEW QUAY RD
PL CAPE ISLE OF WIGHT

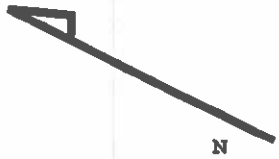

Site:	10404 New Quay Road, OC MD	Wittmayer	Project:	1	Drawn:	Carouge	Notes:	Hidden Oak Farms, LLC
Title:	PROPOSED CONDITIONS	Scale:	1/4"=10'0"	Date:	010/17/2023	Rev:		

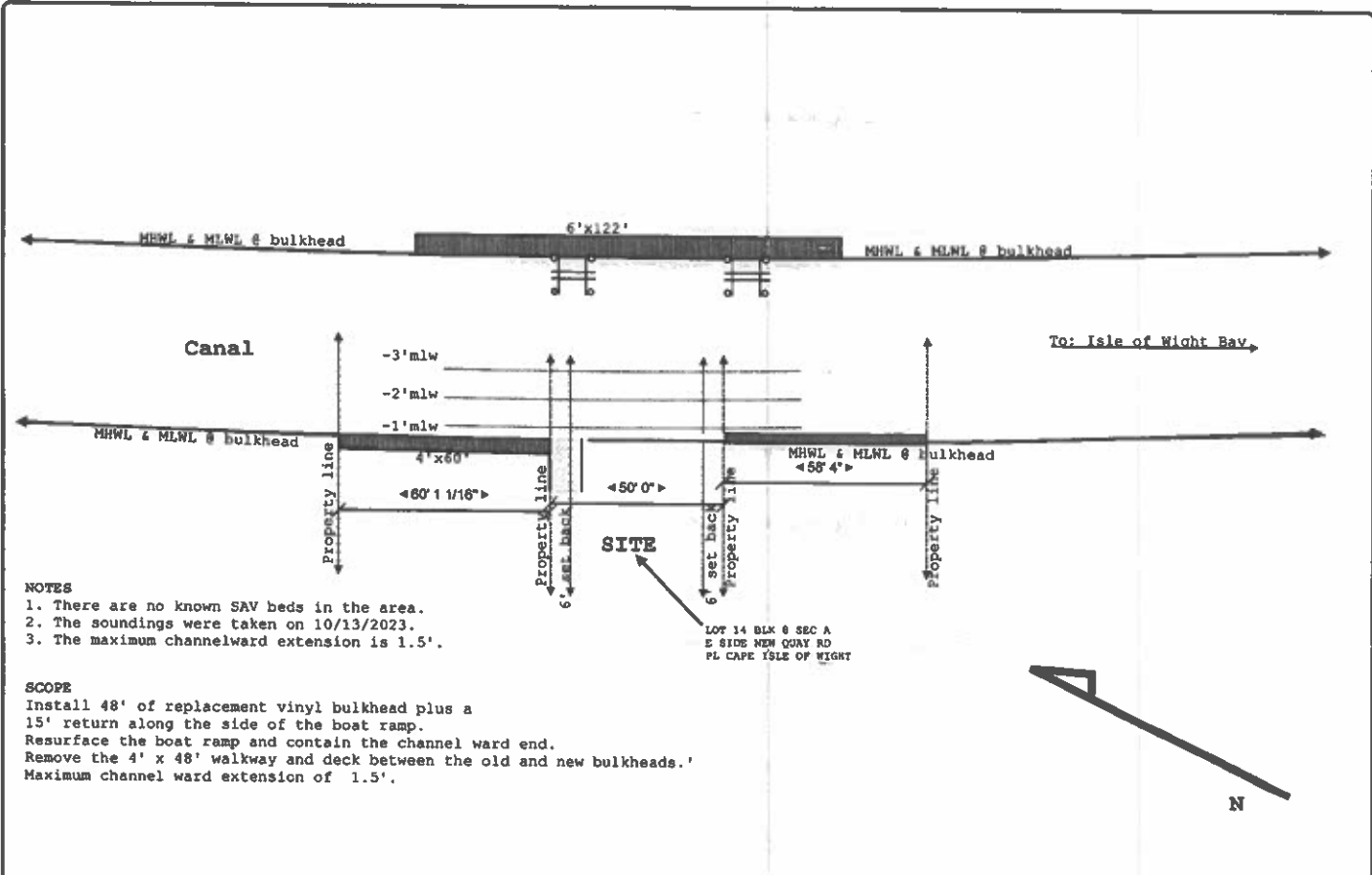

- NOTES**
1. There are no known SAV beds in the area.
 2. The soundings were taken on 10/13/2023.
 3. The maximum channelward extension is 1.5'.

SCOPE
 Install 48' of replacement vinyl bulkhead plus a 15' return along the side of the boat ramp.
 Resurface the boat ramp and contain the channel ward end.
 Remove the 4' x 48' walkway and deck between the old and new bulkheads.
 Maximum channel ward extension of 1.5'.

Site:	10404 New Quay Road, OC MD	Wittmyer	Project:	1	Drawn:	Carouge	Notes:	Hidden Oak Farms, LLC
Title:	DEPTHS	Scale:	1/4"=10'0"	Date:	010/17/2023	Rev:		

10404 New Quay Road Ocean City, MD Tierod Bulkhead System

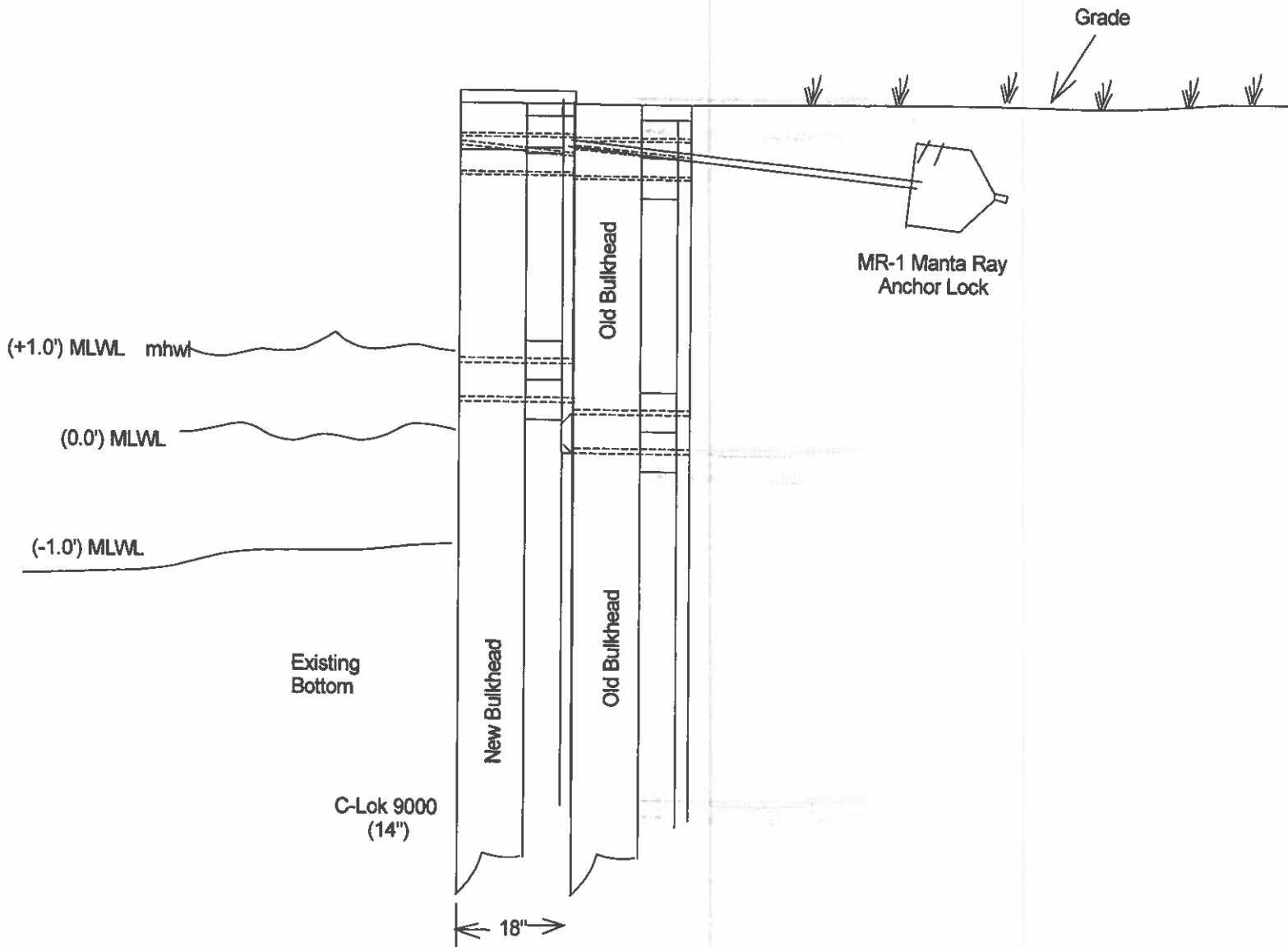

General Notes:

1. Bulkhead design will Meet or exceed Worcester County Specifications and Standards.
2. The tie back system shall be the Manta Ray MR-1 with 1" tierods.
3. The sheathing will be the C-Lok 9000 system.
4. Scale: 1/2" = 1'

