



DEPARTMENT OF
ENVIRONMENTAL PROGRAMS

Worcester County

GOVERNMENT CENTER
ONE WEST MARKET STREET, ROOM 1306
SNOW HILL, MARYLAND 21863
TEL: 410.632.1220 / FAX: 410.632.2012

LAND PRESERVATION PROGRAM
STORMWATER MANAGEMENT
SEDIMENT AND EROSION CONTROL
SHORELINE CONSTRUCTION
AGRICULTURAL PRESERVATION
ADVISORY BOARD

WELL & SEPTIC
WATER & SEWER PLANNING
PLUMBING & GAS
CRITICAL AREAS/FORESTRY
COMMUNITY HYGIENE

May 3, 2023

This notification is to advise you that the Department has received and is presently reviewing the following request for a shoreline construction project:

Bradley Burk – Request No. 2023-042 – Request to construct a 19'x6' rectangular platform and boat lift with associated pilings. Max channelward ext of 18'. This project is located at 315 Ocean Parkway, Ocean Pines, also known as Tax Map 16, Parcel 38, Lot 511. Third Tax District of Worcester County, Maryland.

The Department in considering this application will make specific findings of fact with regard to the environmental impact, navigational impact, recreational potential, commercial benefit to Worcester County, impact of the proposed construction upon the surrounding neighborhood and upon property values therein, and any other pertinent issues. Approval from the Department does not guarantee approval from any other applicable regulatory agencies.

If you have an interest which may be adversely affected by the issuance of this permit, you are requested to notify this Department in writing within fifteen (15) calendar days which will end on May 18, 2023.

Sincerely,

Brandy Whitlock
Environmental Inspector

cc: Interested Parties
David Bradford, Deputy Director
File



WORCESTER COUNTY
SHORELINE CONSTRUCTION
APPLICATION

Request No.: 2023-042
Submission Date: 5-3-23

X Major Construction (\$300.00) _____ Minor Construction (\$150.00)

Written Description of Proposed Improvement (include channelward distance):
install 6 pilings for Dock/boat slip. Docks will run parallel with
bulkhead and be 12' wide and 6' channelward. the farthest pilings
are 18' channelward.

Property Description:
Map: 0016 Parcel: 0000 Lot: 511 Section: 0038 Block: 01 Tax District: _____
Street Address: 315 Ocean Pkwy Ocean Pines, MD 21811
Subdivision: Ocean Pines
Dwelling on lot: yes Dwelling under construction: no Vacant: no Commercial: no

Owner: Bradley Burk Phone No. 443-602-5774
Mailing Address: 315 Ocean Pkwy
E-Mail Address: brad0858@gmail.com

Contractor: Blue fm construction Phone No.: 410-723-2523
Mailing Address: 106 120th st Ocean City, MD 21840
E-Mail Address: _____ MHIC-108894 MDEID-153E

Recorded Adjacent Property Owner: Raul & Maria Serrano
Property Address: 313 Ocean Pkwy Ocean Pines
Tax Map: 0016 Parcel: 0000 Lot: 510 Section: 0038 Block: 01

Recorded Adjacent Property Owner: Blais & Brandi Musselman
Property Address: 317 Ocean Pines
Tax Map: 0016 Parcel: 0000 Lot: 512 Section: 0038 Block: 01

As the applicant, I attest that the information presented on this application, site plan and any written documentation attached hereto is known to be accurate. I understand that the proposed shoreline improvement will be constructed to meet or exceed minimum design standards adopted by the Department. Any deviation from these standards will require construction plans sealed by an engineer registered in the State of Maryland. I acknowledge that any falsification of information presented may result in revocation of this approval and of the subsequent Shoreline Construction Permit.

Bradley Burk 4/19/23
Owner/Applicant's Signature Date

DEPT. USE ONLY:
Notification Distribution Date: 5-3-23 Public Comment Deadline: 5-18-23 (15 calendar days)
Department Approval Date: _____ Expiration: _____

PLAN VIEW 2 of 2

Plan sheet # 21-PR-0447/202160615
 Page 1 of 3
 03/30/2021

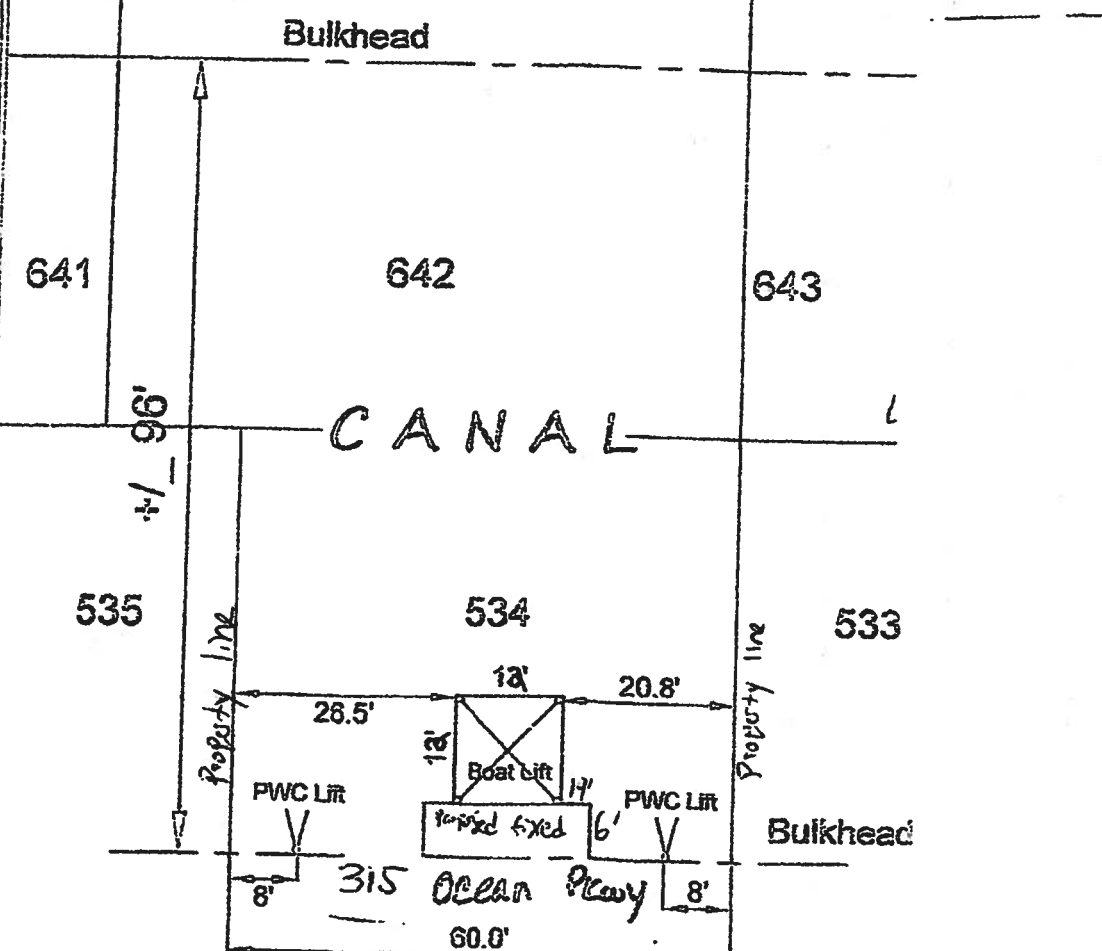

313 Ocean Pkwy
 Berlin MD 21811

Raul and Maria Serrano

Applicant
 Bradley Burk
 315 Ocean Pkwy Berlin, MD 21811
 Worcester County

project site is my horse

443-602-5774
 brad0858@gmail.com

317 Ocean Pkwy
 Berlin, MD 21811
 Brandi and Blair Musselman

Details

Dunby: PLB

Scale 1"=20'

Date: 2/18/2021

Lot C-21-571

N 38° 23' 43.811"
 W 75° 9' 2.723"

bulkhead 6.5ft
 dept at bulkhead
 3.5 mlw

← Same owner as
 - All 6' Chambers
 Platforms w/ 12' X 12' boat li:
 - same as I'm Proj

40 Driftwood

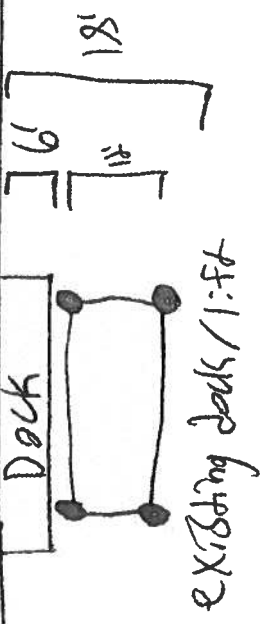

bulldozer to bulldozer 96'



Proposed dock/lift

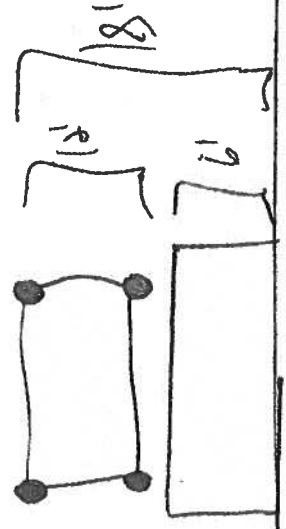

315 area PKwy

38 Driftwood 40 Driftwood

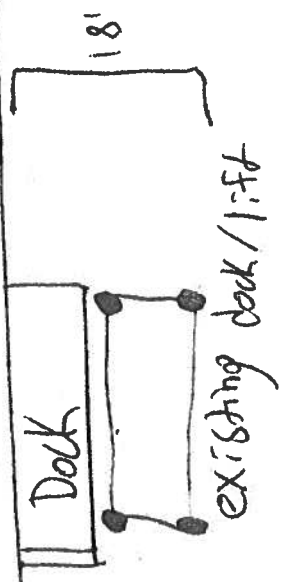

PLAN VIEW
 3 of 3

existing dock/lift

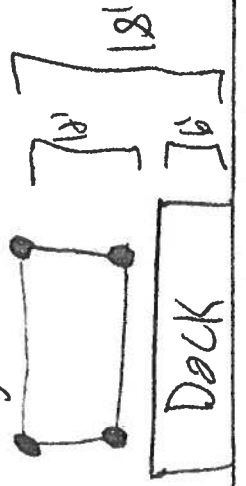

313 ocean PKwy

existing dock/

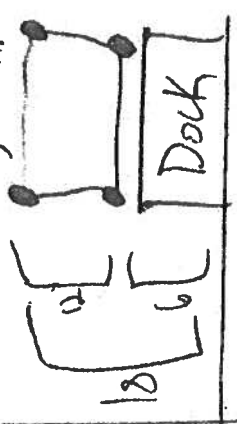

317 ocean PKwy

Construction Detail Sheet:

315 Ocean Pkwy

Install 2- 20' x 10" pilings against the bulkhead 12' apart.

Move 6' channelward and install 2- 20' x 12" pilings 12' apart.

Run pressure treated 2"x10"s from each piling to creat structure support in accordance with Worcester County Design Standards placing a stringer every 18" and thru bolting stringers to pilings as well as cross braces to pilings. Finish by using galvanized screws to secure 2"x6" decking cup side down.

Install the final 2- 25'x12" pilings 18' channelward to complete the boat slip.



Environmental Programs Web APP

Created by Worcester County Technical Services Division

Layer List	
Layers	
Property Lines	
Tax Ditches	
Watersheds	
Worcester Hydrology	
Worcester Addresses WGS84	
Worcester Centerlines	
Basemap	
Corporatelimits	
2020 1ft Contours	
Worcester_WasteWater_Utilities	
Water & Sewer	
Zoning	
Protected_Lands	
flood_hazard_areas	

0 20 40ft

-75.150 38.396 Degrees

+

-

315 Ocean Pkwy, Berlin, MI X

Show search results for 315 Oc...

Q

Esri, HERE, Gar

10