



DEPARTMENT OF  
ENVIRONMENTAL PROGRAMS

## Worcester County

GOVERNMENT CENTER  
ONE WEST MARKET STREET, ROOM 1306  
SNOW HILL, MARYLAND 21863  
TEL: 410.632.1220 / FAX: 410.632.2012

LAND PRESERVATION PROGRAM  
STORMWATER MANAGEMENT  
SEDIMENT AND EROSION CONTROL  
SHORELINE CONSTRUCTION  
AGRICULTURAL PRESERVATION  
ADVISORY BOARD

WELL & SEPTIC  
WATER & SEWER PLANNING  
PLUMBING & GAS  
CRITICAL AREAS/FORESTRY  
COMMUNITY HYGIENE

January 31, 2023

This notification is to advise you that the Department has received and is presently reviewing the following request for a shoreline construction project:

Daniel Crocker – Request No. 2023-008 – Request to install 82' of vinyl replacement bulkhead. Max channelward 18". Request to install 6'x33' parallel dock and one boat lift with associated piling. Maximum channelward extension of 22'. This project is located at 30 Leslie Mews, Ocean Pines also known as Tax Map 16, Parcel 96, Lot 61. Third Tax District of Worcester County, Maryland.

The Department in considering this application will make specific findings of fact with regard to the environmental impact, navigational impact, recreational potential, commercial benefit to Worcester County, impact of the proposed construction upon the surrounding neighborhood and upon property values therein, and any other pertinent issues. Approval from the Department does not guarantee approval from any other applicable regulatory agencies.

**If you have an interest which may be adversely affected by the issuance of this permit, you are requested to notify this Department in writing within fifteen (15) calendar days which will end on February 15, 2023.**

Sincerely,

Brandy Whitlock  
Environmental Inspector

cc: Interested Parties  
David Bradford, Deputy Director  
File



WORCESTER COUNTY SHORELINE CONSTRUCTION APPLICATION

Request No.: 2023-008 Submission Date: 1/31/23

Major Construction (\$300.00) Minor Construction (\$150.00)

Written Description of Proposed Improvement (include channelward distance):

82'ft of vinyl replacement bulkhead (18") channelward, 6'x33' parallel dock & open boat lift with associated Piling, 22' Channelward - modification from 19'ft channelward

Property Description:

Map: 0016 Parcel: 0096 Lot: 61 Section: 14B Block: - Tax District: Wor Co Street Address: 30 Leslie Mews Ocean Pines, Md 21811 Subdivision: Terns Landing Dwelling on lot: [checked] Dwelling under construction: Vacant: Commercial:

Owner: Daniel J. Crocker Phone No. 717-808-0666 Mailing Address: 1104 Sunwood Ln, Lancaster PA 17601 E-Mail Address: dancrocker@comcast.net

Contractor: Just-Rite Marine Inc. Phone No.: 410-641-9961 Mailing Address: 9316 Carey Rd, Berlin, Md 21811 E-Mail Address: mike@just-rite-marine.com

Recorded Adjacent Property Owner: Naïem S. Tanious Property Address: 28 Leslie Mews Ocean Pines, Md 21811 Tax Map: 0016 Parcel: 0096 Lot: 60 Section: 14B Block:

Recorded Adjacent Property Owner: William J. Stimely Property Address: 32 Leslie Mews Ocean Pines, Md, 21811 Tax Map: 0016 Parcel: 0096 Lot: 62 Section: 14B Block:

5710 Meyerfield Ct Eldersburg, MD 21784

As the applicant, I attest that the information presented on this application, site plan and any written documentation attached hereto is known to be accurate. I understand that the proposed shoreline improvement will be constructed to meet or exceed minimum design standards adopted by the Department. Any deviation from these standards will require construction plans sealed by an engineer registered in the State of Maryland. I acknowledge that any falsification of information presented may result in revocation of this approval and of the subsequent Shoreline Construction Permit.

[Signature] 12/31/2022 Owner/Applicant's Signature Date

\*\*\*\*\*

DEPT. USE ONLY:

Notification Distribution Date: 1/31/23 Public Comment Deadline: 2/15/23 (15 calendar days) Department Approval Date: Expiration:

**Contractor**  
**Just-Rite Marine Inc.**  
 9316 Carey Rd. mike@justritemarine.com  
 Berlin Md. 21811 www.justritemarineinc.com  
**MD Marine Lic. 083(E)**  
 MHIC# 71561 Ph: 410-641-9961  
 Ocean City # 30542

Scale 1" = 40' ft  
 No SAV's Present  
 Soundings  
 5'ft out 3.5'ft  
 10'ft out 4'ft  
 MLW 3'ft  
 MHW 4.5'ft  
 ← Isle of Wight Bay

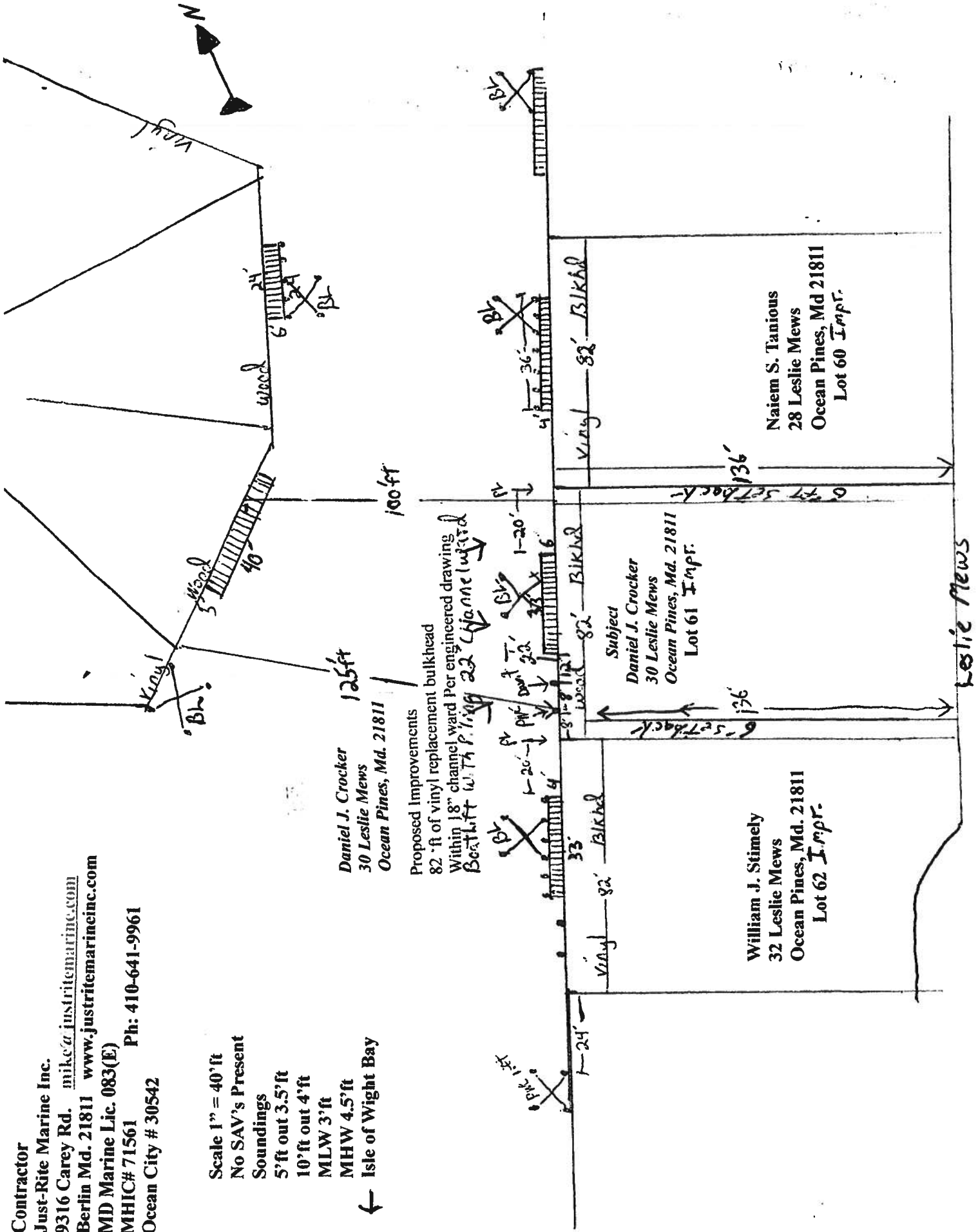

Daniel J. Crocker  
 30 Leslie Mews  
 Ocean Pines, Md. 21811  
 125ft  
 100ft

Proposed Improvements  
 82' ft of vinyl replacement bulkhead  
 Within 18" channel ward Per engineered drawing  
 Beachfront with Piling 22' (Name listed)

Subject  
 Daniel J. Crocker  
 30 Leslie Mews  
 Ocean Pines, Md. 21811  
 Lot 61 Impr.

William J. Stimely  
 32 Leslie Mews  
 Ocean Pines, Md. 21811  
 Lot 62 Impr.

Naiem S. Tanious  
 28 Leslie Mews  
 Ocean Pines, Md 21811  
 Lot 60 Impr.

Leslie Mews

**Contractor**  
**Just-Rite Marine Inc.**  
 9316 Carey Rd. [info@justritemarine.com](mailto:info@justritemarine.com)  
 Berlin Md. 21811 [www.justritemarine.com](http://www.justritemarine.com)  
 MD Marine Lic. 083(E)  
 MHIC# 71561 Ph: 410-641-9961  
 Ocean City # 30542

Scale 1" = 20' ft  
 No SAV's Present  
 Soundings  
 5'ft out 3.5'ft  
 10'ft out 4'ft  
 MLW 3'ft  
 MHW 4.5'ft  
 ← Isle of Wight Bay

**Project Detail**



**Proposed Improvements**  
 82' ft of vinyl replacement bulkhead  
 5'x 30'ft parallel dock  
 13'ft x 13'ft boatlift  
 22'ft channelward from old wood wall

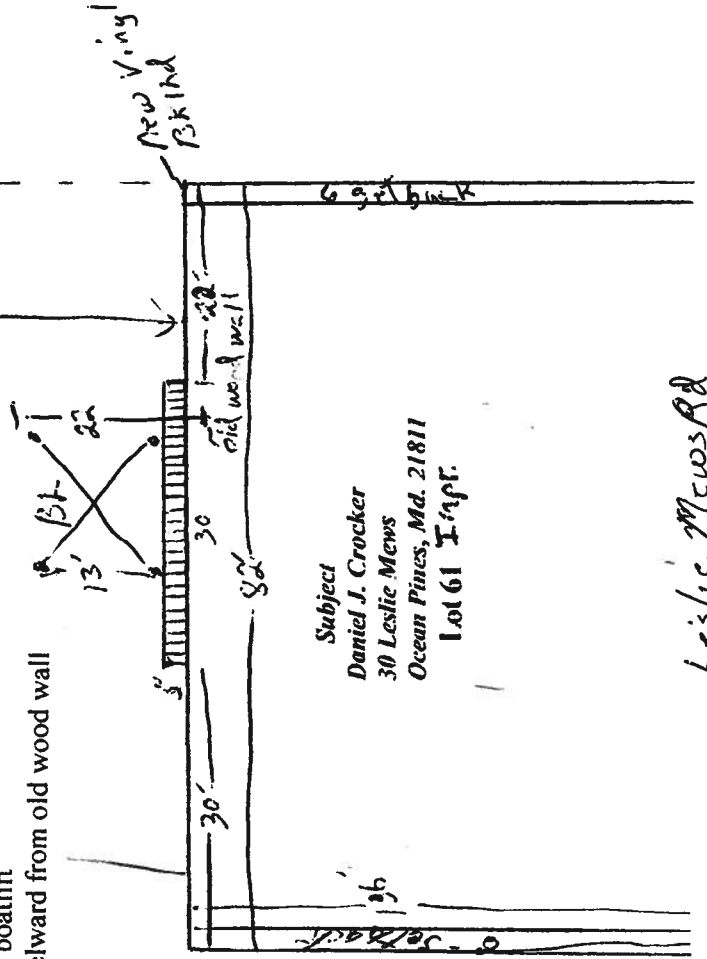

*Leslie Mews Rd*