



DEPARTMENT OF  
ENVIRONMENTAL PROGRAMS

## Worcester County

GOVERNMENT CENTER  
ONE WEST MARKET STREET, ROOM 1306  
SNOW HILL, MARYLAND 21863  
TEL: 410.632.1220 / FAX: 410.632.2012

LAND PRESERVATION PROGRAM  
STORMWATER MANAGEMENT  
SEDIMENT AND EROSION CONTROL  
SHORELINE CONSTRUCTION  
AGRICULTURAL PRESERVATION  
ADVISORY BOARD

WELL & SEPTIC  
WATER & SEWER PLANNING  
PLUMBING & GAS  
CRITICAL AREAS/FORESTRY  
COMMUNITY HYGIENE

December 21, 2022

This notification is to advise you that the Department has received and is presently reviewing the following request for a shoreline construction project:

Daniel Moyer- Request No. 2022-0108 – Request to extend an existing 4.5'x20' platform to 4.5'x44' by adding a new 4.5'x24' section and install one boat lift with all associated poles. Max channelward extension of 18'. This project is located at 19 Sandpiper Lane, Ocean Pines, also known as Tax Map 16, Parcel 38, Lot 641. Third Tax District of Worcester County, Maryland.

The Department in considering this application will make specific findings of fact with regard to the environmental impact, navigational impact, recreational potential, commercial benefit to Worcester County, impact of the proposed construction upon the surrounding neighborhood and upon property values therein, and any other pertinent issues. Approval from the Department does not guarantee approval from any other applicable regulatory agencies.

**If you have an interest which may be adversely affected by the issuance of this permit, you are requested to notify this Department in writing within fifteen (15) calendar days which will end on January 5, 2023.**

Sincerely,

Brandy Whitlock  
Environmental Inspector

cc: Interested Parties  
David Bradford, Deputy Director  
File



WORCESTER COUNTY
SHORELINE CONSTRUCTION
APPLICATION

Request No.: 2022-0108
Submission Date: 12-21-22

X Major Construction (\$300.00) Minor Construction (\$150.00)

Written Description of Proposed Improvement (include channelward distance):

Extend and existing 4.5' x 20' platform to 4.5' x 44' by adding a new 4.5' x 24' section, and install one (1) boat lift with all associated poles. Maximum channel ward extension of 18'.

Property Description:

Map: 0016 Parcel: 0038 Lot: 641 Section: 1 Block: Tax District:
Street Address: 19 Sandpiper Lane, Ocean Pines, MD 21811
Subdivision: 0001
 Dwelling on lot: X Dwelling under construction: Vacant: Commercial:

Owner: Daniel Moyer Phone No.
Mailing Address: 2920 Baas Road, Green Lane, PA 18054
E-Mail Address: moyerfest@gmail.com

Contractor: R. G. Murphy Marine Construction Phone No.: 443-497-0271
Mailing Address: 13239 Rollie Road, Bishopville, MD 21813
E-Mail Address: rgmurphy11@comcast.net

Recorded Adjacent Property Owner: Michael Mather
Property Address: 21 Sandpiper Lane, Ocean Pines, MD 21811
Tax Map: 0016 Parcel: 0038 Lot: 640 Section: 1 Block:

Recorded Adjacent Property Owner: Timothy Stocker
Property Address: 17 Sandpiper Lane, Ocean Pines, MD 21811 - 2714 Urbana Dr Silver Spring MD 20908
Tax Map: 0016 Parcel: 0038 Lot: 642 Section: Block:

As the applicant, I attest that the information presented on this application, site plan and any written documentation attached hereto is known to be accurate. I understand that the proposed shoreline improvement will be constructed to meet or exceed minimum design standards adopted by the Department. Any deviation from these standards will require construction plans sealed by an engineer registered in the State of Maryland. I acknowledge that any falsification of information presented may result in revocation of this approval and of the subsequent Shoreline Construction Permit.

Daniel Moyer/RW Freund POA
Owner/Applicant's Signature Date

\*\*\*\*\*

DEPT. USE ONLY:

Notification Distribution Date: 12-21-22 Public Comment Deadline: 1-5-23 (15 calendar days)
Department Approval Date: Expiration:

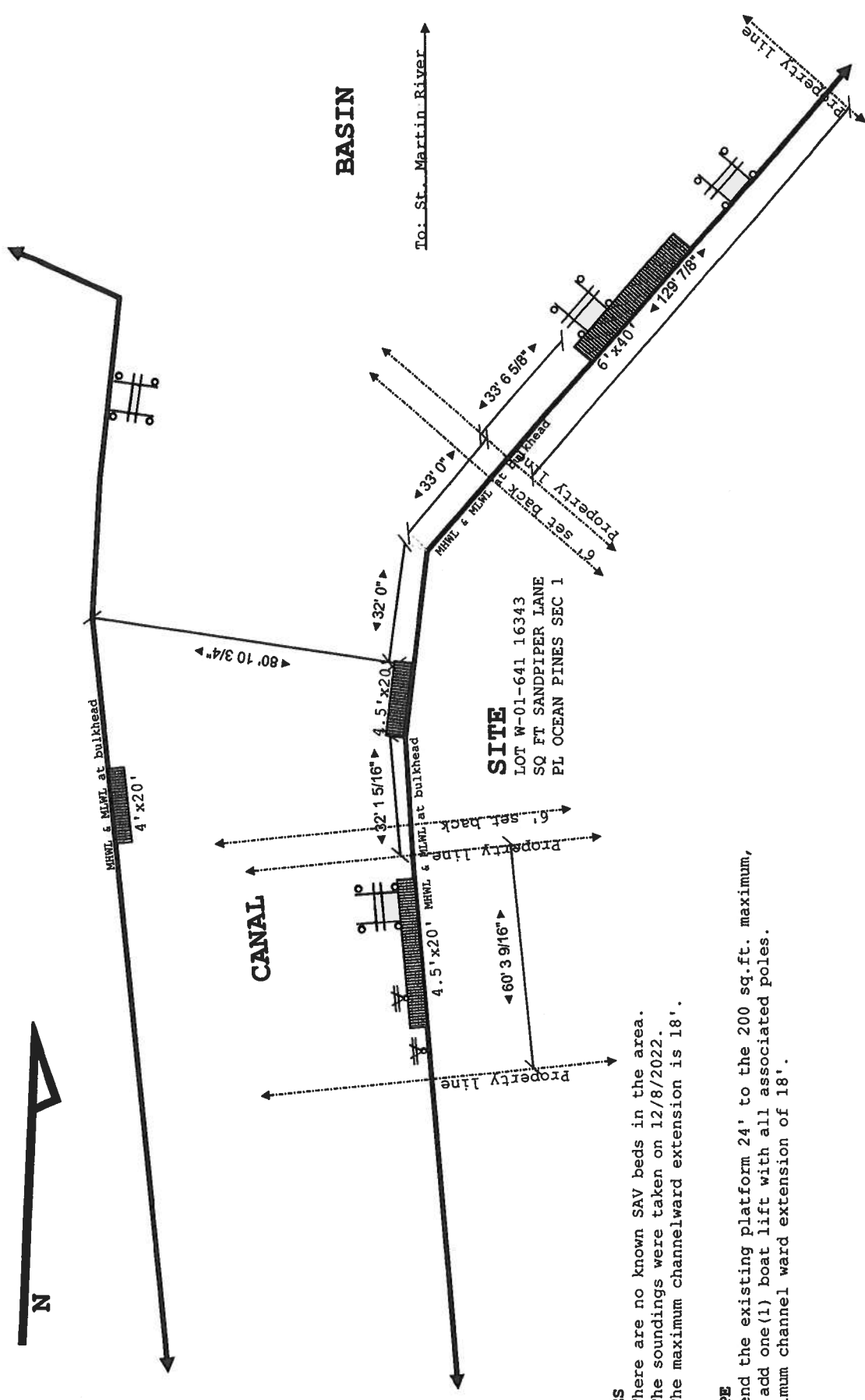

- NOTES**
1. There are no known SAV beds in the area.
  2. The soundings were taken on 12/8/2022.
  3. The maximum channelward extension is 18'.

**SCOPE**  
 Extend the existing platform 24' to the 200 sq.ft. maximum, and add one(1) boat lift with all associated poles. Maximum channel ward extension of 18'.

Site:	19 Sandpiper Lane, OP MD	Notes:	Hidden Oak Farms, LLC
Title:	EXISTING CONDITIONS	Drawn:	CAROUGE
		Rev:	A
Project:	MOYER	Date:	12/08/2022
Drawing:	1	Scale:	1/4" = 10' 0"

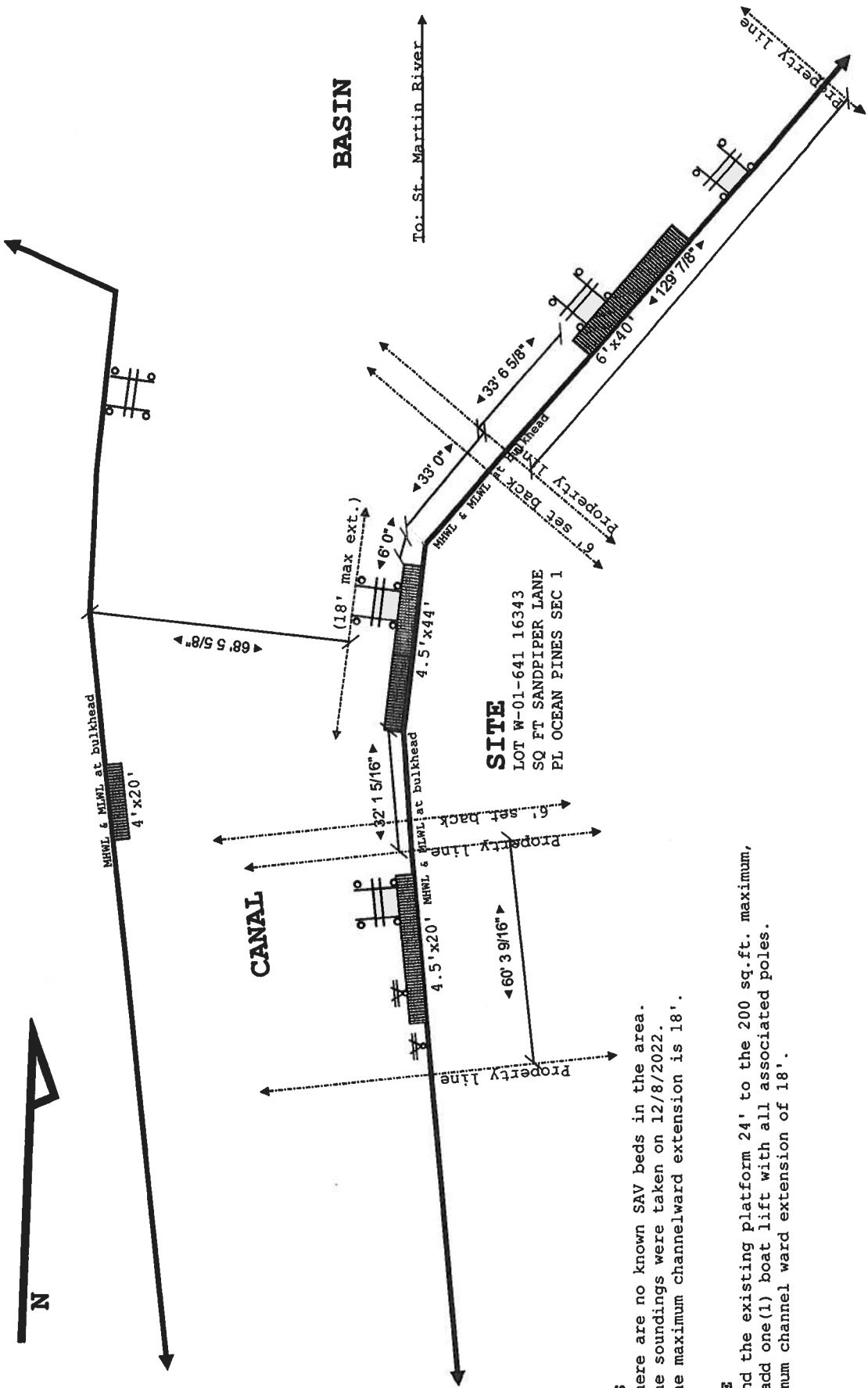

**NOTES**

1. There are no known SAV beds in the area.
2. The soundings were taken on 12/8/2022.
3. The maximum channelward extension is 18'.

**SCOPE**

Extend the existing platform 24' to the 200 sq.ft. maximum, and add one(1) boat lift with all associated poles. Maximum channel ward extension of 18'.

Site: <b>19 Sandpiper Lane, OP MD</b>	Project: <b>MOYER</b>	Drawn: <b>CAROUGE</b>	Notes:	Hidden Oak Farms, LLC
Title: <b>PROPOSED CONDITIONS</b>	Date: <b>12/08/2022</b>	Rev: <b>A</b>		
Drawing: <b>1</b>	Scale: <b>1/4" = 10' 0"</b>			

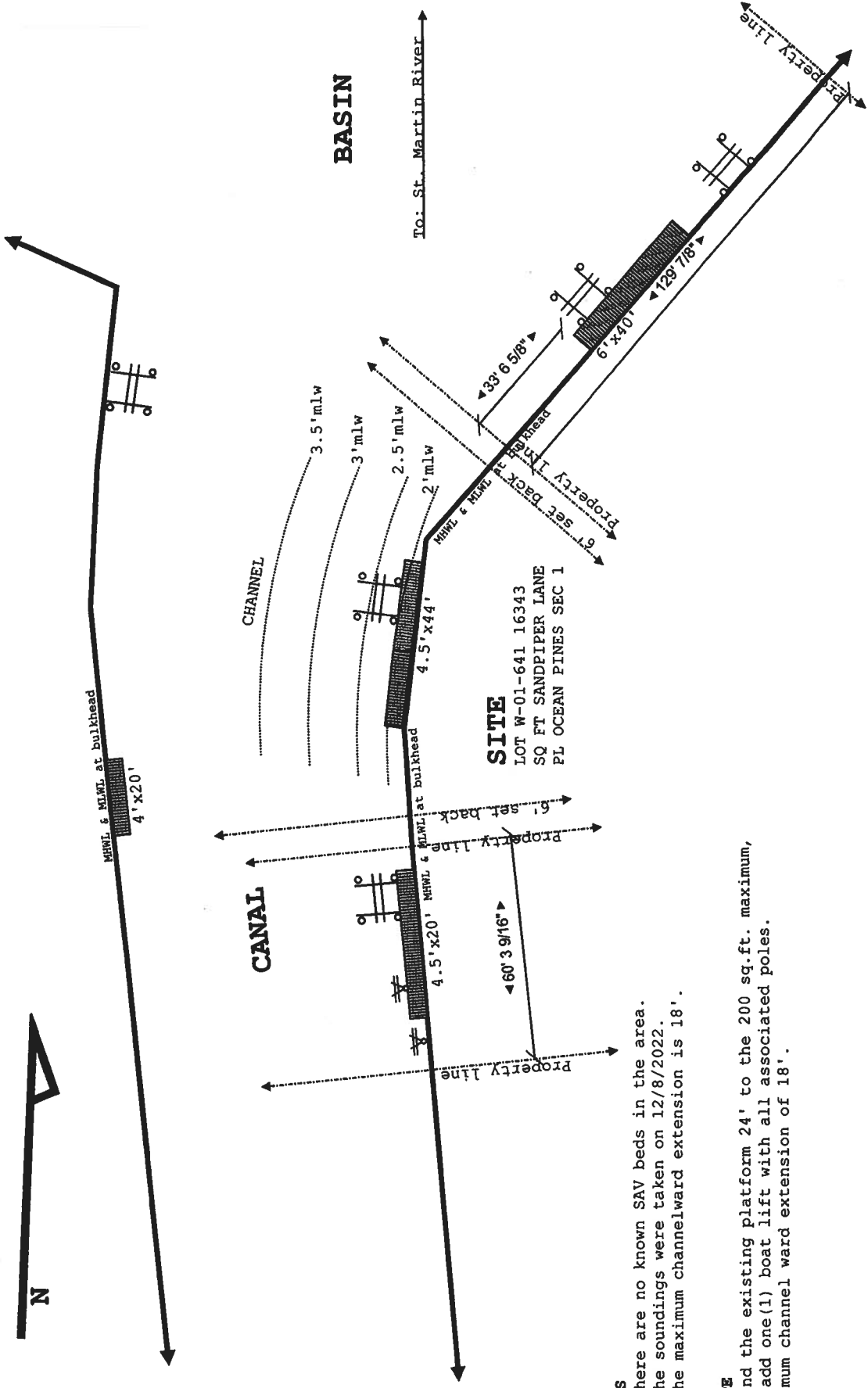

**BASIN**

**CHANNEL**

**CANAL**

**SITE**

LOT W-01-641 16343  
 SQ FT SANDPIPER LANE  
 PL OCEAN PINES SEC 1

To: St. Martin River

**N**

**NOTES**

1. There are no known SAV beds in the area.
2. The soundings were taken on 12/8/2022.
3. The maximum channelward extension is 18'.

**SCOPE**

Extend the existing platform 24' to the 200 sq.ft. maximum, and add one(1) boat lift with all associated poles. Maximum channel ward extension of 18'.

Site: <b>19 Sandpiper Lane, OP MD</b>	Project: <b>MOYER</b>	Notes:	Hidden Oak Farms, LLC
Drawing: <b>1</b>	Drawn: <b>CAROUGE</b>	Date: <b>12/08/2022</b>	Rev: <b>A</b>
Title: <b>DEFTHS</b>	Scale: <b>1/4" = 10'0"</b>		

4.5'

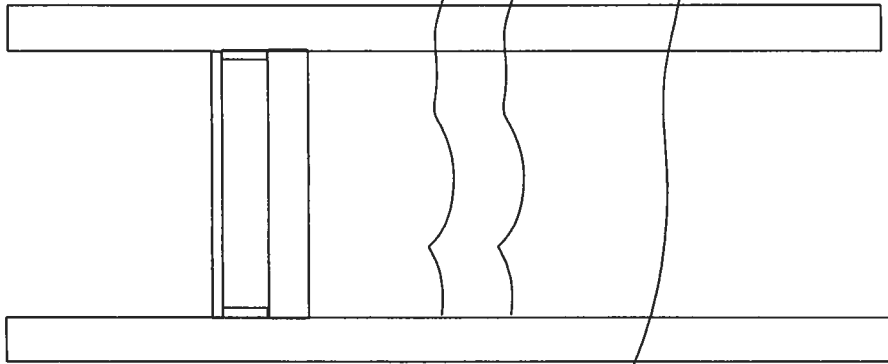

4'

(+1.0') MLWL

(0.0') MLW Line

(-2.5') MLWL Bottom

Work Scope: Pier cross section for 19 Sandpiper Lane  
Ocean Pines, MD

Scale: 1" = 20'

Date:

Owner:

Lot

Blk

T. Map

Parcel

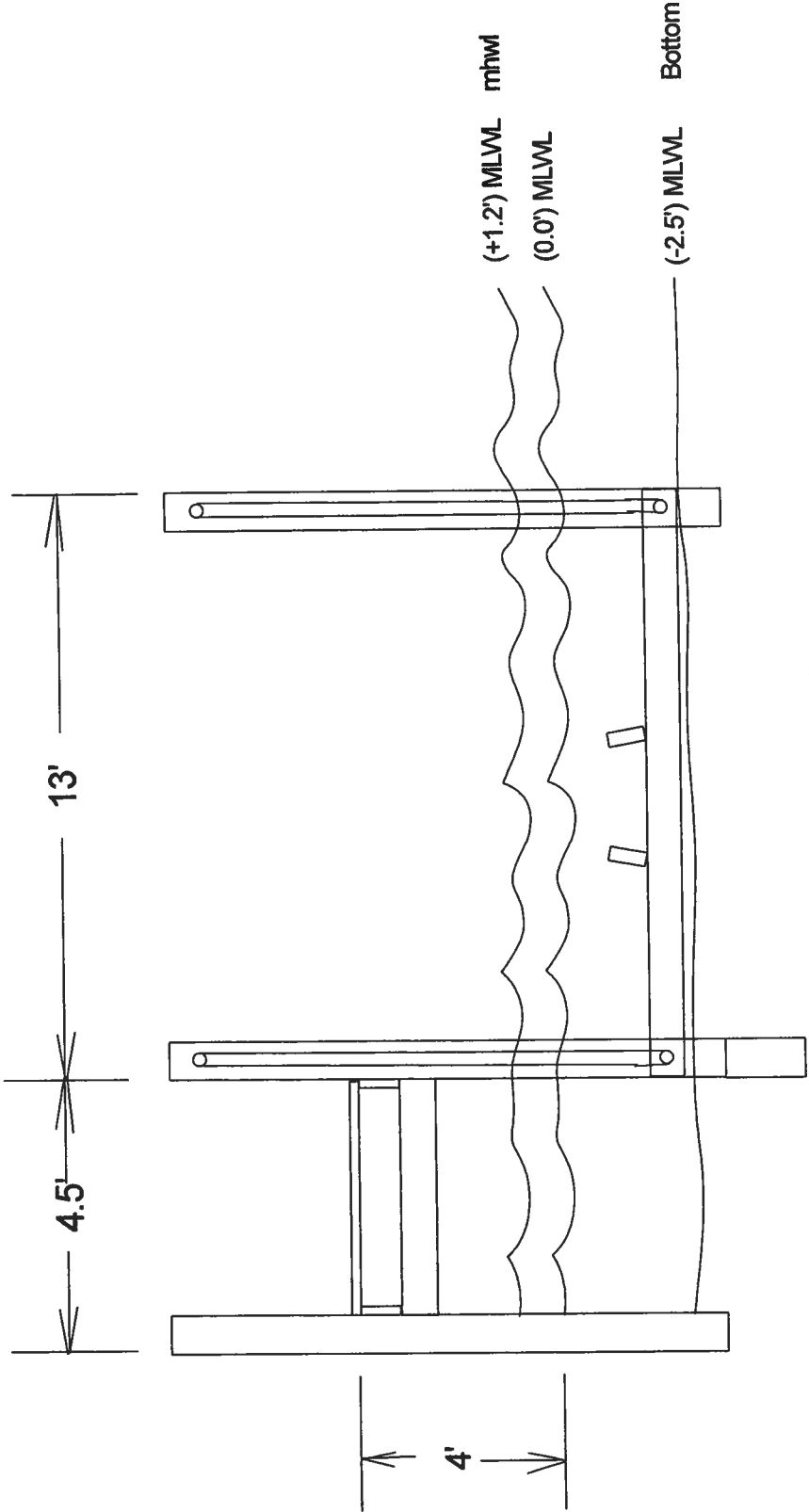

Work Scope: Boat lift cross section for 19 Sandpiper Lane, Ocean Pines			
MD			
Scale: 1" = 20'			
Date:			
Owner:			
Lot	Blk	T. Map	Parcel

