



DEPARTMENT OF
ENVIRONMENTAL PROGRAMS

Worcester County

GOVERNMENT CENTER
ONE WEST MARKET STREET, ROOM 1306
SNOW HILL, MARYLAND 21863
TEL: 410.632.1220 / FAX: 410.632.2012

LAND PRESERVATION PROGRAM
STORMWATER MANAGEMENT
SEDIMENT AND EROSION CONTROL
SHORELINE CONSTRUCTION
AGRICULTURAL PRESERVATION
ADVISORY BOARD

WELL & SEPTIC
WATER & SEWER PLANNING
PLUMBING & GAS
CRITICAL AREAS/FORESTRY
COMMUNITY HYGIENE

December 21, 2022

This notification is to advise you that the Department has received and is presently reviewing the following request for a shoreline construction project:

Robert Smith- Request No. 2022-0107 – Request to install one boat lift with all associated poles to an existing platform. Max channelward extension of 19'. This project is located at 19 Dove Lane, Ocean Pines, also known as Tax Map 16, Parcel 42, Lot 159. Third Tax District of Worcester County, Maryland.

The Department in considering this application will make specific findings of fact with regard to the environmental impact, navigational impact, recreational potential, commercial benefit to Worcester County, impact of the proposed construction upon the surrounding neighborhood and upon property values therein, and any other pertinent issues. Approval from the Department does not guarantee approval from any other applicable regulatory agencies.

If you have an interest which may be adversely affected by the issuance of this permit, you are requested to notify this Department in writing within fifteen (15) calendar days which will end on January 5, 2023.

Sincerely,

Brandy Whitlock
Environmental Inspector

cc: Interested Parties
David Bradford, Deputy Director
File



WORCESTER COUNTY
SHORELINE CONSTRUCTION
APPLICATION

Request No.: 2022-0107
Submission Date: 12-21-22

Major Construction (\$300.00)
Minor Construction (\$150.00)

Written Description of Proposed Improvement (include channelward distance):

Install one (1) boat lift with all associated poles to an existing platform.
Maximum channel ward extension of 19'

Property Description:

Map: 0016 Parcel: 0042 Lot: 159 Section: 5 Block: Tax District:
Street Address: 19 Dove Lane, Ocean Pines, MD 21811
Subdivision: 0005
 Dwelling on lot: Vacant: Commercial:

Owner: Robert Smith Phone No. 301-775-8545
Mailing Address: 19 Dove Lane, Ocean Pines, MD 21811
E-Mail Address: kev.smithy35@gmail.com

Contractor: Newport Bay Marine Construction Phone No.: 724-372-3201
Mailing Address: South Main St., Berlin, MD 21811
E-Mail Address: info@newportconstruction.com

Recorded Adjacent Property Owner: Gregory Mitsch

Property Address: 21 Dove Lane, Ocean Pines, MD 21811
Tax Map: 0016 Parcel: 0042 Lot: 160 Section: 5 Block:

Recorded Adjacent Property Owner: Jeffrey Pitt

Property Address: 17 Dove Lane, Ocean Pines, MD 21811 - 5239 Glen Meadow Rd Centreville VA 20120
Tax Map: 0016 Parcel: 0042 Lot: 158 Section: 5 Block:

As the applicant, I attest that the information presented on this application, site plan and any written documentation attached hereto is known to be accurate. I understand that the proposed shoreline improvement will be constructed to meet or exceed minimum design standards adopted by the Department. Any deviation from these standards will require construction plans sealed by an engineer registered in the State of Maryland. I acknowledge that any falsification of information presented may result in revocation of this approval and of the subsequent Shoreline Construction Permit.

Robert Smith/RW Freund POA
Owner/Applicant's Signature Date

DEPT. USE ONLY:

Notification Distribution Date: 12-21-22 Public Comment Deadline: 1-5-23 (15 calendar days)
Department Approval Date: Expiration:



CANAL

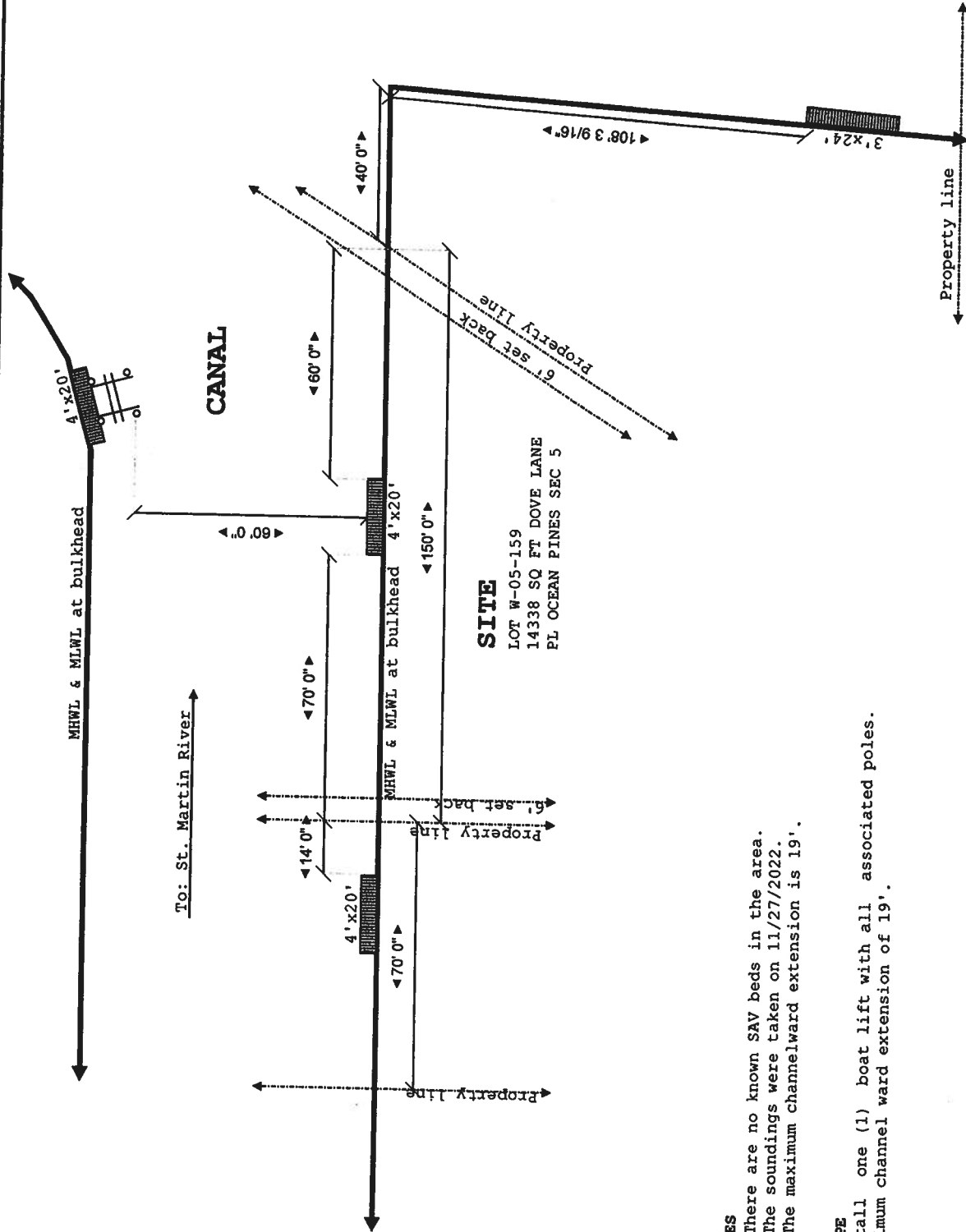

SITE
 LOT W-05-159
 14338 SQ FT DOVE LANE
 PL OCEAN PINES SEC 5

NOTES
 1. There are no known SAV beds in the area.
 2. The soundings were taken on 11/27/2022.
 3. The maximum channelward extension is 19'.

SCOPE
 Install one (1) boat lift with all associated poles.
 Maximum channel ward extension of 19'.

Site:	19 Dove Lane, OP MD	Drawing:	1	Project:	SMITH	Drawn:	Carouge	Notes:	HIDDEN OAK FARMS, LLC
Title:	EXISTING CONDITIONS	Scale:	1/4"=10'0"	Date:	11/28/2022	Rev:	A		



CANAL

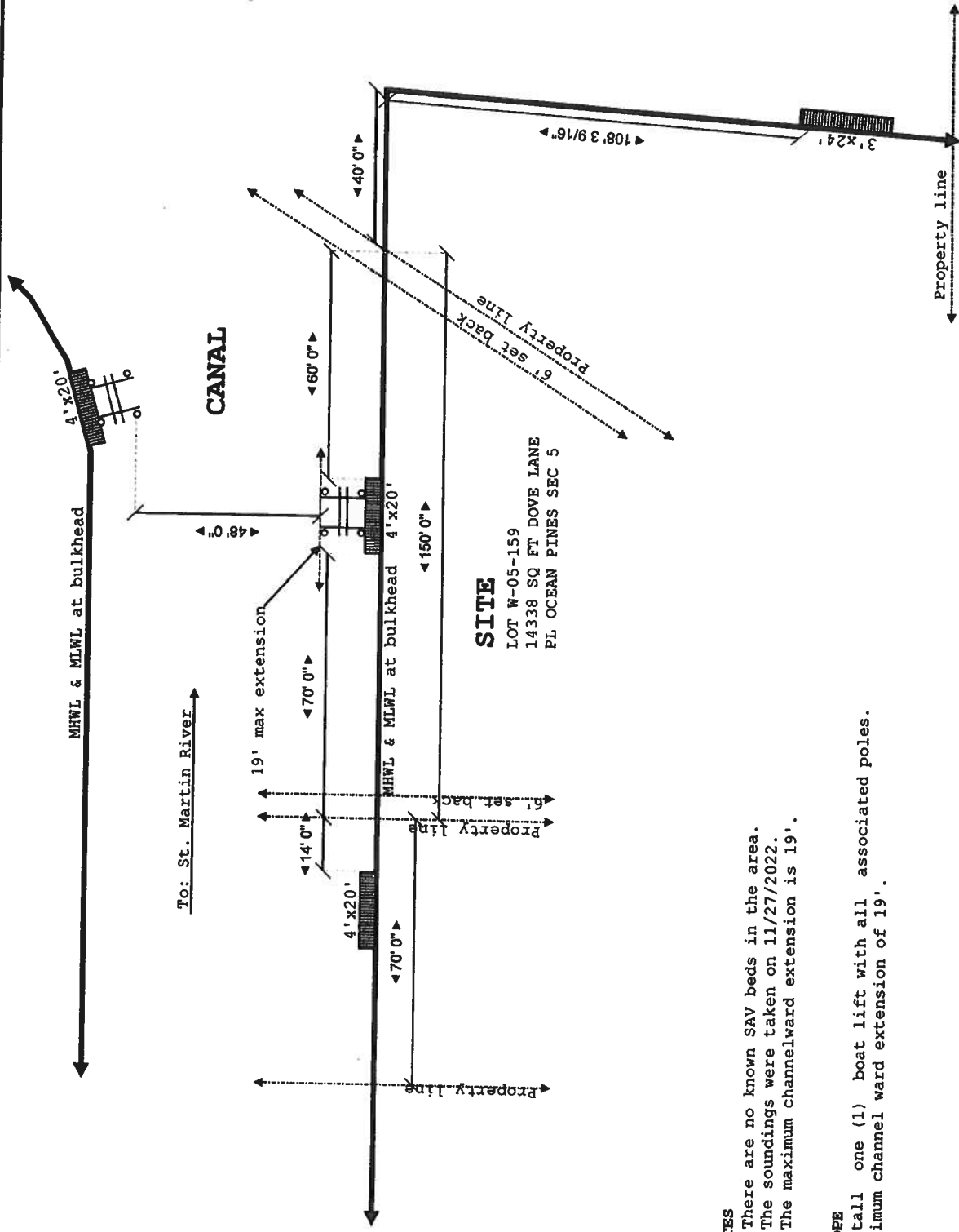

SITE
 LOT W-05-159
 14338 SQ FT DOVE LANE
 PL OCEAN PINES SEC 5

NOTES
 1. There are no known SAV beds in the area.
 2. The soundings were taken on 11/27/2022.
 3. The maximum channelward extension is 19'.

SCOPE
 Install one (1) boat lift with all associated poles.
 Maximum channel ward extension of 19'.

Site:	19 Dove Lane, OP MD	Notes:	HIDDEN OAK FARMS, LLC
Title:	PROPOSED CONDITIONS	Project:	SMITH
		Drawn:	Carouge
		Date:	11/28/2022
		Scale:	1/4" = 10' 0"
		Rev:	A



CANAL

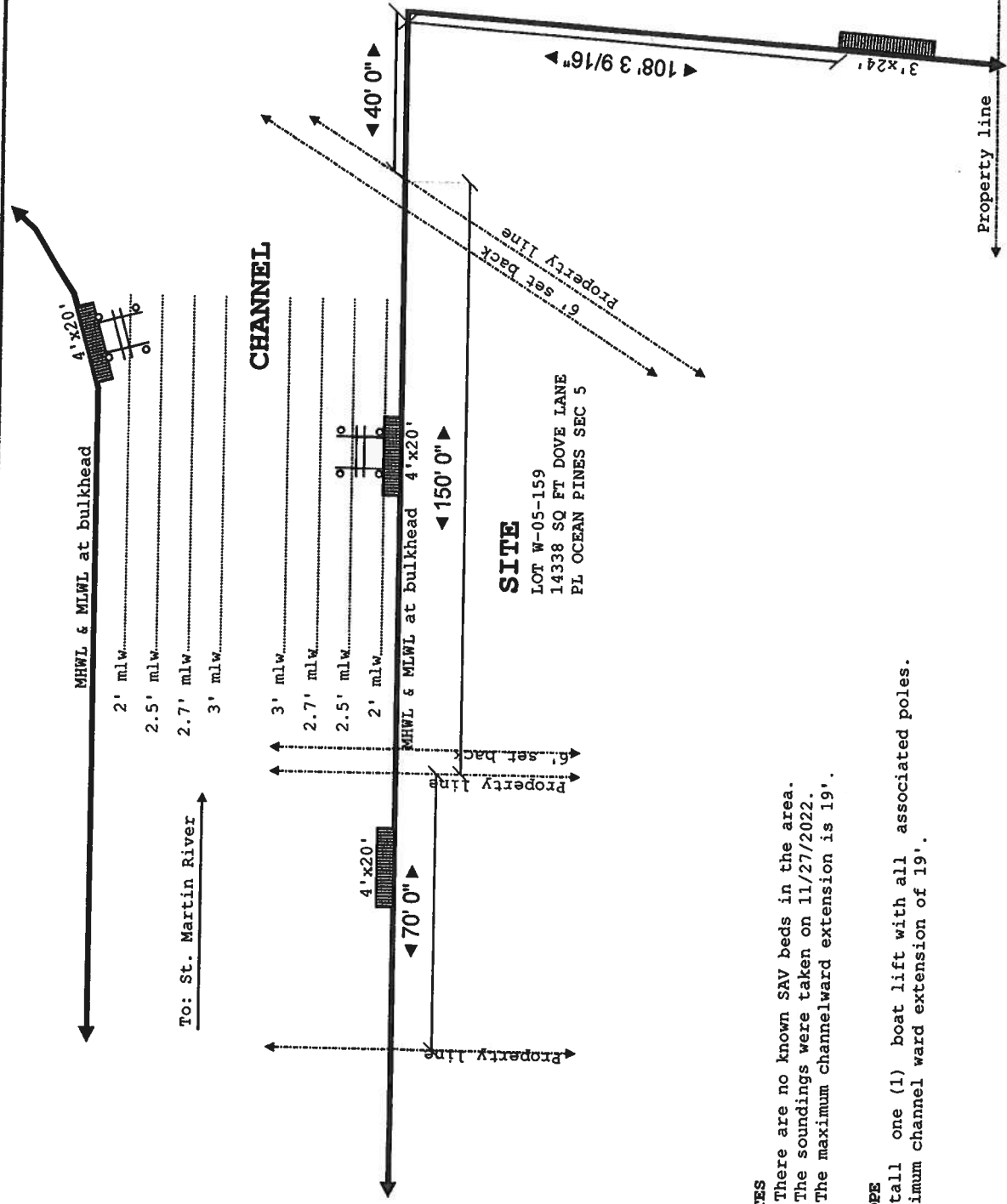

MHWL & MLWL at bulkhead 4'x20'

2' mlw.....

2.5' mlw.....

2.7' mlw.....

3' mlw.....

CHANNEL

3' mlw.....

2.7' mlw.....

2.5' mlw.....

2' mlw.....

SITE

LOT W-05-159

14338 SQ FT DOVE LANE

PL OCEAN PINES SEC 5

MHWL & MLWL at bulkhead 4'x20'

- NOTES**
1. There are no known SAV beds in the area.
 2. The soundings were taken on 11/27/2022.
 3. The maximum channelward extension is 19'.

SCOPE

Install one (1) boat lift with all associated poles.

Maximum channel ward extension of 19'.

Site:	19 Dove Lane, OP MD	Drawing:	1	Project:	SMITH	Drawn:	Carouge	Notes:	HIDDEN OAK FARMS, LLC
Title:	DEPTHS	Scale:	1/4" = 10' 0"	Date:	11/28/2022	Rev:	A		

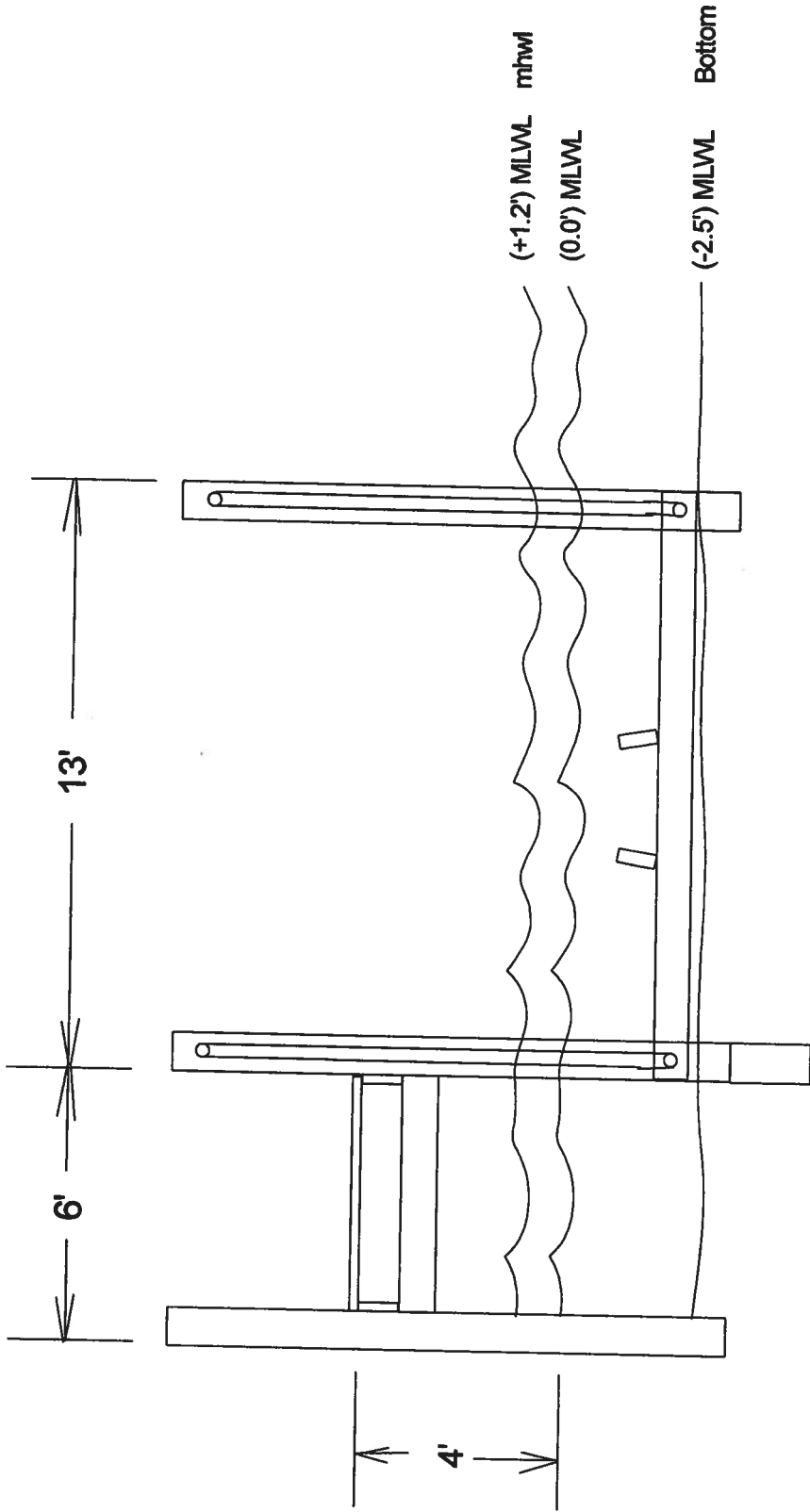

Work Scope: Boat lift and pier cross section for 19 Dove Lane
 Ocean Pines, MD 21811

Scale: 1" = 20'

Date:

Owner:

Lot

Blk

T. Map

Parcel

