



DEPARTMENT OF
ENVIRONMENTAL PROGRAMS

Worcester County

GOVERNMENT CENTER
ONE WEST MARKET STREET, ROOM 1306
SNOW HILL, MARYLAND 21863
TEL: 410.632.1220 / FAX: 410.632.2012

LAND PRESERVATION PROGRAM
STORMWATER MANAGEMENT
SEDIMENT AND EROSION CONTROL
SHORELINE CONSTRUCTION
AGRICULTURAL PRESERVATION
ADVISORY BOARD

WELL & SEPTIC
WATER & SEWER PLANNING
PLUMBING & GAS
CRITICAL AREAS/FORESTRY
COMMUNITY HYGIENE

November 29, 2022

This notification is to advise you that the Department has received and is presently reviewing the following request for a shoreline construction project:

Waterside Dr LLC c/o Charles Kuhn- Request No. 2022-0102 – Request to install three boat lifts all with associated poles. Max channelward extension of 220'. This project is located at 5717 Waterside Dr, Ocean City, also known as Tax Map 50, Parcel 51, Lot 13. Tenth Tax District of Worcester County, Maryland.

The Department in considering this application will make specific findings of fact with regard to the environmental impact, navigational impact, recreational potential, commercial benefit to Worcester County, impact of the proposed construction upon the surrounding neighborhood and upon property values therein, and any other pertinent issues. Approval from the Department does not guarantee approval from any other applicable regulatory agencies.

If you have an interest which may be adversely affected by the issuance of this permit, you are requested to notify this Department in writing within fifteen (15) calendar days which will end on December 14, 2022.

Sincerely,

Brandy Whitlock
Environmental Inspector

cc: Interested Parties
David Bradford, Deputy Director
File

Updated



WORCESTER COUNTY SHORELINE CONSTRUCTION APPLICATION

Request No.: 2022-0102 Submission Date: 11-29-22

Major Construction (\$300.00) Minor Construction (\$150.00)

Written Description of Proposed Improvement (include channelward distance):

Install three (3) boat lift with all associated poles. Maximum channel ward extension of 220'.

Property Description:

Map: 0050 Parcel: 0051 Lot: 13 Section: Block: Tax District:

Street Address: 5717 Waterside Drive, Berlin, MD 21811

Subdivision: 1113

Dwelling on lot: Dwelling under construction: Vacant: Commercial:

Owner: Waterside Dr, LLC/Charles Kuhn Phone No. 703-909-9069 Mailing Address: 4412 Mercure Circle, Sterling, VA 20166 E-Mail Address: chuck.kuhn@jkmoving.com

Contractor: Bayshore Marine Construction Phone No.: 410-726-6658 Mailing Address: 9808 Stephen Decatur Hwy, Unit 6, Ocean City, MD 21842 E-Mail Address: bayshoremarine@comcast.net

Recorded Adjacent Property Owner: Waterside Dr, LLC/Charles Kuhn - Same as owner Property Address: Waterside Drive, Berlin, MD 21811 Tax Map: 0050 Parcel: 0051 Lot: 12 Section: Block:

Recorded Adjacent Property Owner: Waterside Dr, LLC/Charles Kuhn - Same as owner Property Address: Waterside Drive, Berlin, MD 21811 Tax Map: 0050 Parcel: 0051 Lot: 14 Section: Block:

As the applicant, I attest that the information presented on this application, site plan and any written documentation attached hereto is known to be accurate. I understand that the proposed shoreline improvement will be constructed to meet or exceed minimum design standards adopted by the Department. Any deviation from these standards will require construction plans sealed by an engineer registered in the State of Maryland. I acknowledge that any falsification of information presented may result in revocation of this approval and of the subsequent Shoreline Construction Permit.

Chuck Kuhn/RW Freund POA Owner/Applicant's Signature Date

DEPT. USE ONLY:

Notification Distribution Date: 11/29/22 Public Comment Deadline: 12/14/22 (15 calendar days) Department Approval Date: Expiration:

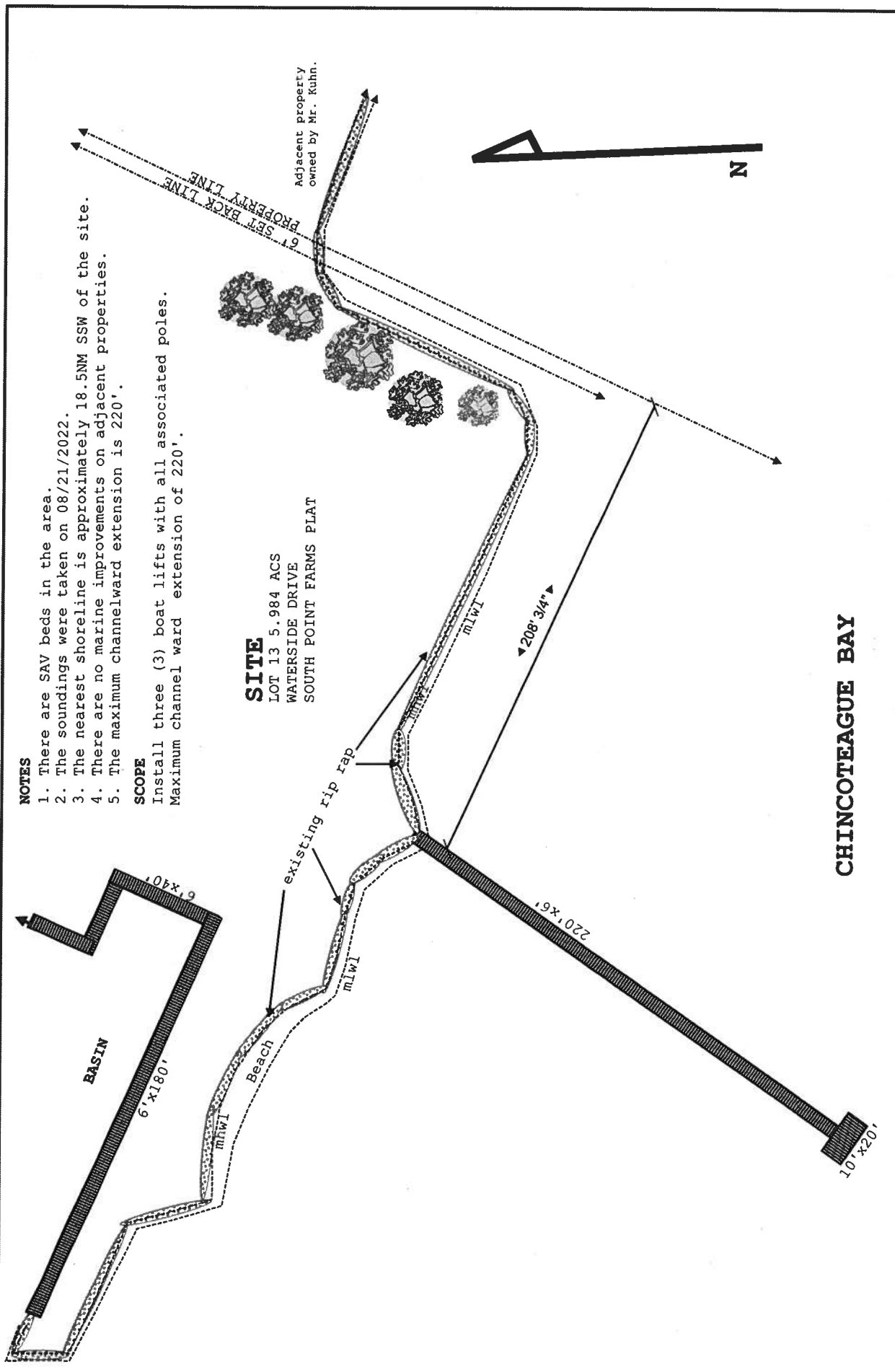

NOTES

1. There are SAV beds in the area.
2. The soundings were taken on 08/21/2022.
3. The nearest shoreline is approximately 18.5NM SSW of the site.
4. There are no marine improvements on adjacent properties.
5. The maximum channelward extension is 220'.

SCOPE

Install three (3) boat lifts with all associated poles.
 Maximum channel ward extension of 220'.

SITE
 LOT 13 5.984 ACS
 WATERSIDE DRIVE
 SOUTH POINT FARMS PLAT

CHINCOTEAGUE BAY

Site:	5717 Waterside Drive, Berlin	Project:	KUHN	Notes:	Hidden Oak Farms, LLC
Drawing:	801506	Date:	08/24/2022	Drawn:	Carouge
Title:	EXISTING CONDITIONS	Scale:	1/4" = 15' 0"	Rev:	A

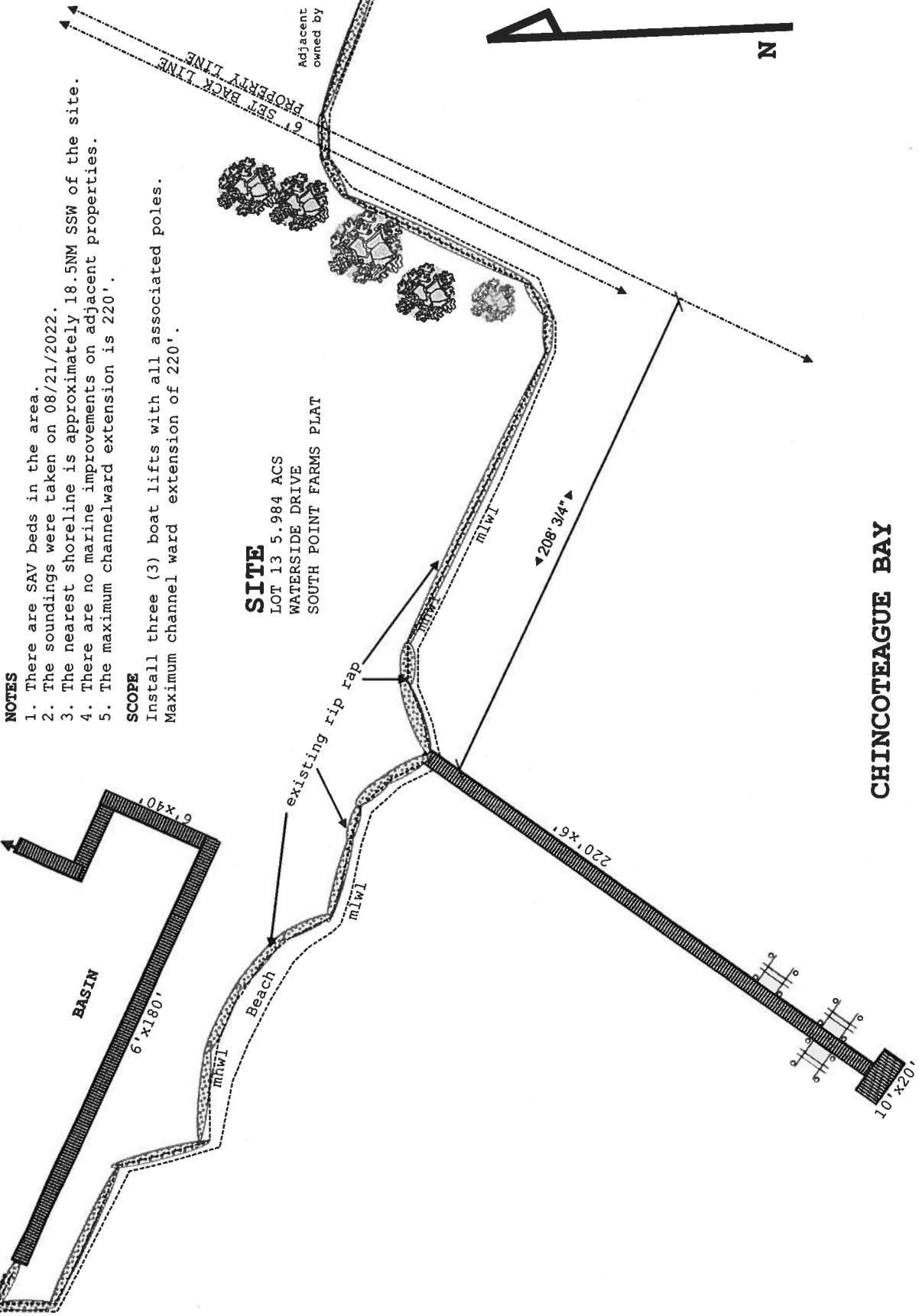

NOTES

1. There are SAV beds in the area.
2. The soundings were taken on 08/21/2022.
3. The nearest shoreline is approximately 18.5NM SSW of the site.
4. There are no marine improvements on adjacent properties.
5. The maximum channelward extension is 220'.

SCOPE

Install three (3) boat lifts with all associated poles.
 Maximum channel ward extension of 220'.

SITE

LOT 13 5.984 ACS
 WATERSIDE DRIVE
 SOUTH POINT FARMS PLAT

Adjacent property
 owned by Mr. Kuhn.

CHINCOTEAGUE BAY

Site:	5717 Waterside Drive, Berlin	Project:	KUHN	Notes:	Hidden Oak Farms, LLC
Drawing:	801506	Date:	08/24/2022	Drawn:	Carouge
Title:	PROPOSED CONDITIONS	Scale:	1/4" = 15'0"	Rev:	A

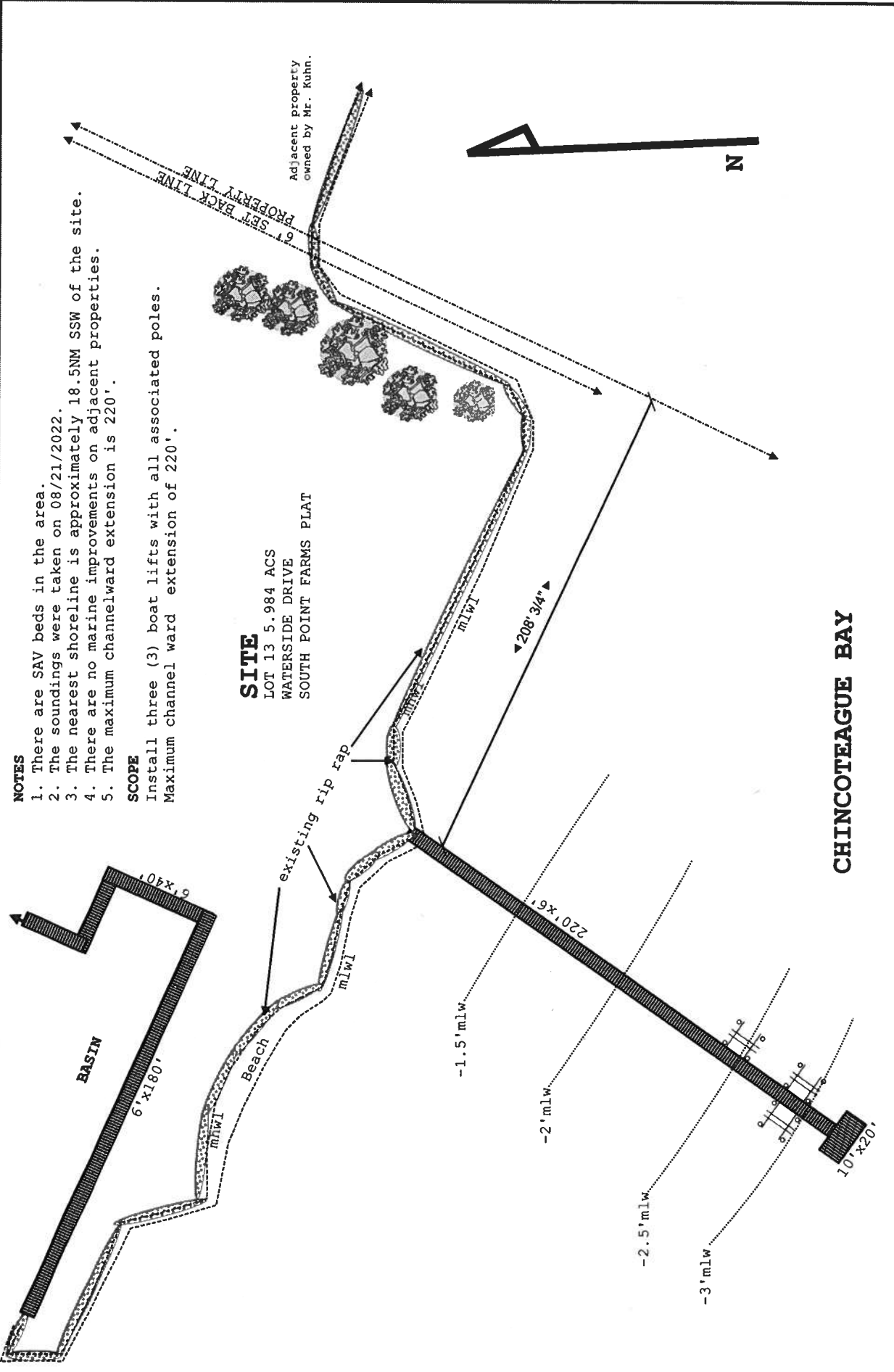

NOTES

1. There are SAV beds in the area.
2. The soundings were taken on 08/21/2022.
3. The nearest shoreline is approximately 18.5NM SSW of the site.
4. There are no marine improvements on adjacent properties.
5. The maximum channelward extension is 220'.

SCOPE

Install three (3) boat lifts with all associated poles.
 Maximum channel ward extension of 220'.

SITE

LOT 13 5.984 ACS
 WATERSIDE DRIVE
 SOUTH POINT FARMS PLAT

CHINCOTEAGUE BAY

Site:	5717 Waterside Drive, Berlin	Project:	KUHN	Notes:	Hidden Oak Farms, LLC
Drawing:	801506	Date:	08/24/2022	Drawn:	Carouge
Scale:	1/4" = 15' 0"	Rev:	A		
Title:	DEPTHS				

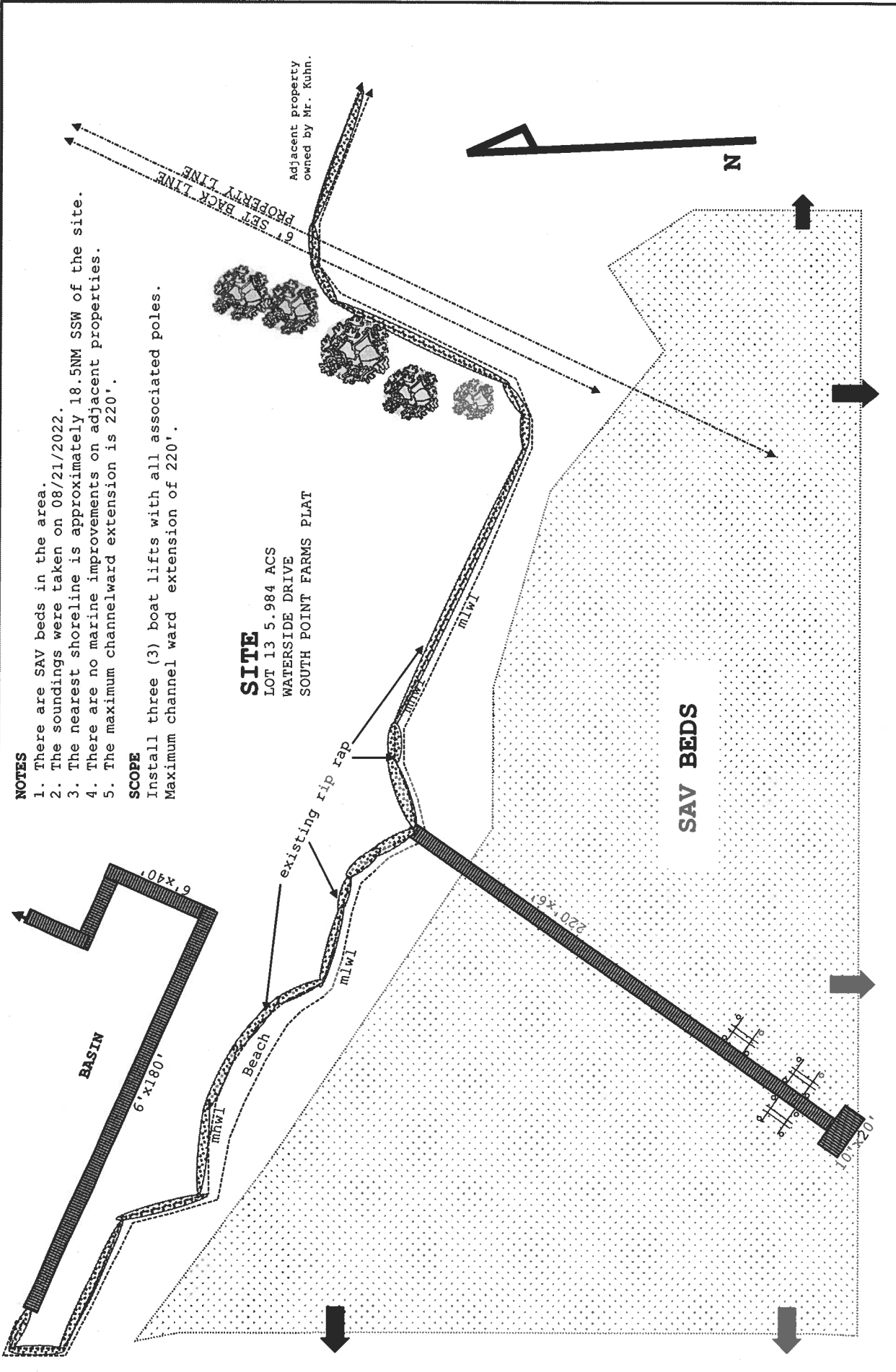

NOTES

1. There are SAV beds in the area.
2. The soundings were taken on 08/21/2022.
3. The nearest shoreline is approximately 18.5NM SSW of the site.
4. There are no marine improvements on adjacent properties.
5. The maximum channelward extension is 220'.

SCOPE

Install three (3) boat lifts with all associated poles.
 Maximum channel ward extension of 220'.

SITE

LOT 13 5.984 ACS
 WATERSIDE DRIVE
 SOUTH POINT FARMS PLAT

Site:	5717 Waterside Drive, Berlin	Drawing:	801506	Project:	KUHN	Drawn:	Carouge	Notes:	Hidden Oak Farms, LLC
Title:	SAV Beds	Scale:	1/4" = 15' 0"	Date:	08/24/2022	Rev:	A		

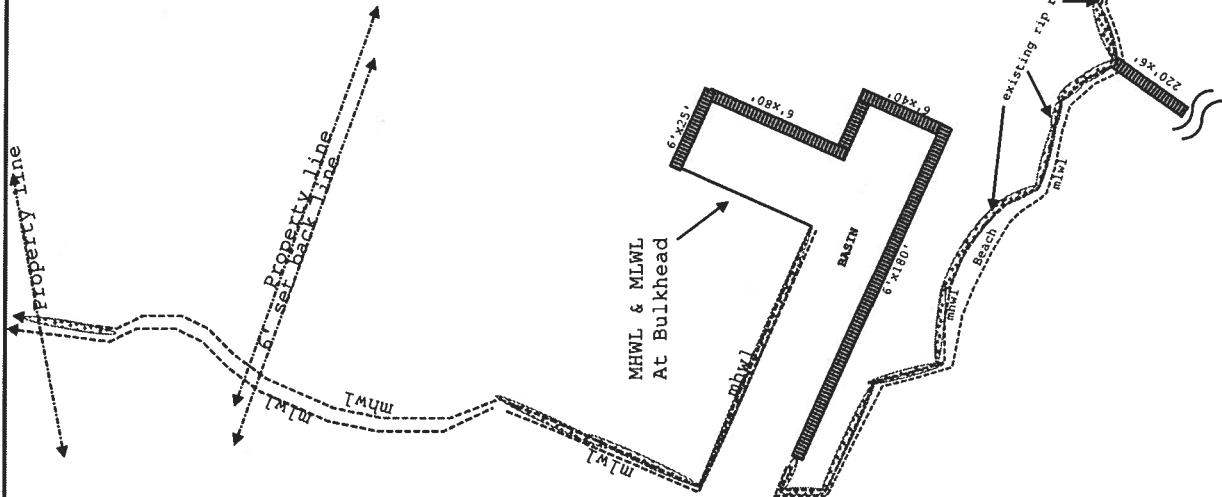

NOTES

1. There are SAV beds in the area.
2. The soundings were taken on 08/21/2022.
3. The nearest shoreline is approximately 18.5NM SSW of the site.
4. There are no marine improvements on adjacent properties.
5. The maximum channelward extension is 220'.

SCOPE

Install three (3) boat lifts with all associated poles.
 Maximum channel ward extension of 220'.

SITE
 LOT 13 5.984 ACS
 WATERSIDE DRIVE
 SOUTH POINT FARMS PLAT

Site: 5717 Waterside Drive, Berlin	Drawing: 801506	Project: KUHN	Drawn: Carouge	Notes:	Hidden Oak Farms, LLC
Title: PANNED	Scale: 1/4" = 25' 0"	Date: 08/24/2022	Rev: A		

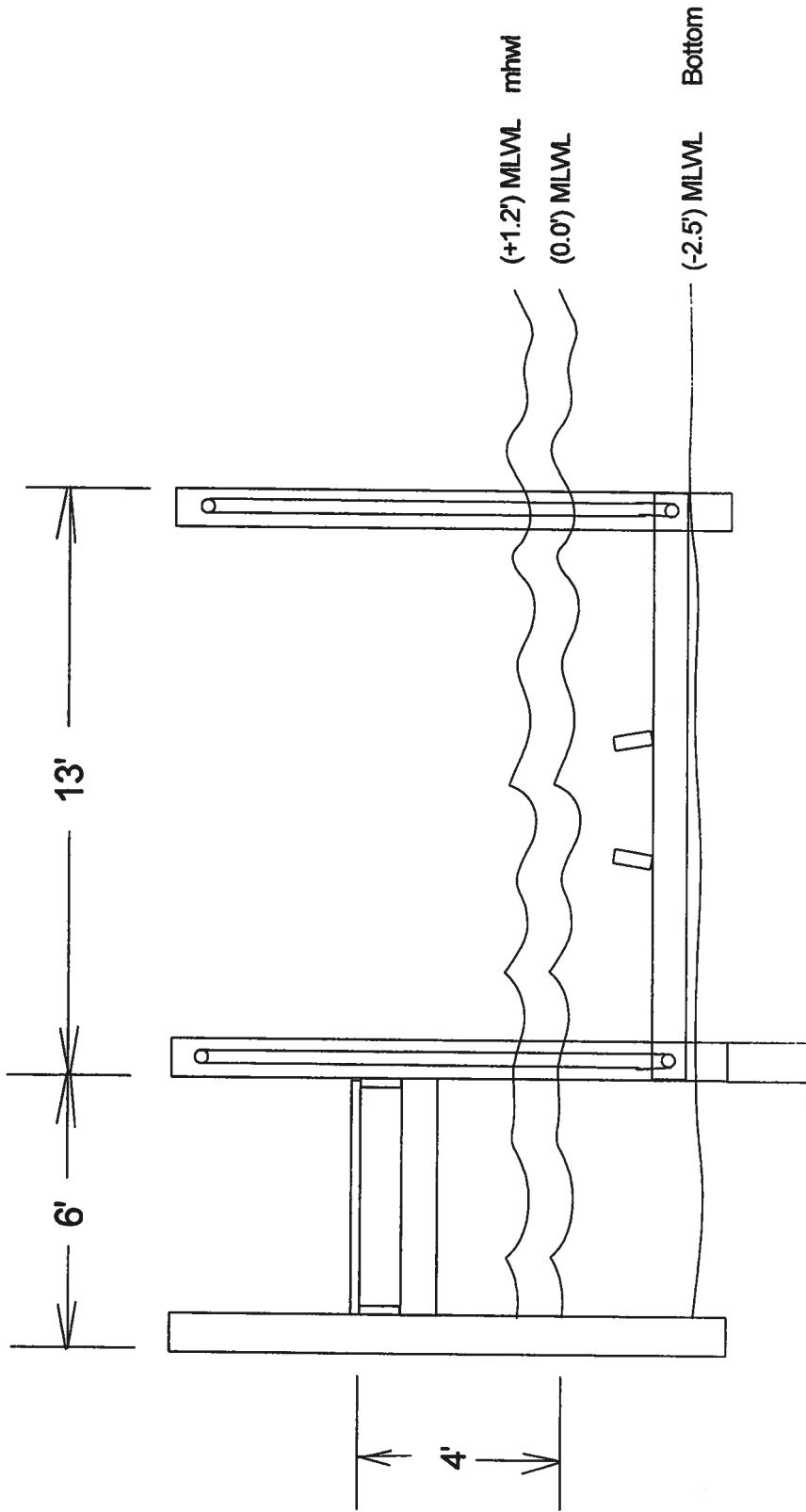

Work Scope: Boat lift and pier cross section for 5717 Waterside Drive
 Berlin, MD 21811

Scale: 1" = 20'

Date:

Owner:

Lct

Eik

T. Map

Percol

