



DEPARTMENT OF
ENVIRONMENTAL PROGRAMS

Worcester County

GOVERNMENT CENTER
ONE WEST MARKET STREET, ROOM 1306
SNOW HILL, MARYLAND 21863
TEL: 410.632.1220 / FAX: 410.632.2012

LAND PRESERVATION PROGRAM
STORMWATER MANAGEMENT
SEDIMENT AND EROSION CONTROL
SHORELINE CONSTRUCTION
AGRICULTURAL PRESERVATION
ADVISORY BOARD

WELL & SEPTIC
WATER & SEWER PLANNING
PLUMBING & GAS
CRITICAL AREAS/FORESTRY
COMMUNITY HYGIENE

March 2, 2022

This notification is to advise you that the Department has received and is presently reviewing the following request for a shoreline construction project:

Peter Rembalsky & Emily Fischel - Request No. 2022-024 – Request to install a 5'x4' pier extension to existing 30'x6' pier not to exceed 35' channelward. This project also includes the relocation of existing boat lift. This project is located at 37 Boatswain Dr, Ocean Pines, also known as Tax Map 16, Parcel 15, Sec 19, Lot 37. Third Tax District of Worcester County, Maryland.

The Department in considering this application will make specific findings of fact with regard to the environmental impact, navigational impact, recreational potential, commercial benefit to Worcester County, impact of the proposed construction upon the surrounding neighborhood and upon property values therein, and any other pertinent issues. Approval from the Department does not guarantee approval from any other applicable regulatory agencies.

If you have an interest which may be adversely affected by the issuance of this permit, you are requested to notify this Department in writing within fifteen (15) calendar days which will end on March 17, 2022.

Sincerely,

Brandy Whitlock
Environmental Inspector

cc: Interested Parties
David Bradford, Deputy Director
File



WORCESTER COUNTY
SHORELINE CONSTRUCTION
APPLICATION

Request No.: 2022-024
Submission Date: 3-2-22

Major Construction (\$300.00) _____ Minor Construction (\$150.00)

Written Description of Proposed Improvement (include channelward distance):

Install a 5' x 4' pier extension to existing 30' x 6' pier (45' total)
Move existing boat lift to end of new pier extension.
Maximum channelward distance 35'.

Property Description:

Map: 0016 Parcel: 0015 Lot: 37 Section: 19 Block: _____ Tax District: _____
Street Address: 37 Boatswain Drive, Ocean Pines, MD 21811
Subdivision: Harbor Village
Dwelling on lot: Yes Dwelling under construction: _____ Vacant: _____ Commercial: _____

Owner: Peter Rembalsky & Emily Fischel Phone No. 267-228-5494
Mailing Address: 37 Boatswain Drive, Ocean Pines, MD 21811
E-Mail Address: emily@opendoorbuildingsolutions.com

Contractor: McGinty Marine Construction Phone No.: 410-250-5066
Mailing Address: 12050 Industrial Park Road, Bishopville, MD 21813
E-Mail Address: heather@mcgintymarine.com

Recorded Adjacent Property Owner: Mitchell Seitz
Property Address: 38 Boatswain Drive, Ocean Pines, MD 21811
Tax Map: 0016 Parcel: 0015 Lot: 38 Section: 19 Block: _____

Recorded Adjacent Property Owner: George & Deborah Swayngim - 1 Cella Dr Aston PA 19014
Property Address: 36 Boatswain Drive, Ocean Pines, MD 21811
Tax Map: 0016 Parcel: 0015 Lot: 36 Section: 19 Block: _____

As the applicant, I attest that the information presented on this application, site plan and any written documentation attached hereto is known to be accurate. I understand that the proposed shoreline improvement will be constructed to meet or exceed minimum design standards adopted by the Department. Any deviation from these standards will require construction plans sealed by an engineer registered in the State of Maryland. I acknowledge that any falsification of information presented may result in revocation of this approval and of the subsequent Shoreline Construction Permit.

[Signature] 2/10/22
Owner/Applicant's Signature Date

IDA-AHS

DEPT. USE ONLY:

Notification Distribution Date: 3/2/22 Public Comment Deadline: 3/17/22 (15 calendar days)
Department Approval Date: _____ Expiration: _____

EXISTING PLAN

No Known SAV's

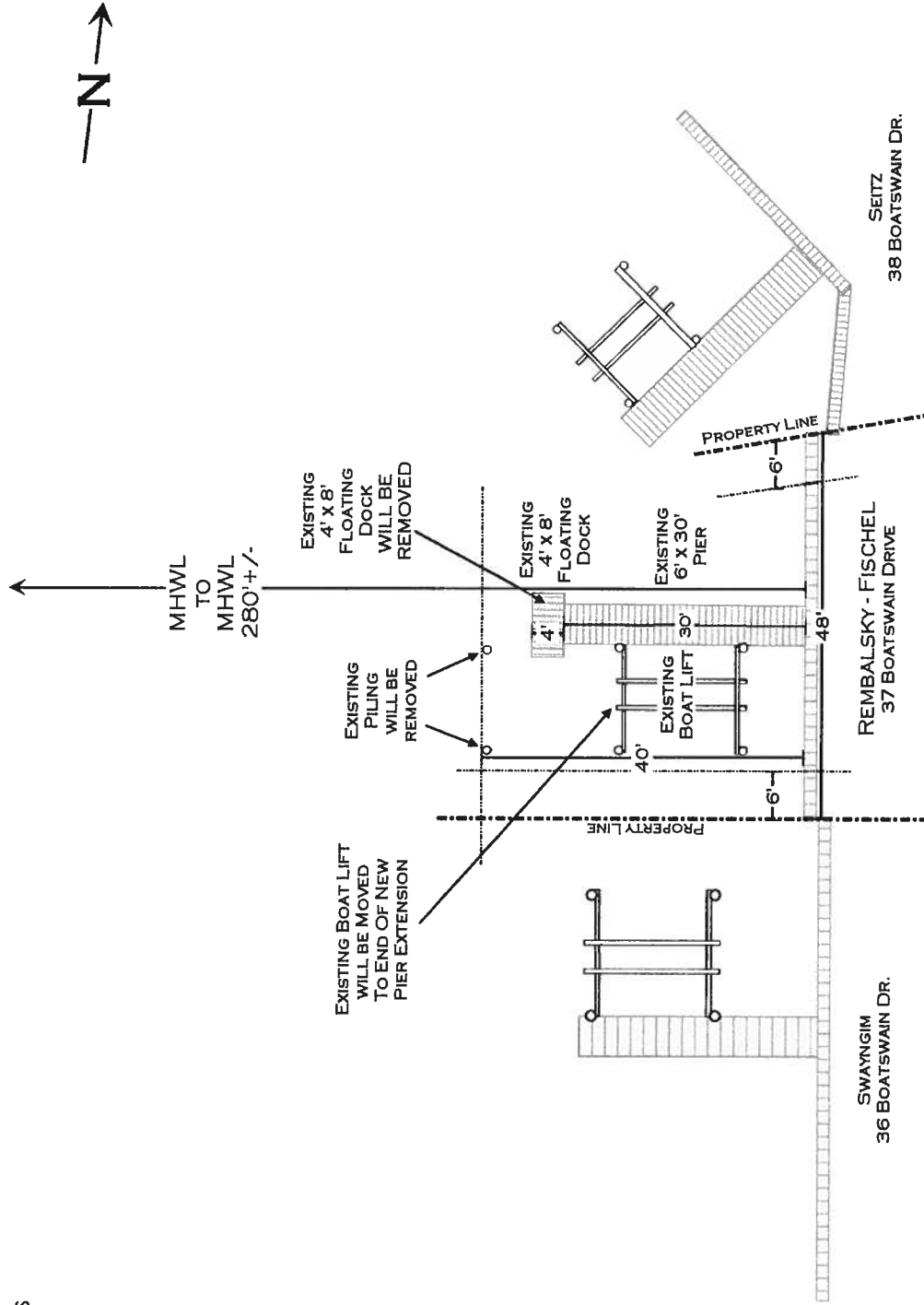

<p>SITE: 37 BOATSWAIN DRIVE OCEAN PINES, MD 21811</p>	<p>DRAWING: EXISTING PLAN</p>	<p>PROJECT: 37 BOATSWAIN</p>	<p>DRAWN: H. SCHLEUPNER</p>	<p>MCGINTY MARINE CONSTRUCTION 12050 INDUSTRIAL PARK ROAD BISHOPVILLE, MD 21813 410-250-5066</p>
<p>TITLE: PETER REMBALSKEY & EMILY FISCHEL</p>	<p>SCALE: 1" = 20'</p>	<p>DATE: 2/4/22</p>	<p>PAGE: 1 OF 4</p>	

PROPOSED

NO KNOWN SAV'S

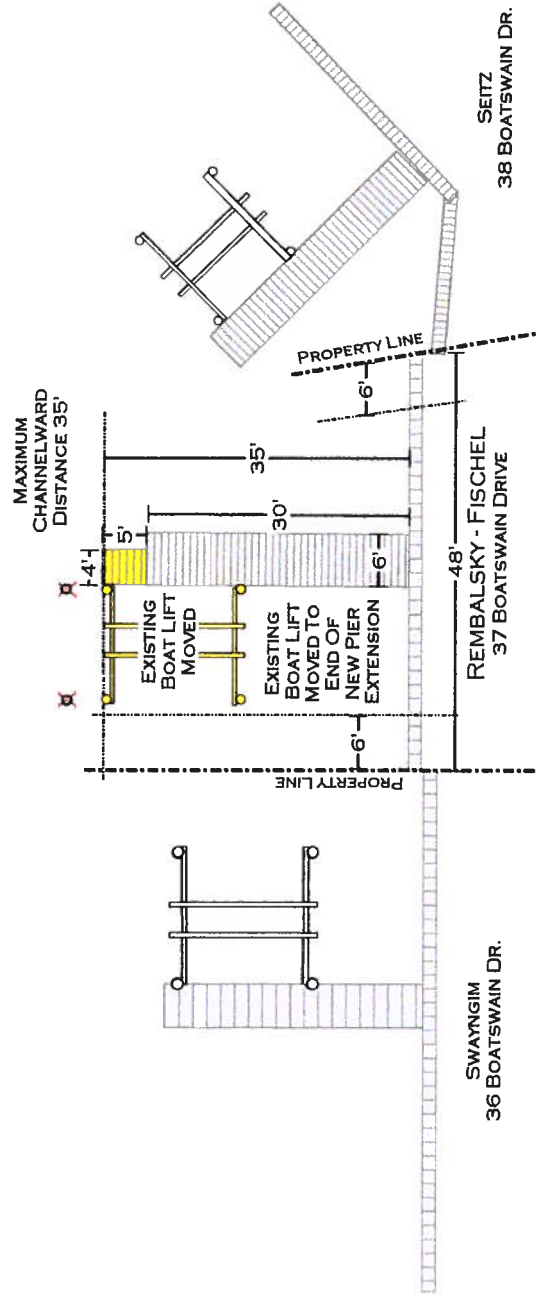
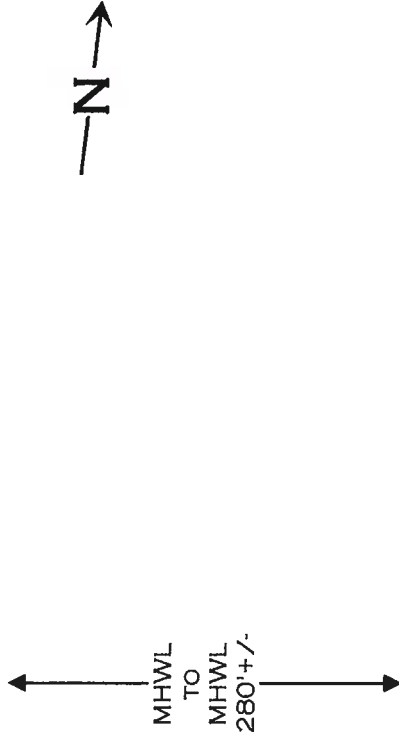

<p>SITE: 37 BOATSWAIN DRIVE OCEAN PINES, MD 21811</p>	<p>DRAWING: PROPOSED</p>	<p>PROJECT: 37 BOATSWAIN</p>	<p>DRAWN: H. SCHLEUPNER</p>	<p>MCGINTY MARINE CONSTRUCTION 12050 INDUSTRIAL PARK ROAD BISHOPVILLE, MD 21813 410-250-5066</p>
<p>TITLE: PETER REMBALSKY & EMILY FISCHEL</p>	<p>SCALE: 1" = 20'</p>	<p>DATE: 2/4/22</p>	<p>PAGE: 3 OF 4</p>	

PROPOSED PLAN

No KNOWN SAV'S

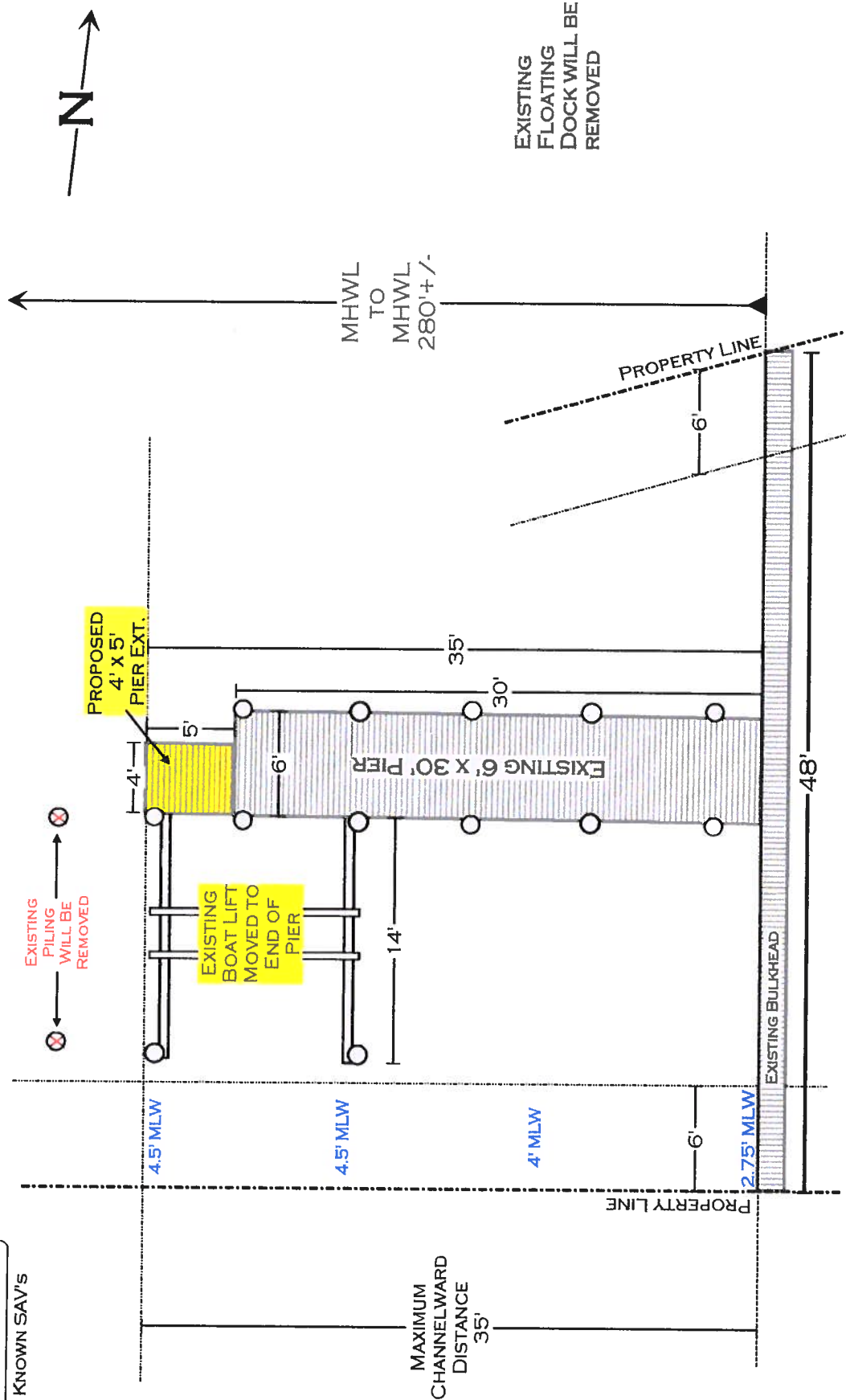

<p>SITE: 37 BOATSWAIN DRIVE OCEAN PINES, MD 21811</p>	<p>DRAWING: PROPOSED PLAN</p>	<p>PROJECT: 37 BOATSWAIN</p>	<p>DRAWN: H.SCHLEUPNER</p>	<p>MCGINTY MARINE CONSTRUCTION 12050 INDUSTRIAL PARK ROAD BISHOPVILLE, MD 21813 410-250-5066</p>
<p>TITLE: PETER REMBALSKY & EMILY FISCHER</p>	<p>SCALE: 1" = 8'</p>	<p>DATE: 2/4/22</p>	<p>PAGE: 2 OF 4</p>	

CROSS SECTION & MAP

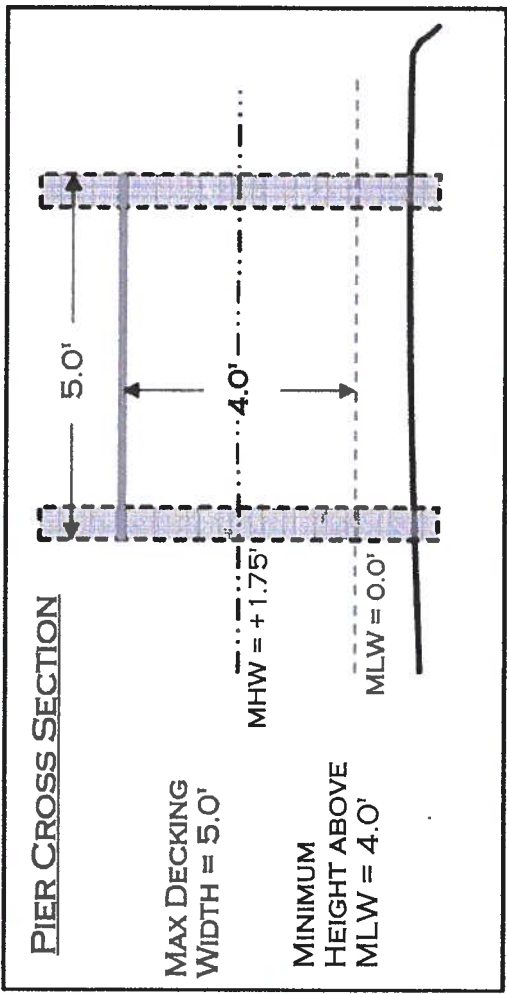
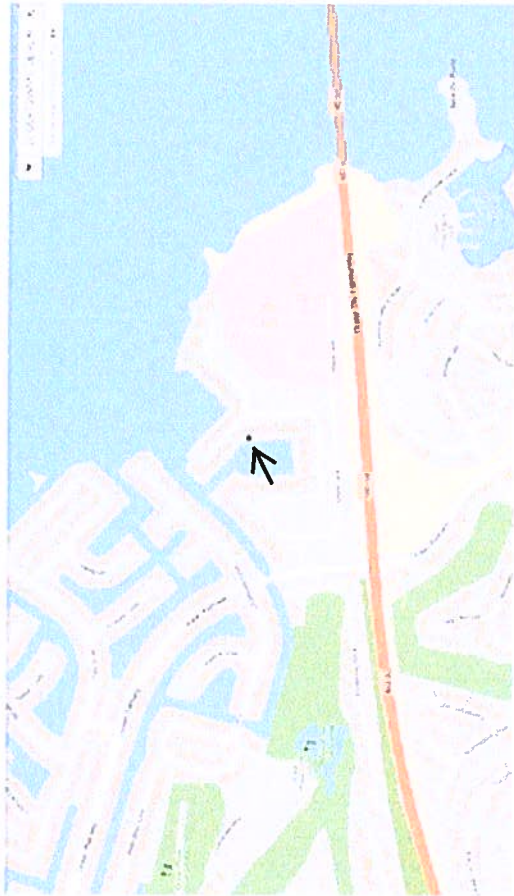

<p>SITE: 37 BOATSWAIN DRIVE OCEAN PINES, MD 21811</p>	<p>DRAWING: MAP CROSS SECTION</p>	<p>PROJECT: 37 BOATSWAIN</p>	<p>DRAWN: H. SCHLEUPNER</p>	<p>MCGINTY MARINE CONSTRUCTION 12050 INDUSTRIAL PARK ROAD BISHOPVILLE, MD 21813 410-250-5066</p>
<p>TITLE PETER REMBALSKY & EMILY FISCHER</p>	<p>SCALE: NONE</p>	<p>DATE: 2/4/22</p>	<p>PAGE: 4 OF 4</p>	

