



DEPARTMENT OF
ENVIRONMENTAL PROGRAMS

Worcester County

GOVERNMENT CENTER
ONE WEST MARKET STREET, ROOM 1306
SNOW HILL, MARYLAND 21863
TEL: 410.632.1220 / FAX: 410.632.2012

LAND PRESERVATION PROGRAM
STORMWATER MANAGEMENT
SEDIMENT AND EROSION CONTROL
SHORELINE CONSTRUCTION
AGRICULTURAL PRESERVATION
ADVISORY BOARD

WELL & SEPTIC
WATER & SEWER PLANNING
PLUMBING & GAS
CRITICAL AREAS/FORESTRY
COMMUNITY HYGIENE

March 21, 2024

This notification is to advise you that the Department has received and is presently reviewing the following request for a shoreline construction project:

Richard Gabelman– Request No. 2024-028 - Request to install 143' of replacement vinyl bulkhead. Maximum channelward distance not to exceed 1.5'. This project is located at 1632 Mercers Way, Berlin, also known as Tax map 16, Parcel 108, Lot 55. Third Tax District of Worcester County, Maryland.

The Department in considering this application will make specific findings of fact with regard to the environmental impact, navigational impact, recreational potential, commercial benefit to Worcester County, impact of the proposed construction upon the surrounding neighborhood and upon property values therein, and any other pertinent issues. Approval from the Department does not guarantee approval from any other applicable regulatory agencies.

If you have an interest which may be adversely affected by the issuance of this permit, you are requested to notify this Department in writing within fifteen (15) calendar days which will end on April 5, 2024.

Sincerely,

Brandy Whitlock
Environmental Inspector

cc: Interested Parties
Joy S. Birch
File



WORCESTER COUNTY
SHORELINE CONSTRUCTION
APPLICATION

Request No.: 2024-028
Submission Date: 3-21-24

 Major Construction (\$300.00)

 X Minor Construction (\$150.00)

Written Description of Proposed Improvement (include channelward distance):

Install 143' of replacement vinyl bulkhead. Maximum channel ward extension of 1.5'.

Map: 0016 Parcel: 0108 Lot: 55 Section: 3 Block: Tax District:
Street Address: 1632 Mercers Way, Ocean Pines, MD 21811
Subdivision: 0018
Dwelling on lot: Dwelling under construction: X Vacant: Commercial:

Owner: Richard Gabelman Phone No. 410-703-8494
Mailing Address: 908 Sand Brook Court, Gambrill's, MD 21054
E-Mail Address: rgabe908@gmail.com

Contractor: R. G. Murphy Marine Construction Phone No.: 443-497-0271
Mailing Address: 13239 Rollie Road, Bishopville, MD 21813
E-Mail Address: rgmurphy11@comcast.net

Recorded Adjacent Property Owner: Barry Godfrey
Property Address: 1630 Mercers Way, Ocean Pines, MD 21811
Tax Map: 0016 Parcel: 0108 Lot: 54 Section: 3 Block:

Recorded Adjacent Property Owner: Peter Snelling
Property Address: 1634 Mercers Way, Ocean Pines, MD 21811 - 12 Kashmir Dr Thornton, PA
Tax Map: 0016 Parcel: 0108 Lot: 56 Section: 3 Block: 19373

As the applicant, I attest that the information presented on this application, site plan and any written documentation attached hereto is known to be accurate. I understand that the proposed shoreline improvement will be constructed to meet or exceed minimum design standards adopted by the Department. Any deviation from these standards will require construction plans sealed by an engineer registered in the State of Maryland. I acknowledge that any falsification of information presented may result in revocation of this approval and of the subsequent Shoreline Construction Permit.

Owner/Applicant's Signature Date:

DEPT. USE ONLY:

Notification Distribution Date: 3-21-24 Public Comment Deadline: 4-5-24 (15 calendar days)
Department Approval Date: Expiration:

LOT 55 11607.7 SQ FT
 MERCER'S WAY SEC 3
 COLONIAL VILLAGE SEC 18

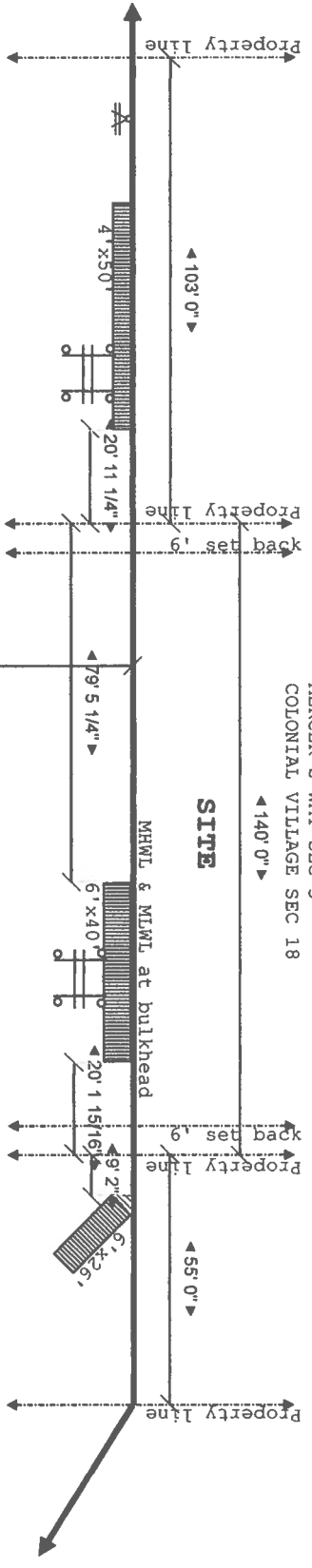

CANAL

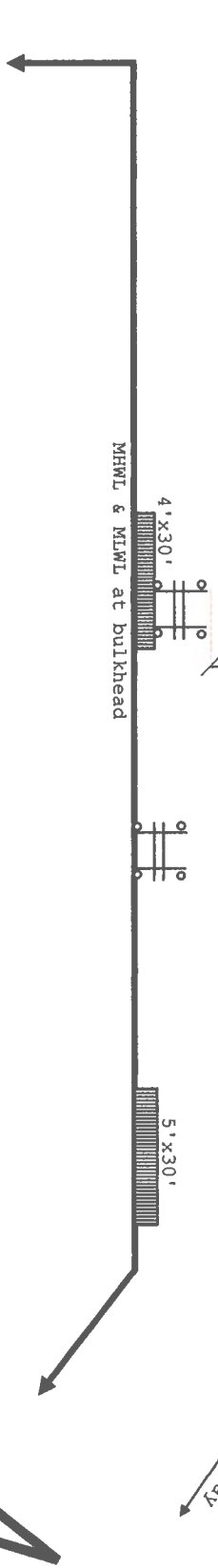

- NOTES**
1. There are no known SAV beds in the area.
 2. The soundings were taken on 05/20/2023.
 3. The maximum channelward extension is 1.5'.
- SCOPE**
- Install 143' of replacement vinyl bulkhead. Max Extension of 1.5'

Site:	1632 Mercers Way, OP MD	Drawing:	1	Project:	Cicala	Drawn:	Carouge	Notes:	Hidden Oak Farms, LLC
Title:	EXISTING CONDITIONS	Scale:	1/4"=10'0"	Date:	05/20/2023	Rev:	A		

LOT 55 11607.7 SQ FT
 MERCER'S WAY SEC 3
 COLONIAL VILLAGE SEC 18

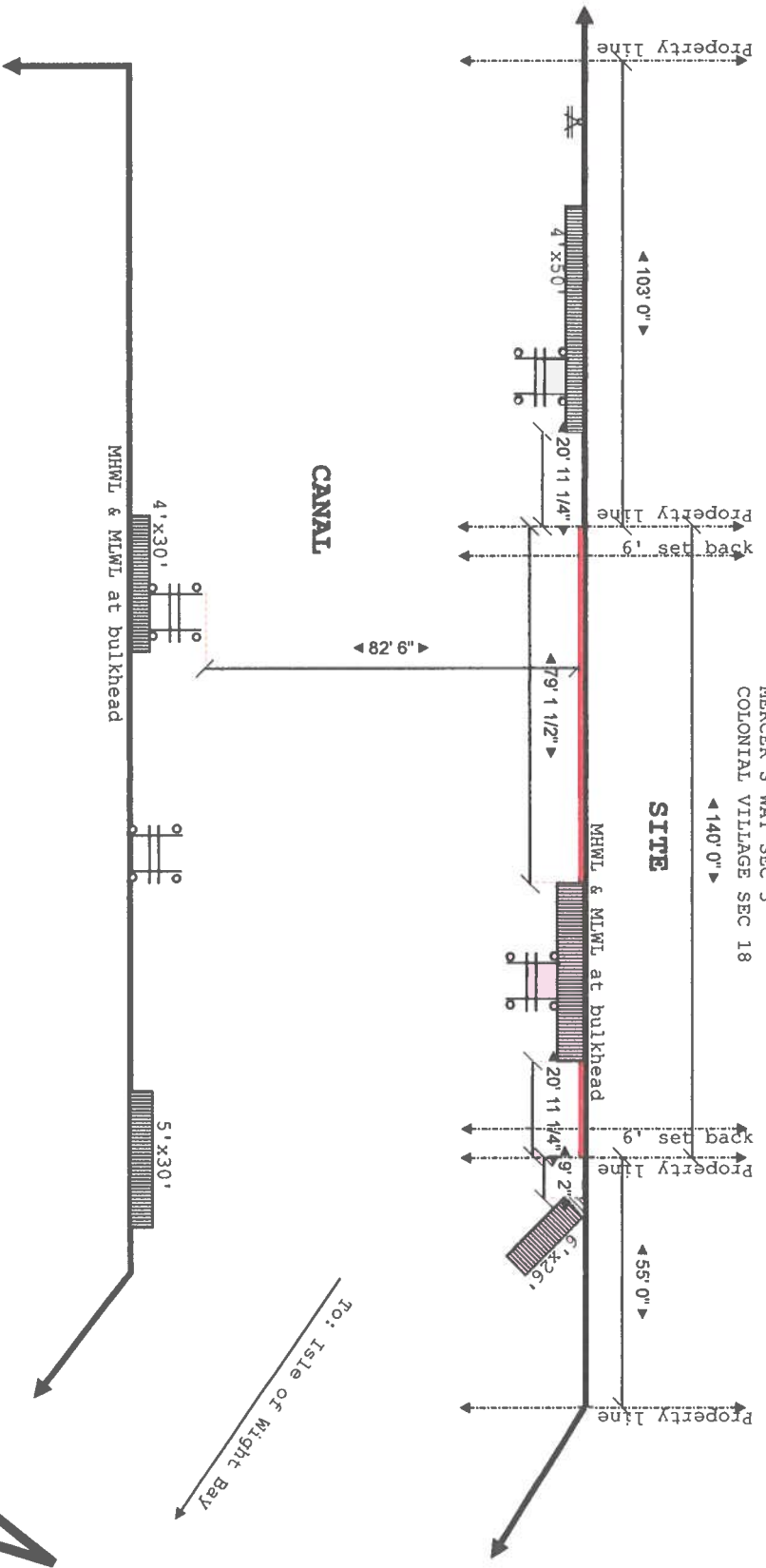

- NOTES**
1. There are no known SAV beds in the area.
 2. The soundings were taken on 05/20/2023.
 3. The maximum channelward extension is 1.5'.

SCOPE
 Install 143' of replacement vinyl bulkhead. Max Extension of 1.5'

Site:	1632 Mercers Way, OP MD	Drawing:	1	Project:	Cicala	Drawn:	Carouge	Notes:	Hidden Oak Farms, LLC
Title:	Proposed CONDITIONS	Scale:	1/4"=10'0"	Date:	05/20/2023	Rev:	A		

LOT 55 11607.7 SQ FT
 MERCER'S WAY SEC 3
 COLONIAL VILLAGE SEC 18

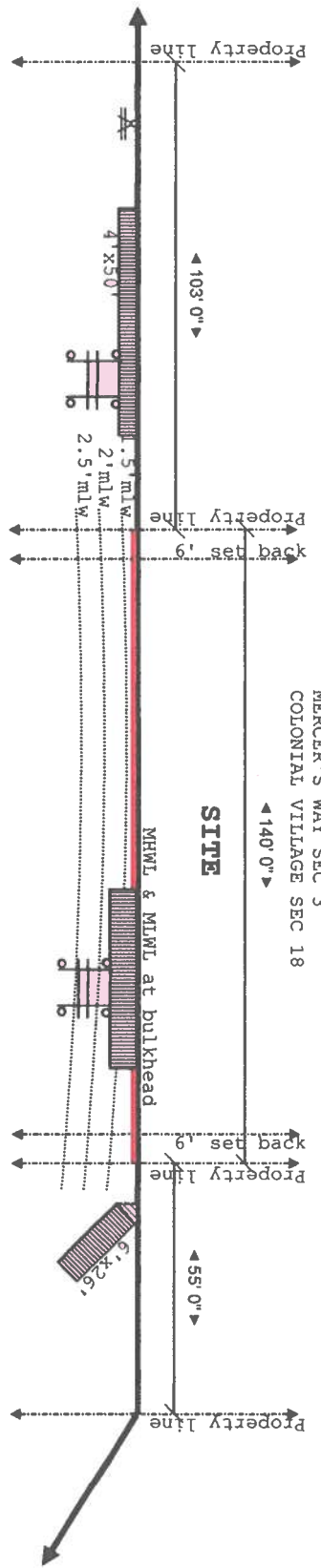

CANAL

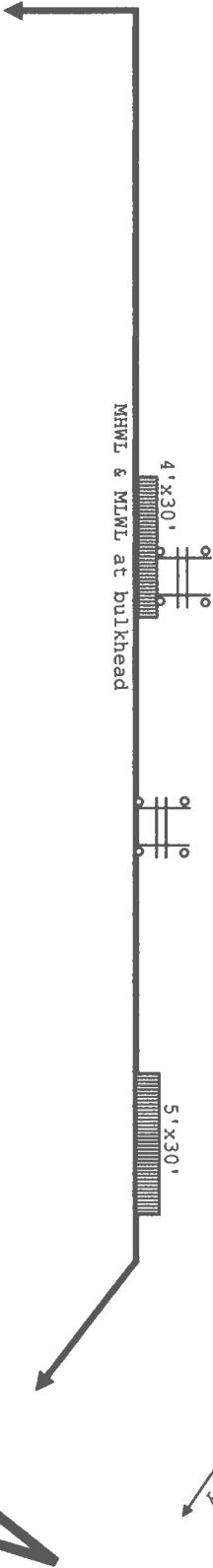

NOTES

1. There are no known SAV beds in the area.
2. The soundings were taken on 05/20/2023.
3. The maximum channelward extension is 1.5'.

SCOPE

Install 143' of replacement vinyl bulkhead. Max Extension of 1.5'



Site:	1632 Mercers Way, OP MD		Drawing:	1	
Title	DEPTHS		Project:	Cicala	
			Date:	05/20/2023	
			Rev:	A	
			Drawn:	Carouge	
			Scale:	1/4" = 10' 0"	
			Notes:	Hidden Oak Farms, LLC	

Search your mail or the web



Compose

← Back



IMG_1790.jpg



- Inbox 735
- Sent
- Drafts 12
- Spam
- Trash
- Undo
- Verbs 0/16
- Contacts
- Photos
- Documents
- Subscriptions
- Travel
- Folders Show



Search your mail or the web



Compose

← Back



IMG_1790.jpg



- Inbox 735
- Unread
- Sent
- Drafts 131
- Send
- Spam
- Trash
- Links
- Views 486
- Contact
- Photos
- Documents
- Subscriptions
- Travel
- Folders Show

