

NOTICE TO BIDDERS

Worcester County Health Department Facility in Snow Hill Entrance Door Assembly Replacement Project Worcester County, Maryland

The County Commissioners of Worcester County Maryland are currently accepting bids for replacing the existing front automatic sliding door assemblies at the Worcester County Health Department facility located at 6040 Public Landing Road, Snow Hill, Maryland 21863. Bid specification packages and bid forms are available from the Office of the County Commissioners, Worcester County Government Center, One West Market Street - Room 1103, Snow Hill, Maryland 21863, obtained online at www.co.worcester.md.us or by calling the Commissioners' Office at 410-632-1194 to request a package by mail. A pre-bid meeting will not be held but Bidders are encouraged to visit the facility to review demolition and installation requirements. **Sealed bids will be accepted until 1:00 p.m., Monday, January 11, 2016** in the Office of the County Commissioners at One West Market Street - Room 1103, Snow Hill, Maryland 21863, at which time they will be opened and publicly read aloud. Envelopes shall be marked "**Bid for Entrance Door Assembly - Snow Hill Health**" in the lower left-hand corner. After opening, bids will be forwarded to the Public Works Department for tabulation, review and recommendation to the County Commissioners for their consideration at a future meeting. In awarding the bid, the Commissioners reserve the right to reject any and all bids, waive formalities, informalities and technicalities therein, and to take whatever bid they determine to be in the best interest of the County considering lowest or best bid, quality of goods and work, time of delivery or completion, responsibility of bidders being considered, previous experience of bidders with County contracts, or any other factors they deem appropriate. All inquiries shall be directed to Kenneth J. Whited, Maintenance Superintendent, at 410-632-3766.

INSTRUCTIONS TO BIDDERS

1. **BIDS**

Bids should be submitted in sealed envelopes clearly marked in the lower left-hand corner **"Bid for Entrance Door Assembly – Snow Hill Health"**

2. **LATE BIDS**

Bids should be mailed or hand carried to be received in the Office of the County Commissioners by or before **1:00 p.m., Monday January 11, 2016**. Bids received after the appointed time will not be considered.

3. **TAXES**

The County is **NOT** exempt from all federal and state taxes on this project. Your prices should reflect included taxes.

4. **PRE-BID INSPECTION**

A pre-bid meeting will not be held but Bidders are encouraged to visit the facility to review demolition and installation requirements. Further inquires will be directed to Ken Whited during normal work days between the hours of 7:30 a.m. and 4:00 p.m. at (410) 632-3766 or by electronic mail to kenwhited@co.worcester.md.us.

5. **SCOPE OF SUPPLY**

Replace existing front entry door system (interior and exterior automatic sliding door assemblies) with swing door assemblies at the Worcester County Health Facility so located at 6040 Public Landing Road, Snow Hill, MD 21863. Sketches of the new assemblies are included herein for reference.

REPLACEMENT OF EXTERIOR SLIDING DOOR ASSEMBLY: Remove existing four panel exterior automatic sliding entrance doors, frames etc as may be required to:

FURNISH & INSTALL: New replacement swing door assembly to consist of; Kawneer 451T 2" x 4 ½" center glazed thermally broken aluminum framing for the sidelites. Pair of doors 6'0 x 7'0 Kawneer medium stile 350 dark bronze anodized out swing only aluminum entrance doors complete with: top/bottom/intermediate offset pivots, 10" bottom rails, Paneline mid panel recessed concealed vertical panic exit devices, Dorma 7515 exposed overhead closers, glazing is 1" bronze tempered lowE 10 year seal warranty insulated glass constructed of ¼" bronze tinted outboard – solarban 60 high performance lowE on #2 surface – ½" air space – ¼" clear tempered inboard, sweeps, 4 mill ADA compliant threshold. Disposition of automatic door assemblies will be at the owner's discretion.

REPLACEMENT OF INTERIOR SLIDING DOOR ASSEMBLY: Remove existing four panel interior automatic sliding entrance doors.

FURNISH & INSTALL: New replacement swing door assembly to consist of; Kawneer 450 1 ¾" x 4 ½" non thermal aluminum framing for the sidelites. Pair of doors 6'0 x 7'0 Kawneer medium stile 350 dark bronze anodized out swing only aluminum entrance doors complete with: top/bottom/intermediate offset pivots, 10" bottom rails, 8 ¼" crossrail, C09 CP 1" tubular push pull hardware, blank cylinders in active leaf, flushbolts in inactive leaf (door will be unlockable), 4" mill threshold, LCN exposed overhead closers, glazing for entire interior is ¼" clear laminated safety glass constructed of two lites 1/8" annealed and .030 binder for additional security and sound deadening.

Automate the active/right leaf only of each pair using two (2) Horton 4100LE sideload push assembly 39" RHR DKB with regular push arm, one (1) BEA 6" x 4" x 4" bollard steel in dark bronze, two (2) BEA PPP1 push plate package, two (2) BEA jamb switch press to open, two (2) BEA surface mount jamb box.

Automatic door exclusions: 1) 120VAC power to door operators shall be provided by others. 2) Worcester County Seal/Logo shall be provided by others.

NOTE: 1) See attached sketch of new door assemblies. 2) All new door systems shall meet all ADA accessible standards.

- **Work Included:**

- .1 Contractor shall provide all supervision, labor, materials, tools and equipment to remove and replace the existing door assemblies as described in the Bid Documents to the satisfaction of the County, governing inspection agencies and manufacturer.
- .2 Contractor shall notify the County in writing of any potential conflicts observed with performance of the work.
- .3 Contractor shall provide daily clean-up and removal off-site of all trash and debris generated by the work.
- .4 Contractor shall be required to locate stored materials in an area(s) designated by the County. Contractor further acknowledges the need to store some of the product off site. This may be at the Contractor's facilities or at the manufacturer's factory warehouse and if the Contractor is invoicing for stored materials then the Contractor shall provide insurance for the stored materials.
- .5 Contractor shall provide any vertical hoisting and horizontal transportation required by this scope.
- .6 Contractor to provide protective barriers and barricades as required protecting the staff and patrons of the building from any harm arising from performance of the work.
- .7 Contractor shall repair at its own expense any and all damage associated with the performance of this work.

6. **SPECIFICATIONS**

- A. All products shall be new.
- B. The Contractor or Manufacturer shall certify that all materials intended to be used in the work are acceptable and compatible for their intended end use.
- C. The supplied products shall be installed only by a qualified contraction firm, which has been installing the specified product for not less than 5 years and is approved (licensed where applicable) by the material/equipment manufacturer.
- D. All material/equipment selections, installation methods and fastening systems shall meet all applicable codes by the agency having jurisdiction for the work.
- E. Bidders shall include all fees, taxes, permits, electrical power for the work, compressed air for pneumatic tools, debris removal, clean up and inspections.
- F. Bidders/Contractors shall furnish all manufacturers warranties and include manufacturer's statements as applicable.

7. **PRODUCT**

All products shall be as described above unless the Bidder elects to provide alternate products that are equal to or better than what is specified. The alternate product manufacturers & models shall be submitted (complete product specifications/submittal) under separate cover with the Bid Form for the County's consideration. The alternate product shall be identified on the Bid Form. See section on form for listing the alternate products.

BID FORM

**County Commissioners of Worcester County Maryland
“Entrance Door Assembly – Snow Hill Health Facility”**

We the undersigned have received all of the Bid Documents, Addenda and reviewed the referenced work site as related to this project and fully understand the documents and requirements in their entirety. We agree to perform these services at a total cost as follows:

TOTAL BID PRICE: \$ _____, _____ .00

The Owner may request additional work or the Contractor may identify work that is required to complete the project but was not included in the Scope of Supply in the Bid Documents. All Bidders shall list their rates for additional work below.

INFORMATIONAL PRICING

Supervision...Additional Labor...per man hour.....ADD	\$ _____
Journeyman/Tech/Mechanic...Additional Labor...per man hour...ADD	\$ _____
Apprentice/Laborer...Additional Labor...per man hour.....ADD	\$ _____
Material Mark Up.....% ADD	

BID MUST BE SIGNED TO BE CONSIDERED

Date: _____ Signature: _____
Name: _____
Company: _____
Address: _____
Telephone: _____

NOTE: 1) ALTERNATE PRODUCTS TO BE LISTED AS AN ATTACHMENT TO THIS FORM...SEE FORM INCLUDED 2) ALTERNATE PRODUCT SUBMITTAL TO ACCOMPANY THIS FORM UNDER SEPARATE COMPANY LETTERHEAD.

ALTERNATE PRODUCT LIST

ITEM	DESCRIPTION/MFG./MODEL/MATERIAL
ALT. NO. 1	
ALT. NO. 2	
ALT. NO. 3	
ALT. NO. 4	
ALT. NO. 5	
ALT. NO. 6	

Project Name: Worcester County Health Dept
 Frame Set Name: Interior Main Entry
 Metal Group: M450 CG/SS/OG STOPS DOWN Modified: 39
 Required: 1 Panels: 3 Rows: 3
 Back Member Color: #40 DARK BRONZE : PERMANODIC

5/4/2015 10:59 AM

Frame Name: Frame 2
 D/S: 1 Frame Type: Standard
 Frame Width: 144 Frame Height: 103
 Face Member Color: #40 DARK BRONZE : PERMANODIC

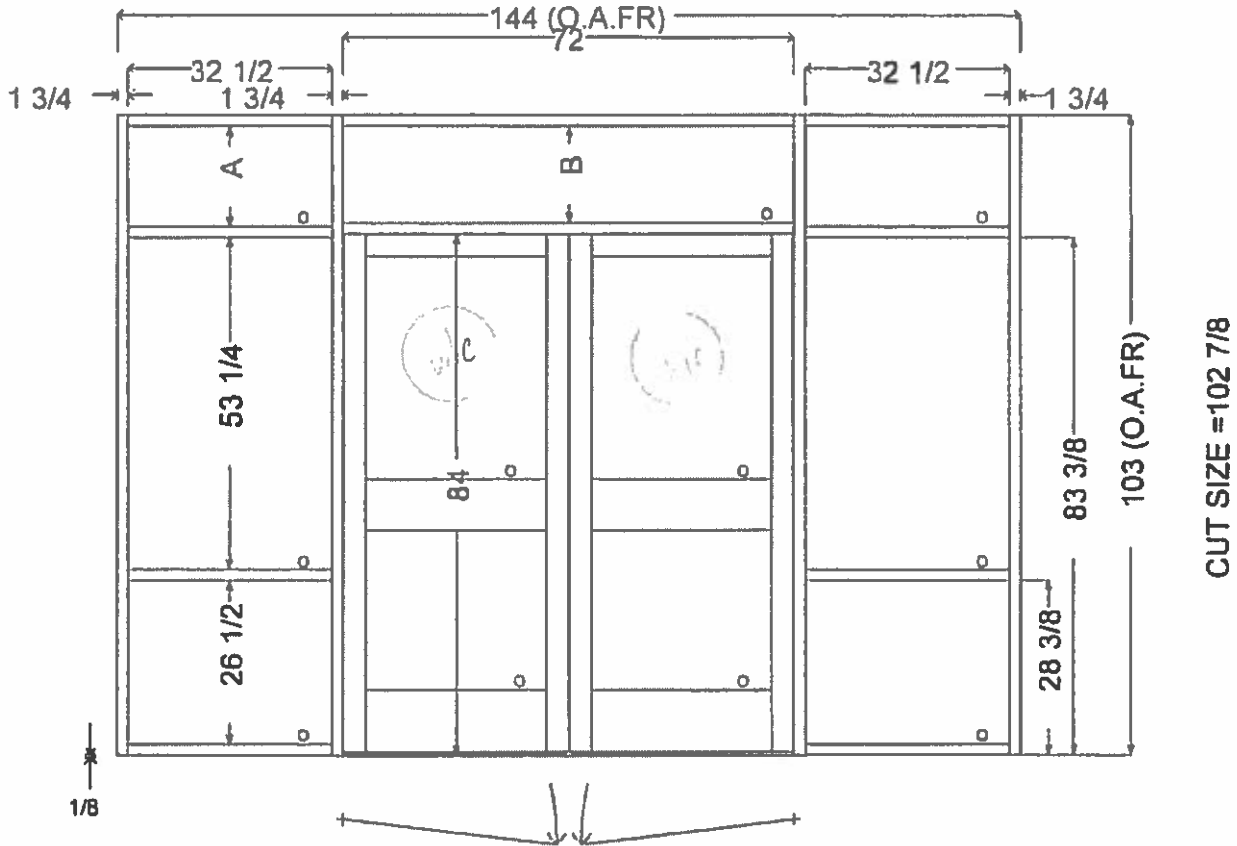

A=16 1/8 B=15 1/2



100% ... HIGH PERFORMANCE
 ... ONLY