



DEPARTMENT OF  
ENVIRONMENTAL PROGRAMS

## Worcester County

GOVERNMENT CENTER  
ONE WEST MARKET STREET, ROOM 1306  
SNOW HILL, MARYLAND 21863  
TEL: 410.632.1220 / FAX: 410.632.2012

LAND PRESERVATION PROGRAM  
STORMWATER MANAGEMENT  
SEDIMENT AND EROSION CONTROL  
SHORELINE CONSTRUCTION  
AGRICULTURAL PRESERVATION  
ADVISORY BOARD

WELL & SEPTIC  
WATER & SEWER PLANNING  
PLUMBING & GAS  
CRITICAL AREAS/FORESTRY  
COMMUNITY HYGIENE

August 28, 2019

This notification is to advise you that the Department has received and is presently reviewing the following request for a shoreline construction project:

Nancy Moore – Request No. 2019-062 – Request to do some shoreline restoration which includes three (3) 5' x 50' stone sills and sandy back fill, along with the installation of a 6' x 32' platform not to exceed 25' channelward. The project also includes the construction of a 6' x 50' bridge. This project is located at 12540 Collins Road, also known as Tax Map 9, Parcel 345, Lot 4, Fifth Tax District of Worcester County, Maryland.

The Department in considering this application will make specific findings of fact with regard to the environmental impact, navigational impact, recreational potential, commercial benefit to Worcester County, impact of the proposed construction upon the surrounding neighborhood and upon property values therein, and any other pertinent issues. Approval from the Department does not guarantee approval from any other applicable regulatory agencies.

**If you have an interest which may be adversely affected by the issuance of this permit, you are requested to notify this Department in writing within fifteen (15) calendar days which will end on September 12, 2019.**

Sincerely,

Joy S. Birch  
Natural Resources Specialist III

cc: Interested Parties  
David Bradford, Deputy Director  
File



WORCESTER COUNTY  
SHORELINE CONSTRUCTION  
APPLICATION

Request No.: 2019-062  
Submission Date: 8/22/19

X Major Construction (\$150.00) \_\_\_\_\_ Minor Construction (\$75.00)

**Written Description of Proposed Improvement (include channelward distance):**

Install a 6' x 50' bridge with both ends being on the site, 150' of living shoreline with (3) 50' stone sills, and a 6' x 32' platform.  
Maximum channel ward extension of 25'.

**Property Description:**

Map: 0009 Parcel: 0345 Lot: 4 Section: \_\_\_\_\_ Block: \_\_\_\_\_ Tax District: 5  
Street Address: 12540 Collins Road, Bishopville, MD 21813  
Subdivision: 1085  
Dwelling on lot: X Dwelling under construction: \_\_\_\_\_ Vacant: \_\_\_\_\_ Commercial: \_\_\_\_\_

Owner: Nancy Moore Phone No. \_\_\_\_\_  
Mailing Address: 12540 Collins Road, Bishopville, MD 21813  
E-Mail Address: nancymoore395@gmail.com

Contractor: Newport Bay Marine Construction Phone No.: 724-372-3201  
Mailing Address: South Main St., Berlin, MD 21811  
E-Mail Address: info@newportbayconstruction.com

Recorded Adjacent Property Owner: Donna Rhynalds  
Property Address: 12516 Collins Road, Bishopville, MD 21813  
Tax Map: 0009 Parcel: 0299 Lot: 1A Section: \_\_\_\_\_ Block: \_\_\_\_\_

Recorded Adjacent Property Owner: ~~Karlene Sexauer~~ Brent Curd  
Property Address: ~~12544 Collins Road, Bishopville, MD 21813~~ 12536 Collins Rd, Bishopville MD 21813  
Tax Map: 0009 Parcel: 0345 Lot: 2 Section: \_\_\_\_\_ Block: \_\_\_\_\_

As the applicant, I attest that the information presented on this application, site plan and any written documentation attached hereto is known to be accurate. I understand that the proposed shoreline improvement will be constructed to meet or exceed minimum design standards adopted by the Department. Any deviation from these standards will require construction plans sealed by an engineer registered in the State of Maryland. I acknowledge that any falsification of information presented may result in revocation of this approval and of the subsequent Shoreline Construction Permit.

Nancy Moore/RWF Freund POA  
Owner/Applicant's Signature Date

\*\*\*\*\*  
LDA =

DEPT. USE ONLY:  
Notification Distribution Date: 8.28.19 Public Comment Deadline: 9.12.19 (15 calendar days)  
Department Approval Date: \_\_\_\_\_ Expiration: \_\_\_\_\_

# Bishopville Prong

The opposite shore is  
in excess of 500' away

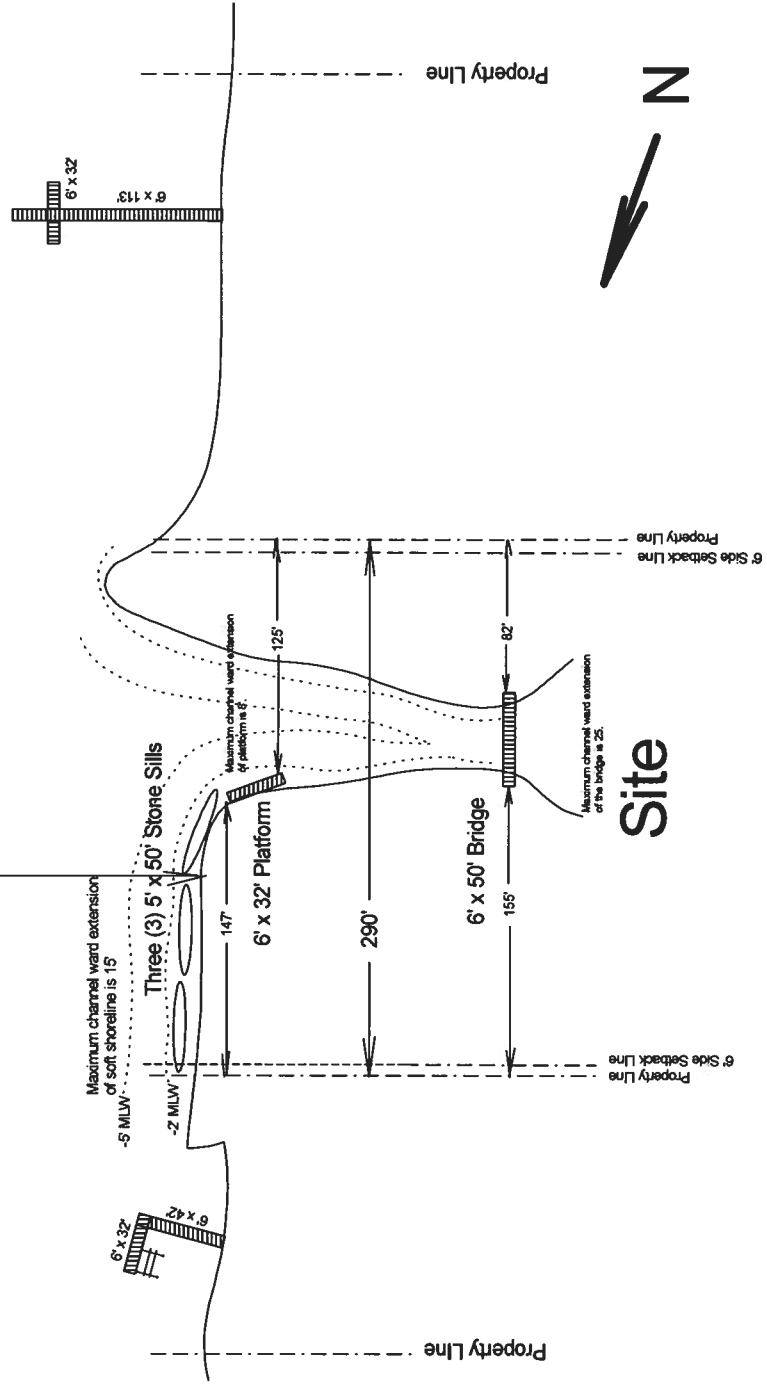

Site

1. There are no known SAV beds in the area.
2. The soundings were taken August 1, 2019

**Work Scope:**  
Install a 6' x 50' bridge across waterway with this site on both sides. Also install 150' of soft shoreline on the Prong side of the property and a 6' x 32' platform. Maximum channel ward extension of 25'.

**Scale:** 1" = 100'

**Date:** August 15, 2019

<b>Owner:</b> Nancy Moore 12540 Collins Road Bishopville, MD 21813		<b>Lot</b>	<b>Blk</b>	<b>Sec</b>	<b>T. Map</b>	<b>Parcel</b>
--	--	------------	------------	------------	---------------	---------------

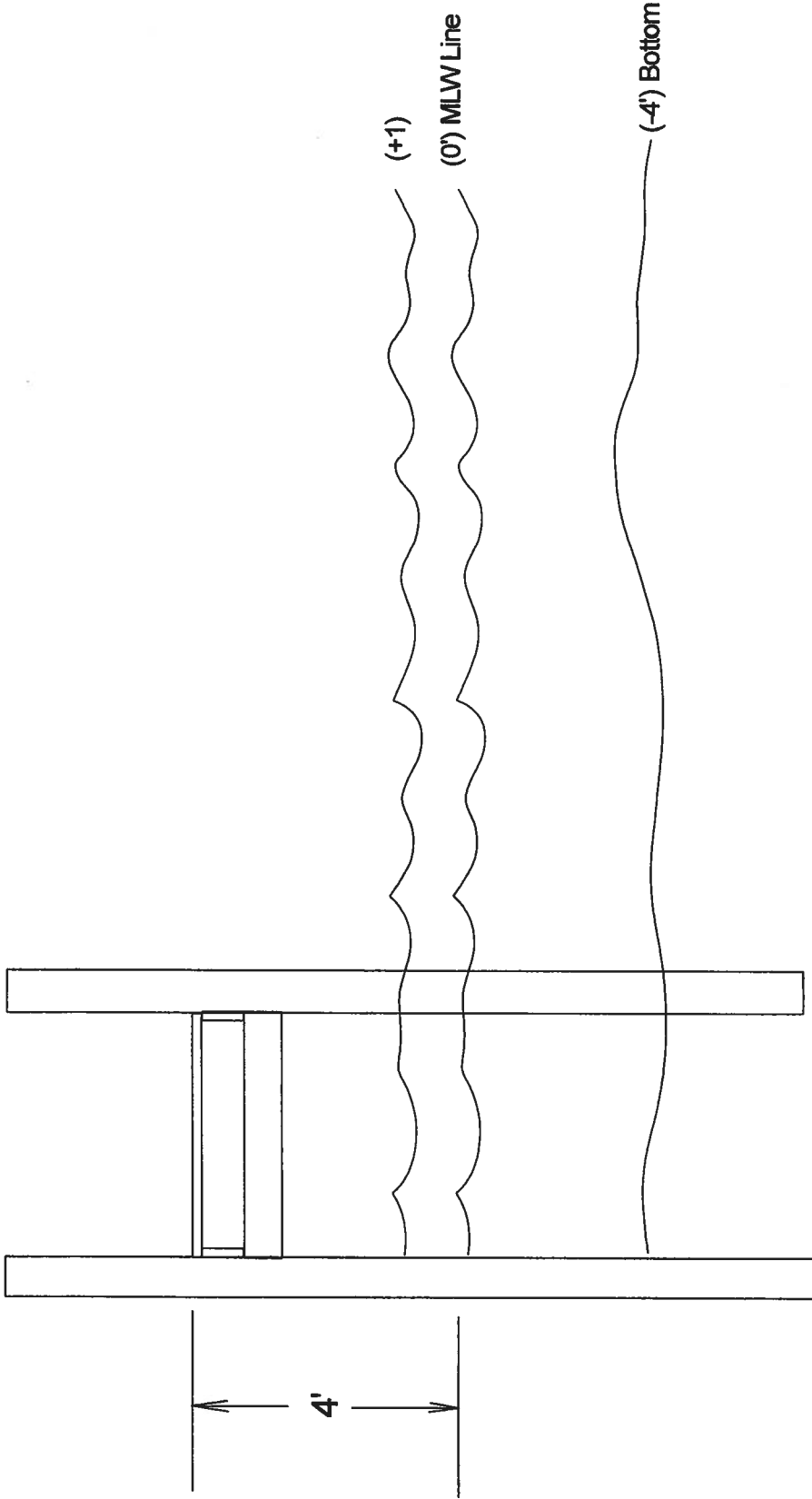

Work Scope: Pier cross section for 12540 Collins Road  
 Bishopville, MD 21813

Scale: 1" = 20'

Date:

Owner:

Lot

Blk

T. Map

Parcel

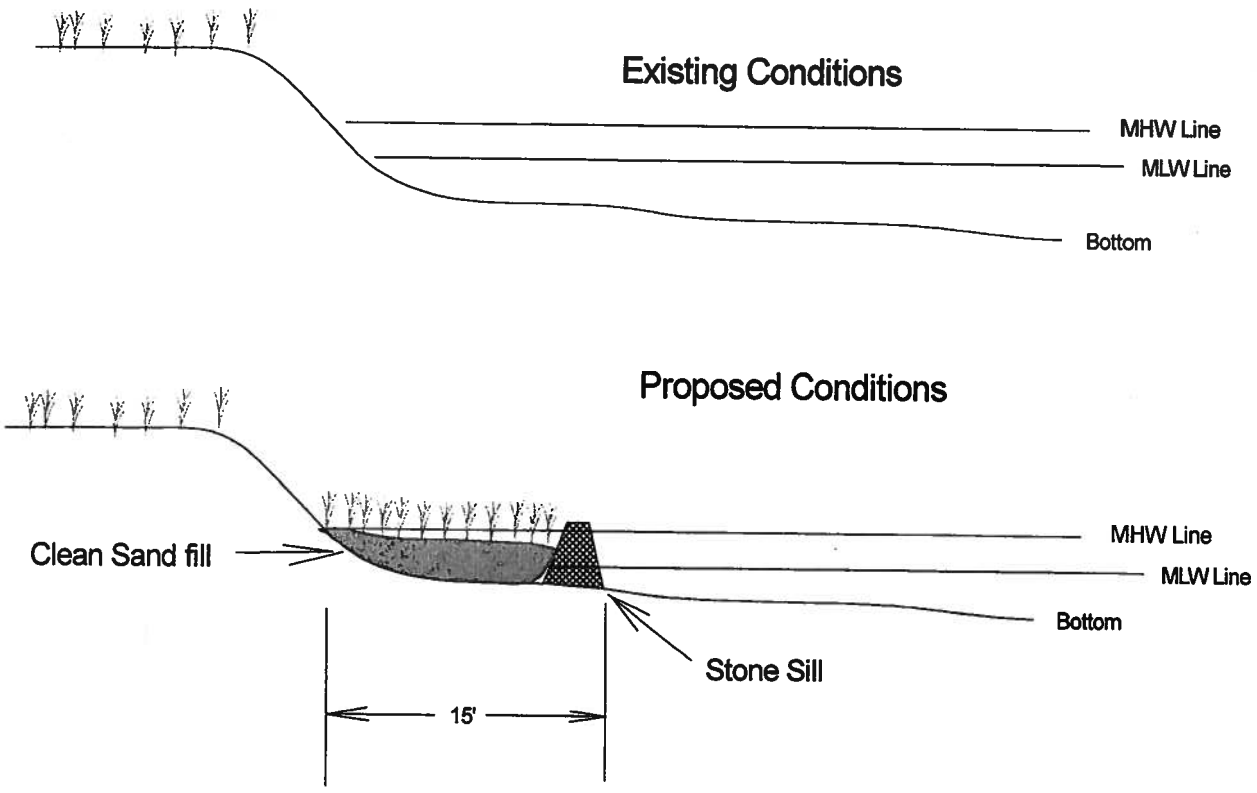

Work Scope: Stone sill cross section existing and proposed 12540 Collins Road, Bishopville, MD				
Scale: 1" = 20'				
Date:				
Owner:	Lot	Blk	T. Map	Parcel

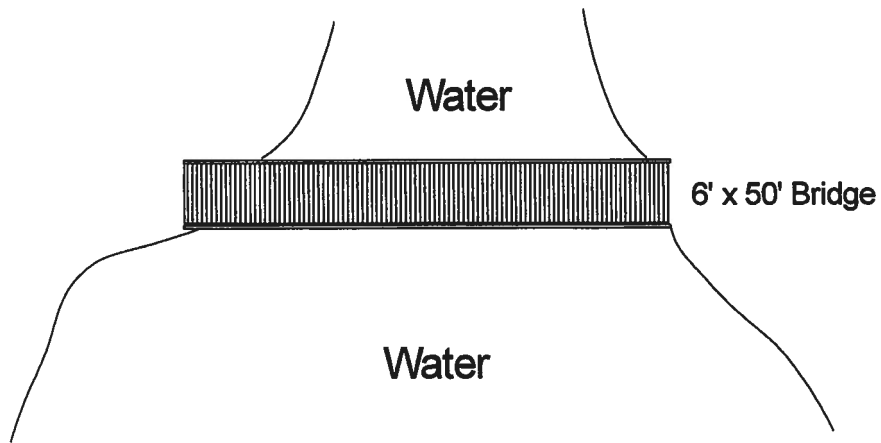

Work Scope: Proposed bridge views				
12540 Collins Road, Bishopville, MD				
Scale: 1" = 20'				
Date:				
Owner:	Lot	Blk	T. Map	Parcel

# Untitled Map

Write a description for your map.

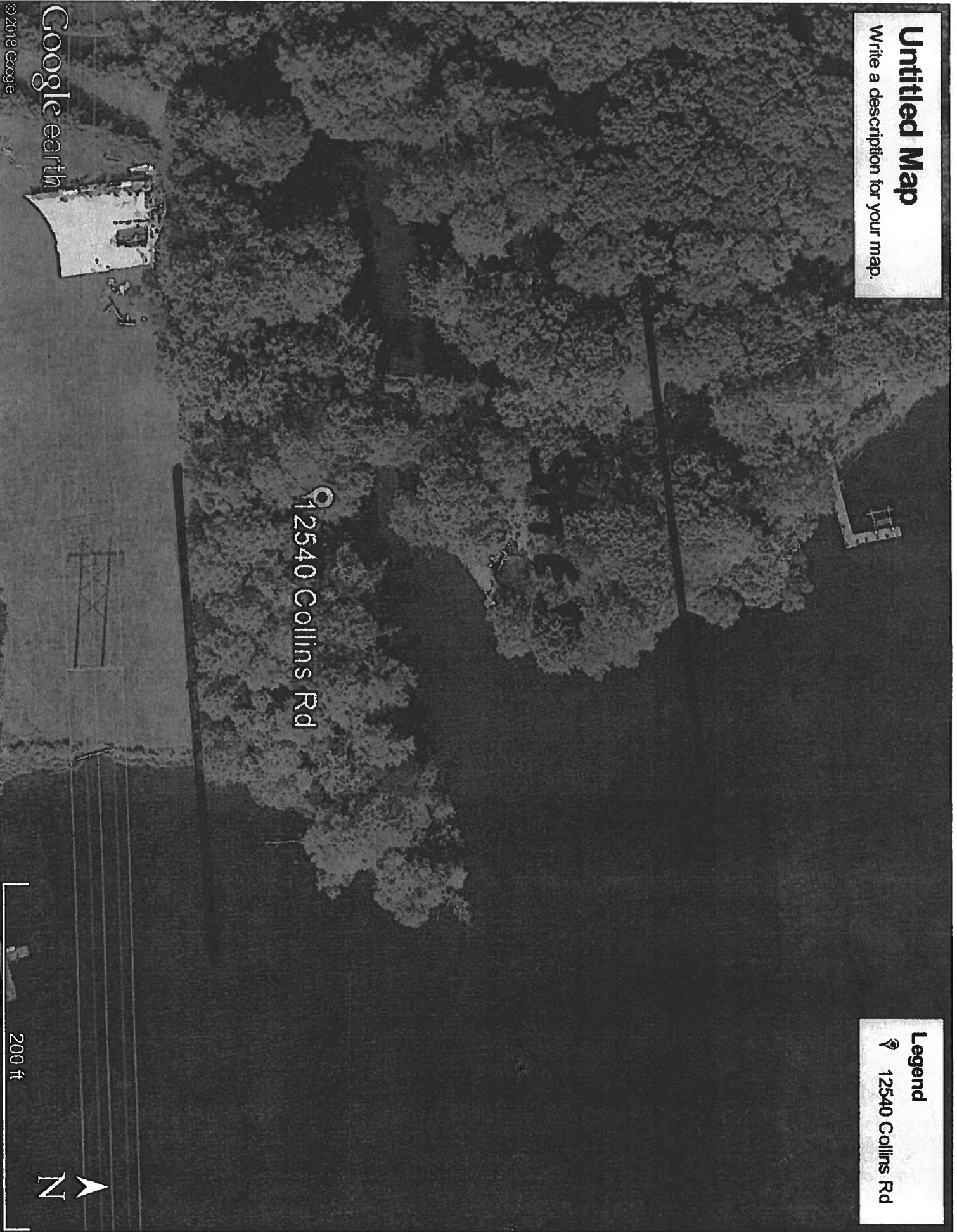

## Legend

 12540 Collins Rd

Google earth

© 2018 Google

200 ft

