



DEPARTMENT OF
ENVIRONMENTAL PROGRAMS

Worcester County

GOVERNMENT CENTER
ONE WEST MARKET STREET, ROOM 1306
SNOW HILL, MARYLAND 21863
TEL: 410.632.1220 / FAX: 410.632.2012

LAND PRESERVATION PROGRAM
STORMWATER MANAGEMENT
SEDIMENT AND EROSION CONTROL
SHORELINE CONSTRUCTION
AGRICULTURAL PRESERVATION
ADVISORY BOARD

WELL & SEPTIC
WATER & SEWER PLANNING
PLUMBING & GAS
CRITICAL AREAS/FORESTRY
COMMUNITY HYGIENE

August 22, 2019

This notification is to advise you that the Department has received and is presently reviewing the following request for a shoreline construction project:

Ruth Rhynalds Waters – REVISION to Request No. 2019-045 – Request to construct a 6' x 117' pier with an 8' X 25' "L" shaped platform not to exceed 125' channelward. This request also includes the installation of eight (8) mooring pilings. This project is located at 11738 Riverview Drive, St Martin's by the Bay Community, also known as Tax Map 16, Parcel 86, Lot 11, Third Tax District of Worcester County, Maryland.

The Department in considering this application will make specific findings of fact with regard to the environmental impact, navigational impact, recreational potential, commercial benefit to Worcester County, impact of the proposed construction upon the surrounding neighborhood and upon property values therein, and any other pertinent issues. Approval from the Department does not guarantee approval from any other applicable regulatory agencies.

If you have an interest which may be adversely affected by the issuance of this permit, you are requested to notify this Department in writing within fifteen (15) calendar days which will end on September 5, 2019.

Sincerely,

Joy S. Birch

Natural Resources Specialist III

cc: Interested Parties
David Bradford, Deputy Director
File



WORCESTER COUNTY SHORELINE CONSTRUCTION APPLICATION

Revision Request No.: 2019-045 Submission Date: 8/21/19

xx Major Construction (\$150) Minor Construction (\$75)

Written Description of Proposed Improvement (include channelward distance):

construct a 6x117 pier with an 8x25 "L" head; install eight (8) mooring pilings a maximum of 125' channelward of existing bulkhead/MHW/MLW

Property Description:

Map: 16 Parcel: 86 Lot: 11 Section: Block: Tax District: 3 Street Address: 11738 Riverview Drive Subdivision: St. Martin's By the Bay Dwelling on lot: xx Dwelling under construction: Vacant: Commercial:

Owner: Ruth Rhynalds Waters Phone No. Mailing Address: 11738 Riverview Drive, Berlin, MD 21811 E-Mail Address: rwatershg@gmail.com cell: 410-430-4169

Contractor: J. Stacey Hart & Associates, Inc. Phone No.: 410-390-8096 Mailing Address: PO Box 6, Snow Hill, MD 21863 E-Mail Address: stacey@jstaceyhart.com

Recorded Adjacent Property Owner: Philip & Elizabeth Young Property Address: 11734 Riverview Drive Tax Map: 16 Parcel: 86 Lot: 12 Section: Block:

Recorded Adjacent Property Owner: Blair & Allison Snyder Property Address: 4 Clubhouse Drive, Berlin, MD 21811 Tax Map: 16 Parcel: A Lot: Section: Block:

As the applicant, I attest that the information presented on this application, site plan and any written documentation attached hereto is known to be accurate. I understand that the proposed shoreline improvement will be constructed to meet or exceed minimum design standards adopted by the Department. Any deviation from these standards will require construction plans sealed by an engineer registered in the State of Maryland. I acknowledge that any falsification of information presented may result in revocation of this approval and of the subsequent Shoreline Construction Permit.

Ruth Rhynalds Waters 4/25/15 Owner/Applicant's Signature Date

LOA-100'

DEPT. USE ONLY:

Notification Distribution Date: Public Comment Deadline: (15 calendar days) Department Approval Date: Expiration:

Revision Request

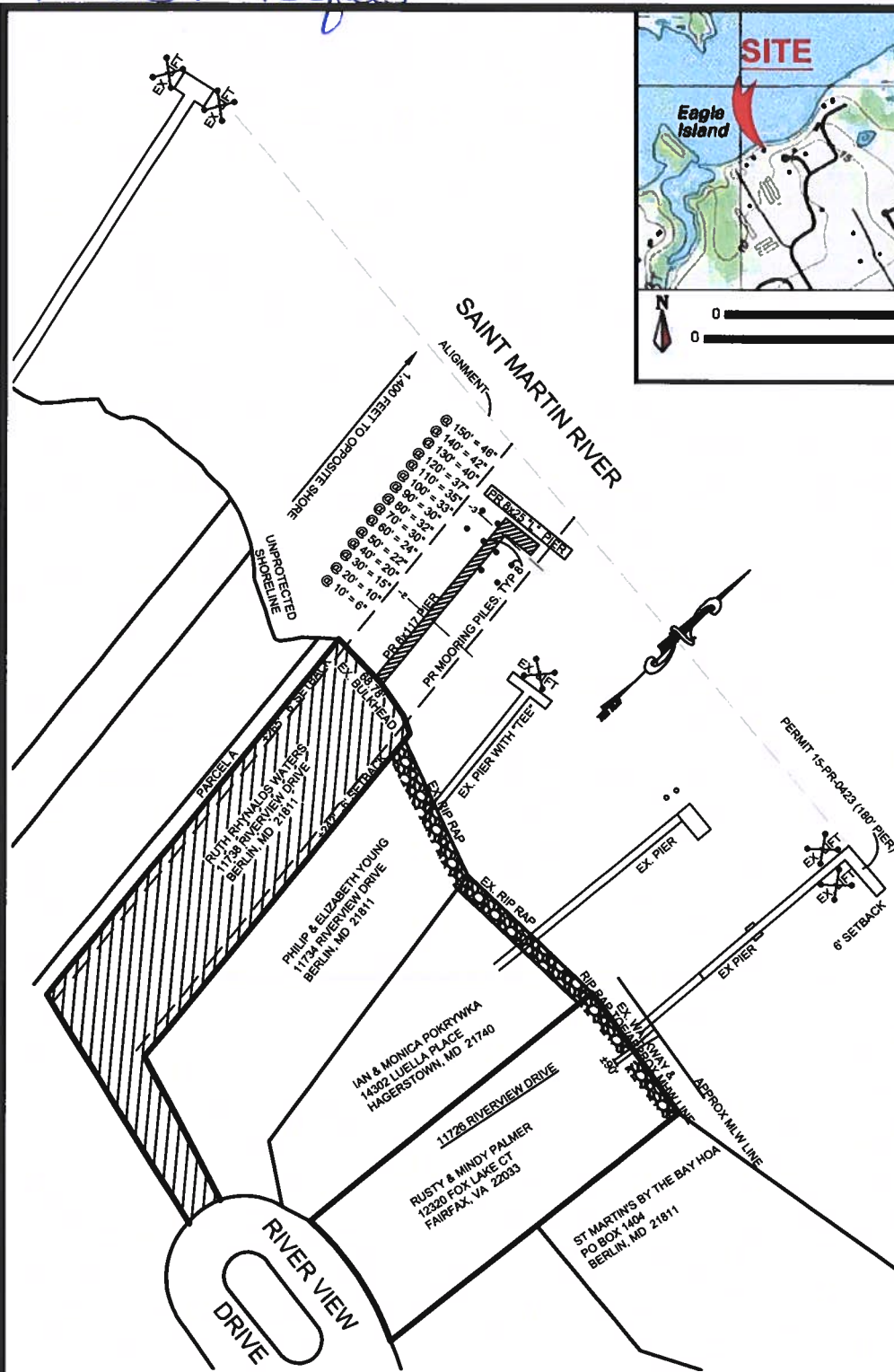
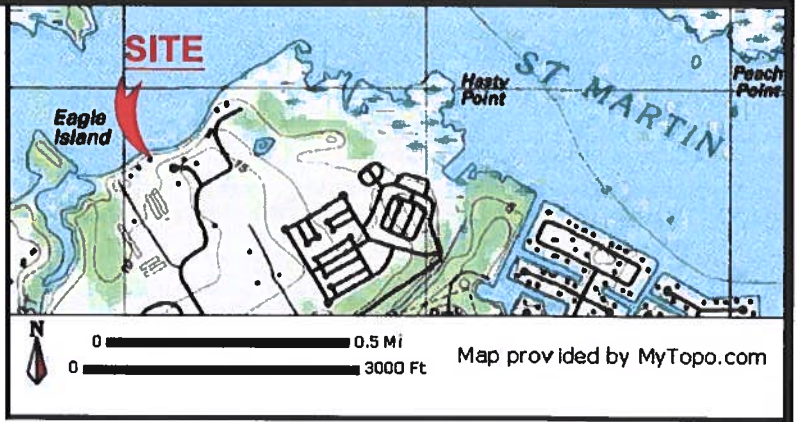

PROJECT DESCRIPTION:
 CONSTRUCT 6x117 PIER WITH A
 8x25 "L" AT END; INSTALL EIGHT (8)
 MOORING PILES A MAXIMUM OF 125
 FEET CHANNELWARD OF MHW.

**RHYNALDS WATERS PROPERTY
 PROPOSED PIER & LIFTS
 11738 RIVERVIEW DRIVE
 BERLIN, WORCESTER COUNTY**

APPLICANT:
 RUTH RHYNALDS WATERS
 11738 RIVERVIEW DRIVE
 BERLIN, MD 21811

LOCATION: ST. MARTINS BY THE BAY NO SAV'S
 WATERWAY: ST MARTIIN RIVER
 WATER DEPTH MEASUREMENTS: 4/23/19
 REFERENCED TO MLW 12:15 P.M.
 TAX MAP: 16
 PARCEL: 86
 GRID: 2
 LOT: 11

JOB NUMBER: P19-021	SCALE: 1"=100'	SHEET NO: 1 OF 3	DATE: 5/8/2019	REVISED: 7/25/19
------------------------	-------------------	---------------------	-------------------	---------------------

COPYRIGHT © 2019

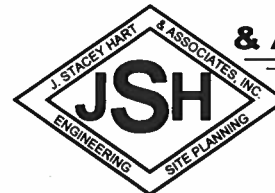

**J. STACEY HART
 & ASSOCIATES, INC.**

POST OFFICE BOX 6
 SNOW HILL, MD 21863
 PHONE: 410-390-8096
 FAX: 877-646-4365
 EMAIL: stacey@jstaceyhart.com

Revision Request

SAINT MARTIN RIVER

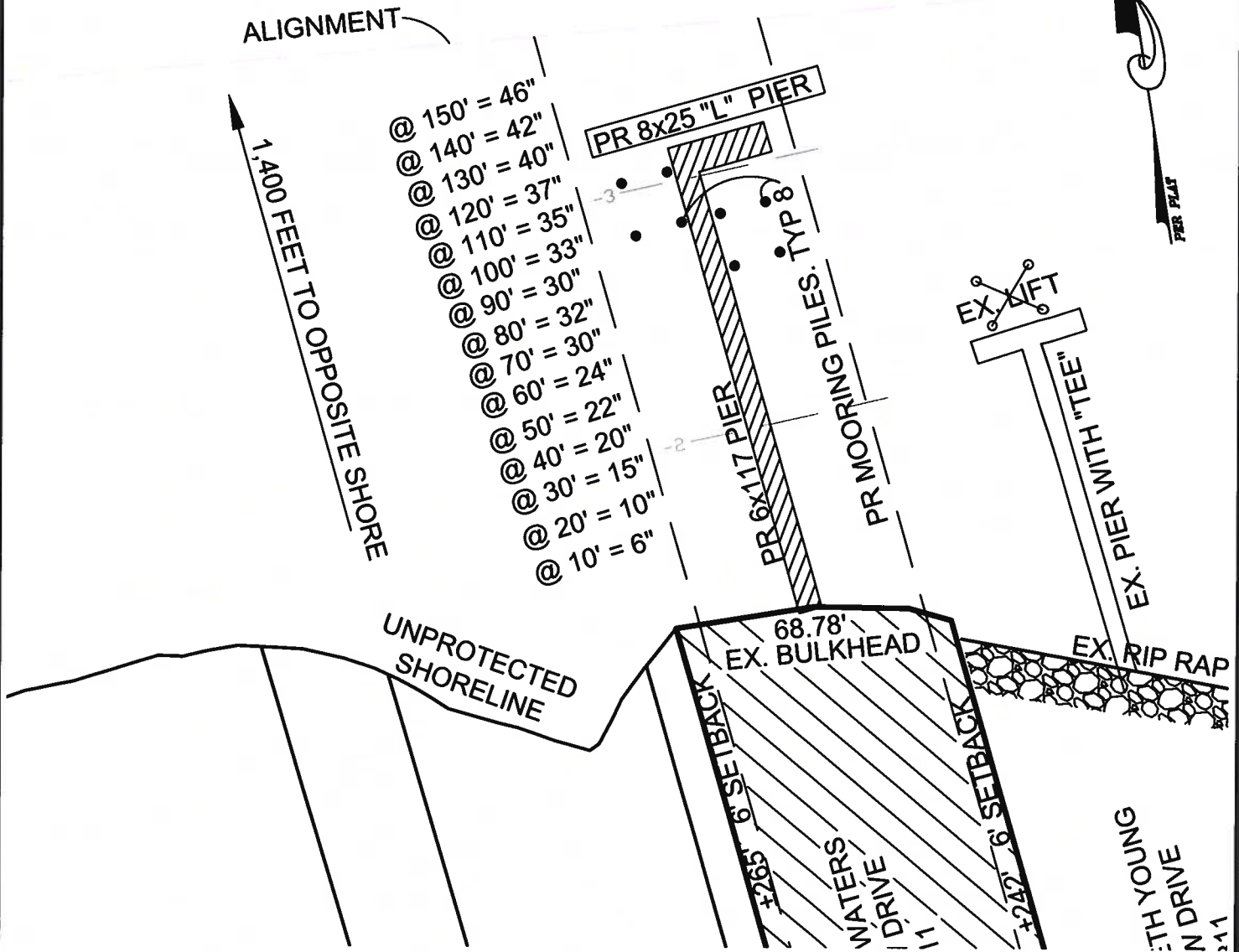

**RHYNALDS WATERS PROPERTY
PROPOSED PIER & LIFTS
11738 RIVERVIEW DRIVE
BERLIN, WORCESTER COUNTY**

APPLICANT:
RUTH RHYNALDS WATERS
11738 RIVERVIEW DRIVE
BERLIN, MD 21811

LOCATION: ST. MARTINS BY THE BAY NO SAV'S
WATERWAY: ST MARTIIN RIVER
WATER DEPTH MEASUREMENTS: 4/23/19
REFERENCED TO MLW 12:15 P.M.

TAX MAP: 16
PARCEL: 86
GRID: 2
LOT: 11

COPYRIGHT © 2019



**J. STACEY HART
& ASSOCIATES, INC.**

POST OFFICE BOX 6
SNOW HILL, MD 21863
PHONE: 410-390-8096
FAX: 877-646-4365
EMAIL: stacey@jstaceyhart.com

JOB NUMBER: P19-021	SCALE: 1"=40'	SHEET NO: 2 OF 3	DATE: 5/8/2019	REVISED: 7/25/19
------------------------	------------------	---------------------	-------------------	---------------------

Revision Request

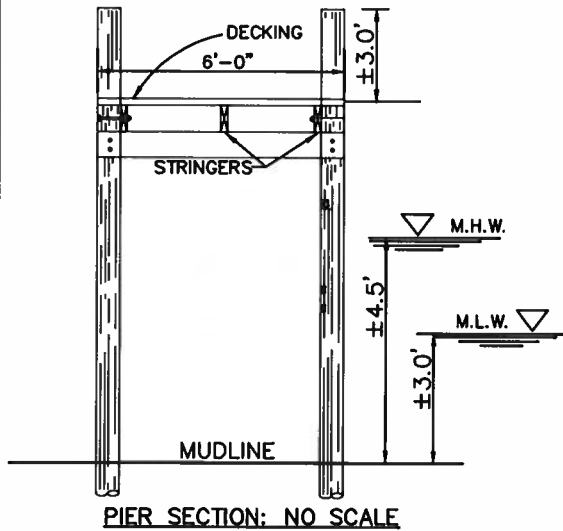

MOORING PILES: NO SCALE

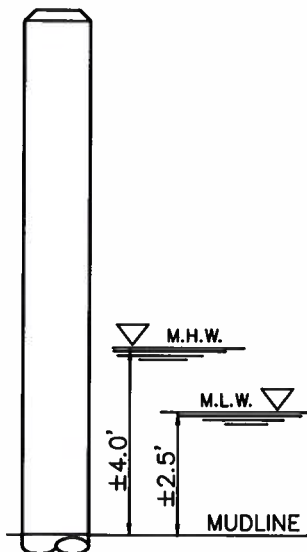

**RHYNALDS WATERS PROPERTY
PROPOSED PIER & LIFTS
11738 RIVERVIEW DRIVE
BERLIN, WORCESTER COUNTY**

APPLICANT:
RUTH RHYNALDS WATERS
11738 RIVERVIEW DRIVE
BERLIN, MD 21811

LOCATION: ST. MARTINS BY THE BAY
WATERWAY: ST MARTIN RIVER
WATER DEPTH MEASUREMENTS: 4/23/19
REFERENCED TO MLW 12:15 P.M.

NO SAV'S

TAX MAP: 16
PARCEL: 86
GRID: 2
LOT: 11

COPYRIGHT © 2019



**J. STACEY HART
& ASSOCIATES, INC.**

POST OFFICE BOX 6
SNOW HILL, MD 21863
PHONE: 410-390-8096
FAX: 877-646-4365
EMAIL: stacey@jstaceyhart.com

JOB NUMBER: P19-021	SCALE: NONE	SHEET NO. 3 OF 3	DATE: 5/8/2019	REVISED: 7/25/19
------------------------	----------------	---------------------	-------------------	---------------------

Original Request



WORCESTER COUNTY SHORELINE CONSTRUCTION APPLICATION

Request No.: 2019-045 Submission Date: 6/20/19

Major Construction (\$150) Minor Construction (\$75)

Written Description of Proposed Improvement (include channelward distance):

construct a 6x144 pier with an 8x25 "L" head; install two (2) boat lifts and two (2) PWC lifts with associated pilings a maximum of 152' channelward of existing bulkhead/MHW/MLW

Property Description:

Map: 16 Parcel: 86 Lot: 11 Section: Block: Tax District: 3 Street Address: 11738 Riverview Drive Subdivision: St. Martin's By the Bay Dwelling on lot: xx Dwelling under construction: Vacant: Commercial:

Owner: Ruth Rhynalds Waters Phone No.:

Mailing Address: 11738 Riverview Drive, Berlin, MD 21811

E-Mail Address: rwatershg@gmail.com cell: 410-430-4169

Contractor: J. Stacey Hart & Associates, Inc. Phone No.: 410-390-8096

Mailing Address: PO Box 6, Snow Hill, MD 21863

E-Mail Address: stacey@jstaceyhart.com

Recorded Adjacent Property Owner: Philip & Elizabeth Young

Property Address: 11734 Riverview Drive

Tax Map: 16 Parcel: 86 Lot: 12 Section: Block:

Recorded Adjacent Property Owner: Blair & Allison Snyder

Property Address: 4 Clubhouse Drive, Berlin, MD 21811

Tax Map: 16 Parcel: A Lot: Section: Block:

As the applicant, I attest that the information presented on this application, site plan and any written documentation attached hereto is known to be accurate. I understand that the proposed shoreline improvement will be constructed to meet or exceed minimum design standards adopted by the Department. Any deviation from these standards will require construction plans sealed by an engineer registered in the State of Maryland. I acknowledge that any falsification of information presented may result in revocation of this approval and of the subsequent Shoreline Construction Permit.

WORCESTER COUNTY SHORELINE CONSTRUCTION APPROVAL

APPROVED BY: [Signature]

DATE: 7/22/19 APPROVAL # 2019-45

Owner/Applicant's Signature: Ruth Rhynalds Waters Date: 4/28/19

EXPIRATION: 2yr.

COMMENTS: 100 BZA approval req'd. As-built req'd.

DEPT. USE ONLY:

Notification Distribution Date: 6/20/19 Public Comment Deadline: 7/11/19 (15 calendar days)

Department Approval Date: 7/22/19 Expiration: 2yr.

Original request

WORCESTER COUNTY SHORELINE CONSTRUCTION APPROVAL

APPROVED BY: *[Signature]*

DATE: *7/22/19* APPROVAL # *2019-45*

EXPIRATION: *2 yr.*

COMMENTS: *BZA approval req'd. SAINT MARTIN As-built req'd.*

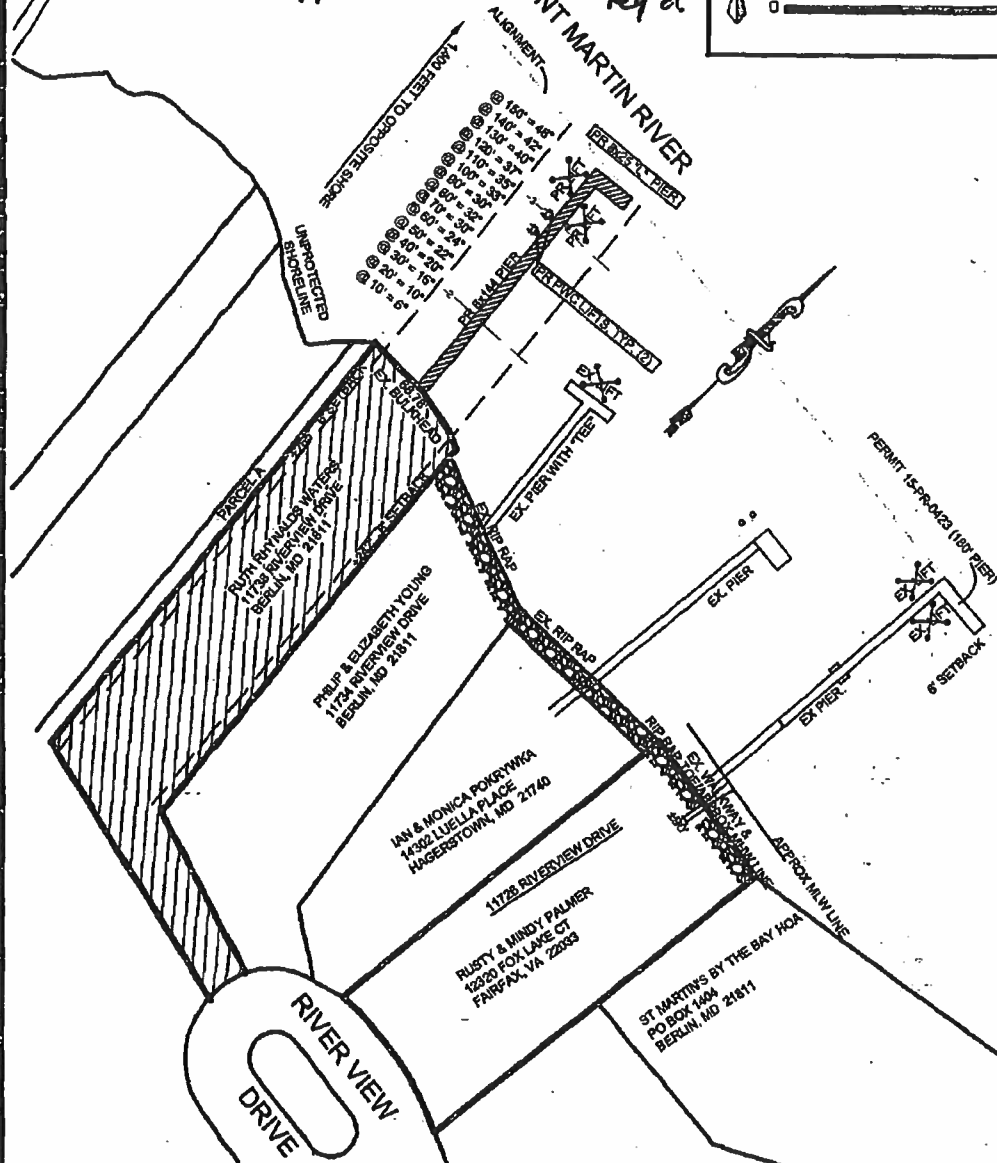
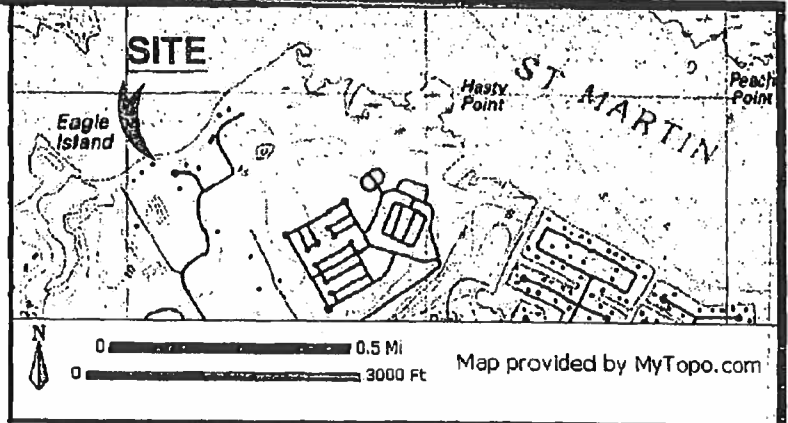

PROJECT DESCRIPTION:
 CONSTRUCT 6x144 PIER WITH A 8x25 "L" AT END; INSTALL TWO (2) BOAT LIFTS AND TWO (2) PWC LIFTS WITH ASSOCIATED PILINGS A MAXIMUM OF 152 FEET CHANNELWARD OF MHW. CHANNELWARD DISTANCE ALIGNS WITH EXISTING STRUCTURES IN CHANNEL.

**RHYNALDS WATERS PROPERTY
 PROPOSED PIER & LIFTS
 11738 RIVERVIEW DRIVE
 BERLIN, WORCESTER COUNTY**

APPLICANT:
 RUTH RHYNALDS WATERS
 11738 RIVERVIEW DRIVE
 BERLIN, MD 21811

LOCATION: ST. MARTINS BY THE BAY
 WATERWAY: ST MARTIN RIVER
 WATER DEPTH MEASUREMENTS: 4/23/19
 REFERENCED TO MLW 12:15 P.M.

NO SAV'S
 TAX MAP: 16
 PARCEL: 86
 GRID: 2
 LOT: 11

COPYRIGHT © 2019

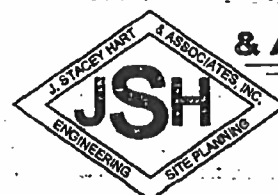

**J. STACEY HART
 & ASSOCIATES, INC.**

POST OFFICE BOX 6
 SNOW HILL, MD 21863
 PHONE: 410-390-8096
 FAX: 877-648-4365
 EMAIL: stacey@jstaceyhart.com

JOB NUMBER: P19-021	SCALE: 1"=100'	SHEET NO: 1 OF 3	DATE: 5/8/2019	REVISED: N/A
------------------------	-------------------	---------------------	-------------------	-----------------

original request

WORCESTER COUNTY SHORELINE CONSTRUCTION APPROVAL

APPROVED BY: *[Signature]*

DATE: 7/22/19 APPROVAL # 8019-45

EXPIRATION: 2 yr.

COMMENTS: BZA approval req'd. As-built req'd.

SAINT MARTIN RIVER

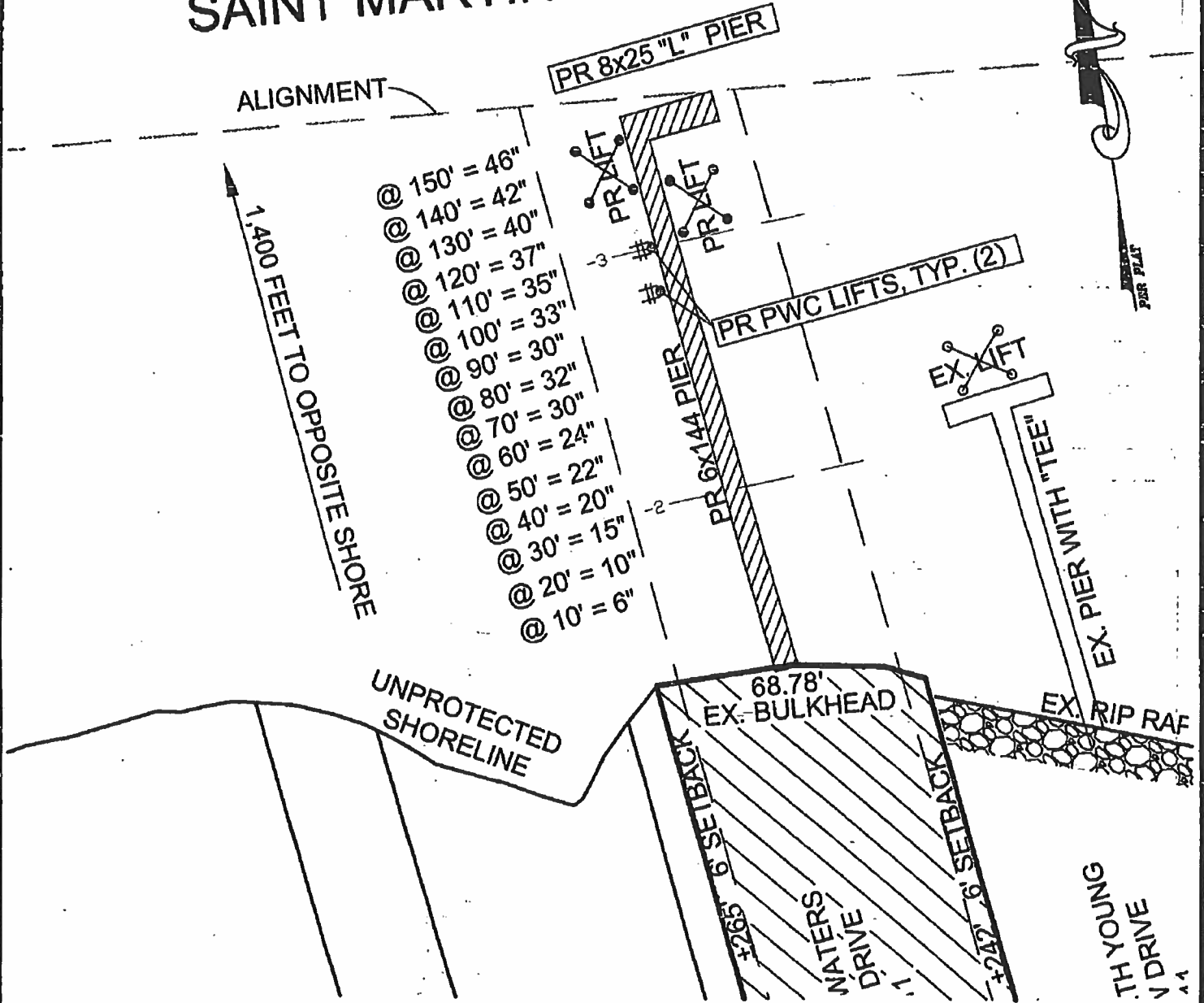

**RHYNALDS WATERS PROPERTY
 PROPOSED PIER & LIFTS
 11738 RIVERVIEW DRIVE
 BERLIN, WORCESTER COUNTY**

APPLICANT:
 RUTH RHYNALDS WATERS
 11738 RIVERVIEW DRIVE
 BERLIN, MD 21811

LOCATION: ST. MARTINS BY THE BAY
WATERWAY: ST MARTIN RIVER
WATER DEPTH MEASUREMENTS: 4/23/19
 REFERENCED TO MLW 12:15 P.M.

NO SAVS

TAX MAP: 16'
 PARCEL: 86
 GRID: 2
 LOT: 11

COPYRIGHT © 2019

**J. STACEY HART
 & ASSOCIATES, INC.**

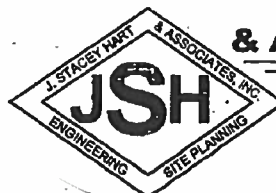

POST OFFICE BOX 6
 SNOW HILL, MD 21883
 PHONE: 410-390-8086
 FAX: 877-846-4365
 EMAIL: stacey@jstaceyhart.com

JOB NUMBER: P19-021	SCALE: 1"=40'	SHEET NO.: 2 OF 3	DATE: 5/8/2019	REVISED: N/A
-------------------------------	-------------------------	-----------------------------	--------------------------	------------------------

original request

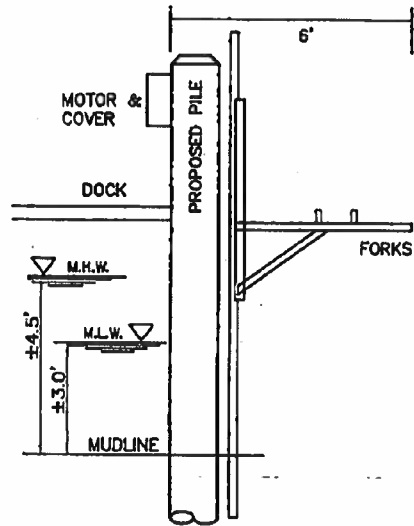
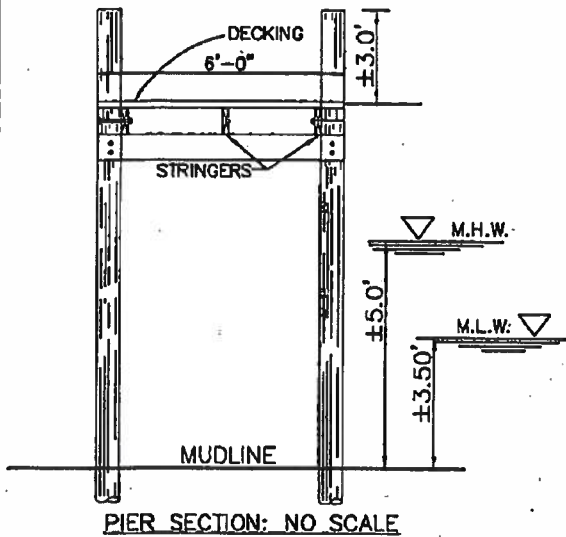

BOA LIFT SECTION: NO SCALE

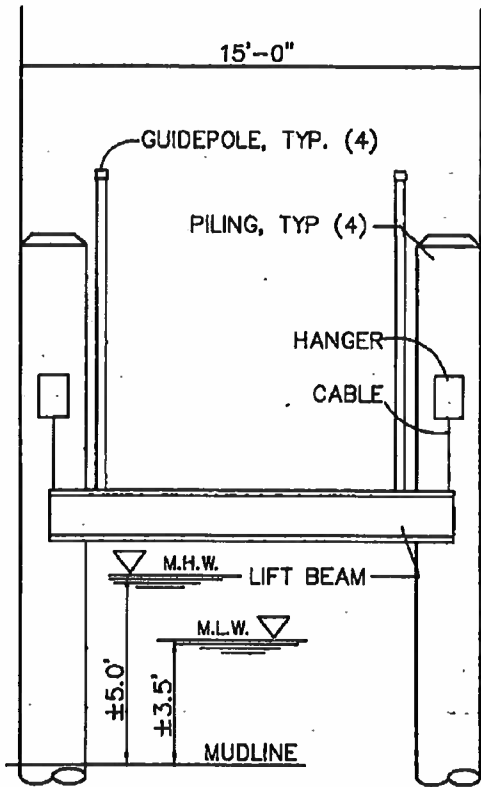

WORCESTER COUNTY SHORELINE CONSTRUCTION APPROVAL

APPROVED BY: *[Signature]*

DATE: 7/23/19 APPROVAL# 2019-45

EXPIRATION: 2yr.

COMMENTS: BZA approval req'd. As-built req'd

**RHYNALDS WATERS PROPERTY
PROPOSED PIER & LIFTS
11738 RIVERVIEW DRIVE
BERLIN, WORCESTER COUNTY**

APPLICANT:
RUTH RHYNALDS WATERS
11738 RIVERVIEW DRIVE
BERLIN, MD 21811

LOCATION: ST. MARTINS BY THE BAY
WATERWAY: ST MARTIIN RIVER
WATER DEPTH MEASUREMENTS: 4/23/19
REFERENCED TO MLW 12:15 P.M.

NO SAVS

TAX MAP: 16
PARCEL: 86
GRID: 2
LOT: 11

COPYRIGHT © 2019



**J. STACEY HART
& ASSOCIATES, INC.**

POST OFFICE BOX 6
SNOW HILL, MD 21863
PHONE: 410-390-8096
FAX: 877-646-4366
EMAIL: stacey@jstaceyhart.com

JOB NUMBER: P19-021	SCALE: NONE	SHEET NO. 3 OF 3	DATE: 5/8/2019	REVISED: N/A
------------------------	----------------	---------------------	-------------------	-----------------