



DEPARTMENT OF  
ENVIRONMENTAL PROGRAMS

**Worcester County**

GOVERNMENT CENTER  
ONE WEST MARKET STREET, ROOM 1306  
SNOW HILL, MARYLAND 21863  
TEL: 410.632.1220 / FAX: 410.632.2012

LAND PRESERVATION PROGRAM  
STORMWATER MANAGEMENT  
SEDIMENT AND EROSION CONTROL  
SHORELINE CONSTRUCTION  
AGRICULTURAL PRESERVATION  
ADVISORY BOARD

WELL & SEPTIC  
WATER & SEWER PLANNING  
PLUMBING & GAS  
CRITICAL AREAS/FORESTRY  
COMMUNITY HYGIENE

March 13, 2024

This notification is to advise you that the Department has received and is presently reviewing the following request for a shoreline construction project:

Vernon Summers Jr– Request No. 2024-026 - Request to install one pole and two jet ski lifts. Maximum channelward distance not to exceed 6'. This project is located at 26 Harlan Trace Dr, Berlin, also known as Tax map 16, Parcel 96, Lot 17. Third Tax District of Worcester County, Maryland.

The Department in considering this application will make specific findings of fact with regard to the environmental impact, navigational impact, recreational potential, commercial benefit to Worcester County, impact of the proposed construction upon the surrounding neighborhood and upon property values therein, and any other pertinent issues. Approval from the Department does not guarantee approval from any other applicable regulatory agencies.

**If you have an interest which may be adversely affected by the issuance of this permit, you are requested to notify this Department in writing within fifteen (15) calendar days which will end on March 28, 2024.**

Sincerely,

Brandy Whitlock  
Environmental Inspector

cc: Interested Parties  
Joy S. Birch  
File



WORCESTER COUNTY SHORELINE CONSTRUCTION APPLICATION

Request No.: 2024-026 Submission Date: 3-13-24

Major Construction (\$300.00)

X Minor Construction (\$150.00)

Written Description of Proposed Improvement (include channelward distance):

adding 1 PULL and 2 Jet ski LIFTS 6' OFF Bulk Head

Property Description:

Map: 16 Parcel: 96 Lot: 17 Section: 14B Block: Tax District: 3 Street Address: 26 Harlan Trace Subdivision: Ocean Pines Dwelling on lot: XX Dwelling under construction: Vacant: Commercial:

Owner: Vernon C Summers JR Phone No. 410-984-0194 Mailing Address: 26 Harlan Trace Berlin MD 21811 E-Mail Address: Atlanticcontracting21813@gmail.com

Contractor: Same Phone No.: Mailing Address: E-Mail Address:

Recorded Adjacent Property Owner: Andrew Debing Property Address: 24 Harlan Trace Berlin MD 21811-11096 Chambers of Unit 108 Woodstock, MD 21163 Tax Map: 16 Parcel: 96 Lot: 16 Section: 14B Block:

Recorded Adjacent Property Owner: Rick Landon Property Address: 28 Harlan Trace Berlin MD 21811 Tax Map: 16 Parcel: 96 Lot: 18 Section: 14B Block:

As the applicant, I attest that the information presented on this application, site plan and any written documentation attached hereto is known to be accurate. I understand that the proposed shoreline improvement will be constructed to meet or exceed minimum design standards adopted by the Department. Any deviation from these standards will require construction plans sealed by an engineer registered in the State of Maryland. I acknowledge that any falsification of information presented may result in revocation of this approval and of the subsequent Shoreline Construction Permit.

Vernon C Summers Signature Date 3-5-2024

\*\*\*\*\*

DEPT. USE ONLY: Notification Distribution Date: 3-13-24 Public Comment Deadline: 3-28-24 (15 calendar days) Department Approval Date: Expiration:

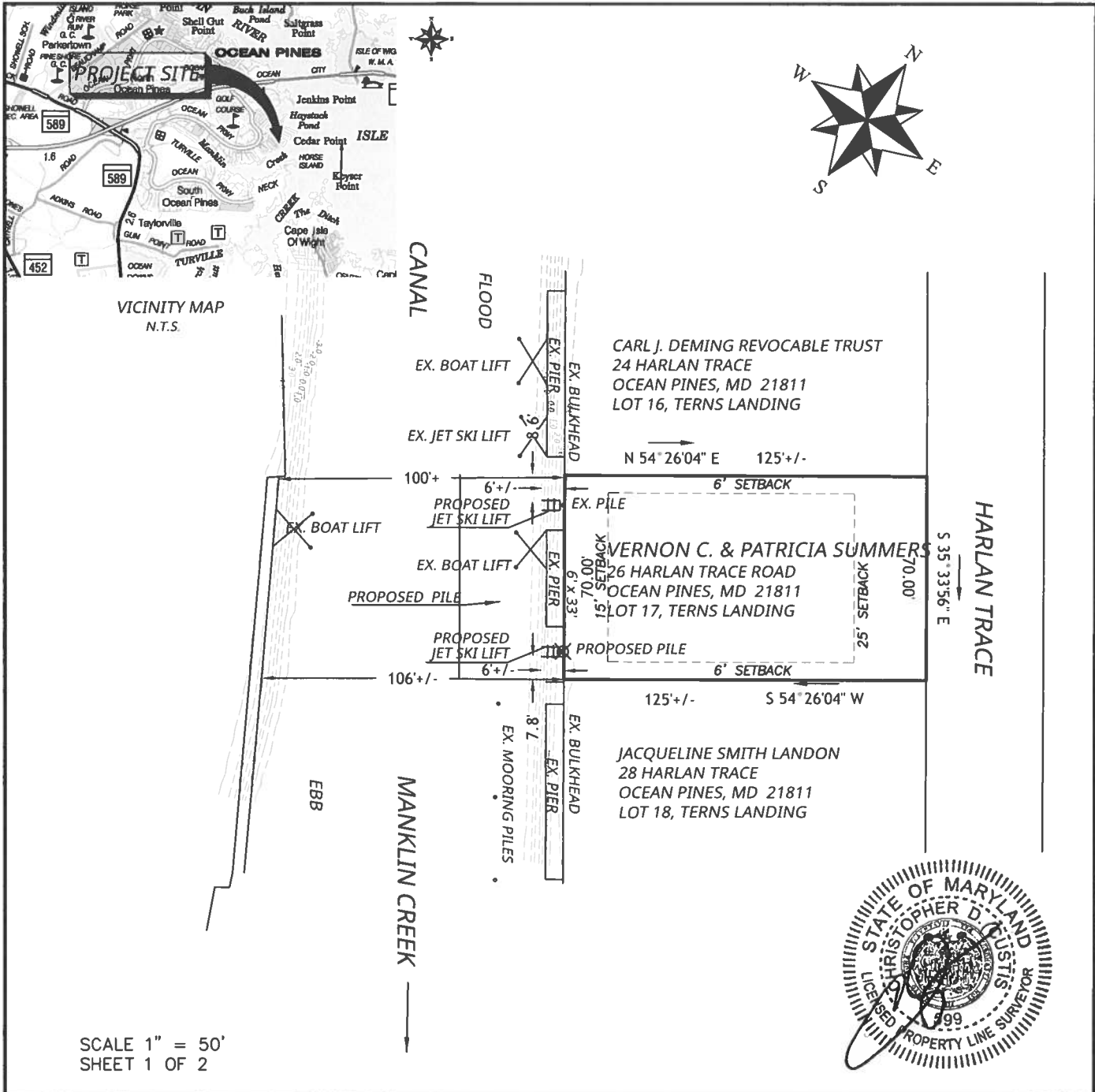

**TITLE** MARINE IMPROVEMENTS PLAN FOR **VERNON C. & PATRICIA M. SUMMERS**

COUNTY	WORCESTER	STATE	MD
TAX DISTRICT	03		
TAX MAP	GRID	PARCEL	
16	23	96	
DEED REF.	2572/121		
PLAT REF	121/05		
DATE	03/06/2024	REV	03/12/2024

- ⊙ IRON PIPE FD
- IRON ROD FD
- IRON ROD SET
- CONC. MONU FD.
- ▣ CONC MONU SET
- △ UNMARKED POINT
- ⊗ MAG NAIL SET
- ◆ MAG NAIL FD
- DITCH
- LICENSE EXPIRATION 05/25

**Chris Custis SURVEYING**

410.726.3576  
P.O. BOX 786  
PRINCESS ANNE, MD 21853  
Surveying, Topography, Flood Elevations  
Construction Layout, Terrain Modeling, Consulting  
cdcsurveying@gmail.com

**PROPOSED PILE**

CLASS "B" WOOD PILE BOLTED TO EXISTING WHALERS FOR JET SKI LIFT  
 L=25' (TOTAL) - 12'-14' EMBEDDED  
 JET SKI LIFT TO EXTEND CHANNEL WARD 6'+/-

SEE DETAIL FOR JET SKI LIFT CONSTRUCTION SPECIFICATIONS

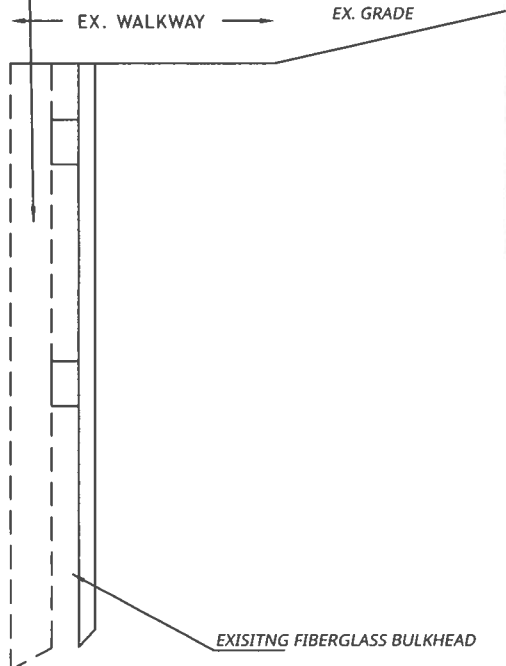

PILE AND BULKHEAD CROSS SECTION NOT TO SCALE

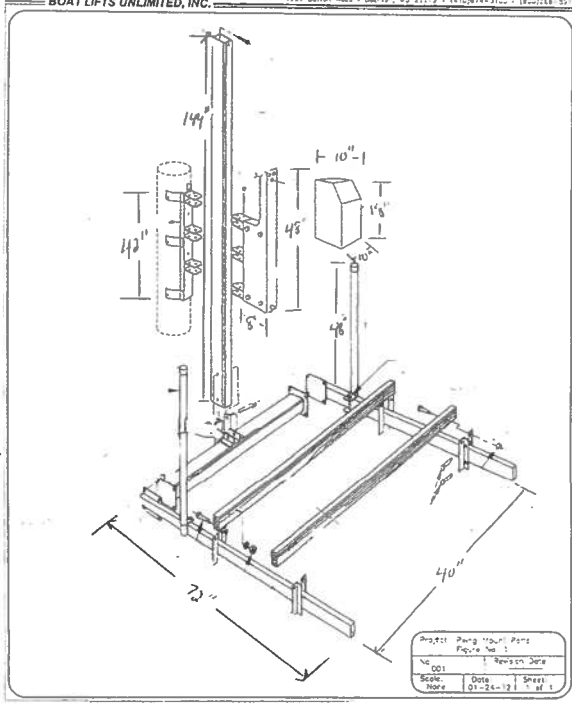

JET SKI LIFT DETAIL NOT TO SCALE

ELEVATIONS FOR MHHW AND MLLW ARE BASED ON NOAA TIDES & CURRENTS FOR OCEAN CITY, MD  
 BATHYMETRIC SURVEY FROM NOAA ELEVATION/LIDAR  
 MLLW & MHHW WITH BULKHEAD FACE. NO VEGETATION VISIBLE.  
 NO SUBMERGED AQUATIC VEGETATION NOTED ON STATE RESOURCES MAPS, (MERLIN)

TITLE MARINE IMPROVEMENTS PLAN FOR VERNON C. & PATRICIA M. SUMMERS

COUNTY	WORCESTER	STATE	MD
TAX DISTRICT	03		
TAX MAP	GRID	PARCEL	
16	23	96	
DEED REF.	2572/121		
PLAT REF	121/05		
DATE	03/06/2024	REV	03/12/2024

- ⊙ IRON PIPE FD
- IRON ROD FD
- IRON ROD SET
- CONC. MONU FD.
- CONC MONU SET
- △ UNMARKED POINT
- ⊗ MAG NAIL SET
- ◆ MAG NAIL FD
- ===== DITCH
- LICENSE EXPIRATION 05/25



**Chris Custis SURVEYING**

410.726.3576  
 P.O. BOX 786  
 PRINCESS ANNE, MD 21853  
 Surveying, Topography, Flood Elevations  
 Construction Layout, Terrain Modeling, Consulting  
 cdcsurveying@gmail.com















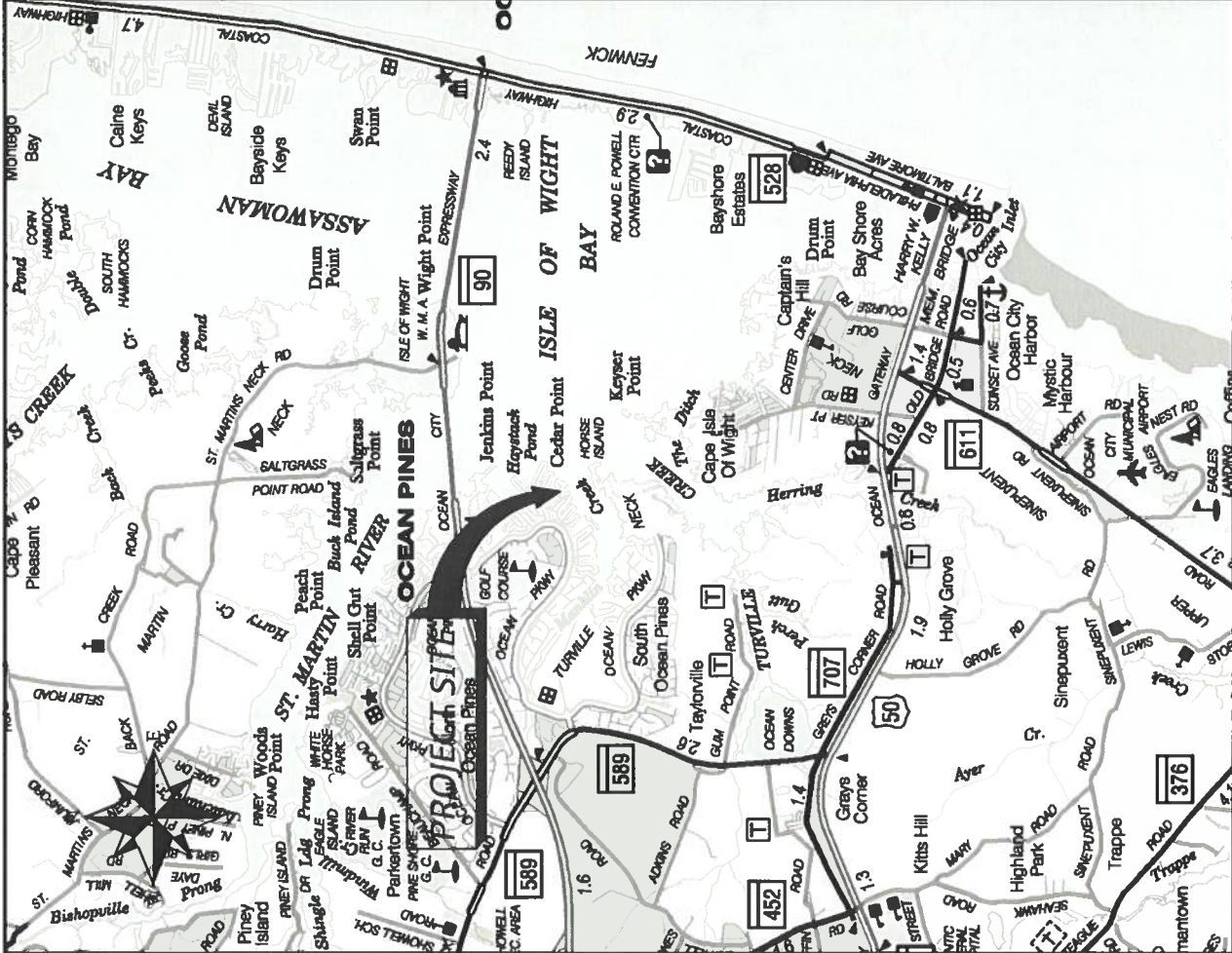

**VICINITY MAP & AERIAL PHOTO**  
**PROJECT: JET SKI LIFT**

PROPOSED PROJECT FOR:

VERNON C. & PATRICIA SUMMERS PROPERTY ADDRESS:  
 26 HARLAN TRACE  
 OCEAN PINES, MD 21811



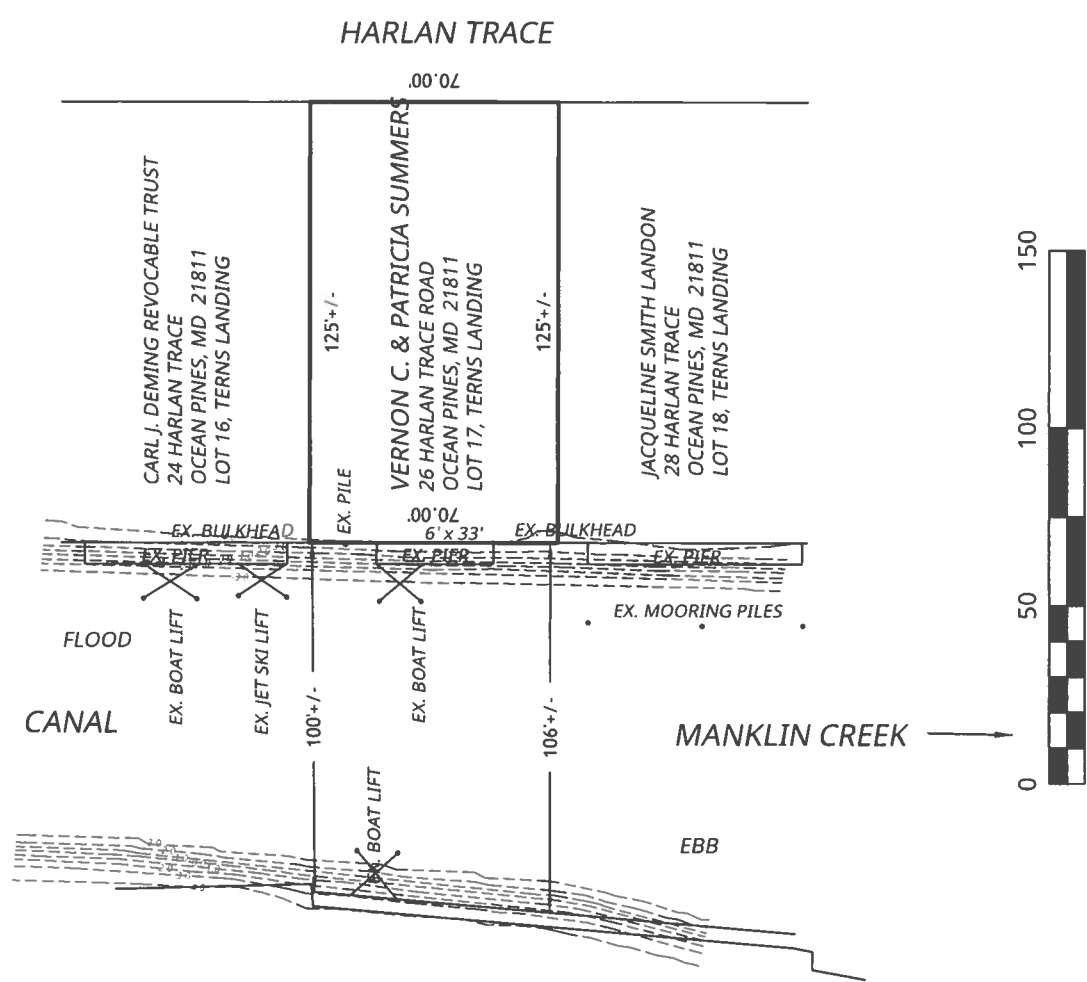
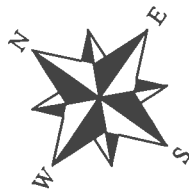

### EXISTING SITE CONDITIONS

PROJECT: JET SKI LIFT

PROPOSED PROJECT FOR:

VERNON C. & PATRICIA SUMMERS PROPERTY ADDRESS:  
26 HARLAN TRACE  
OCEAN PINES, MD 21811

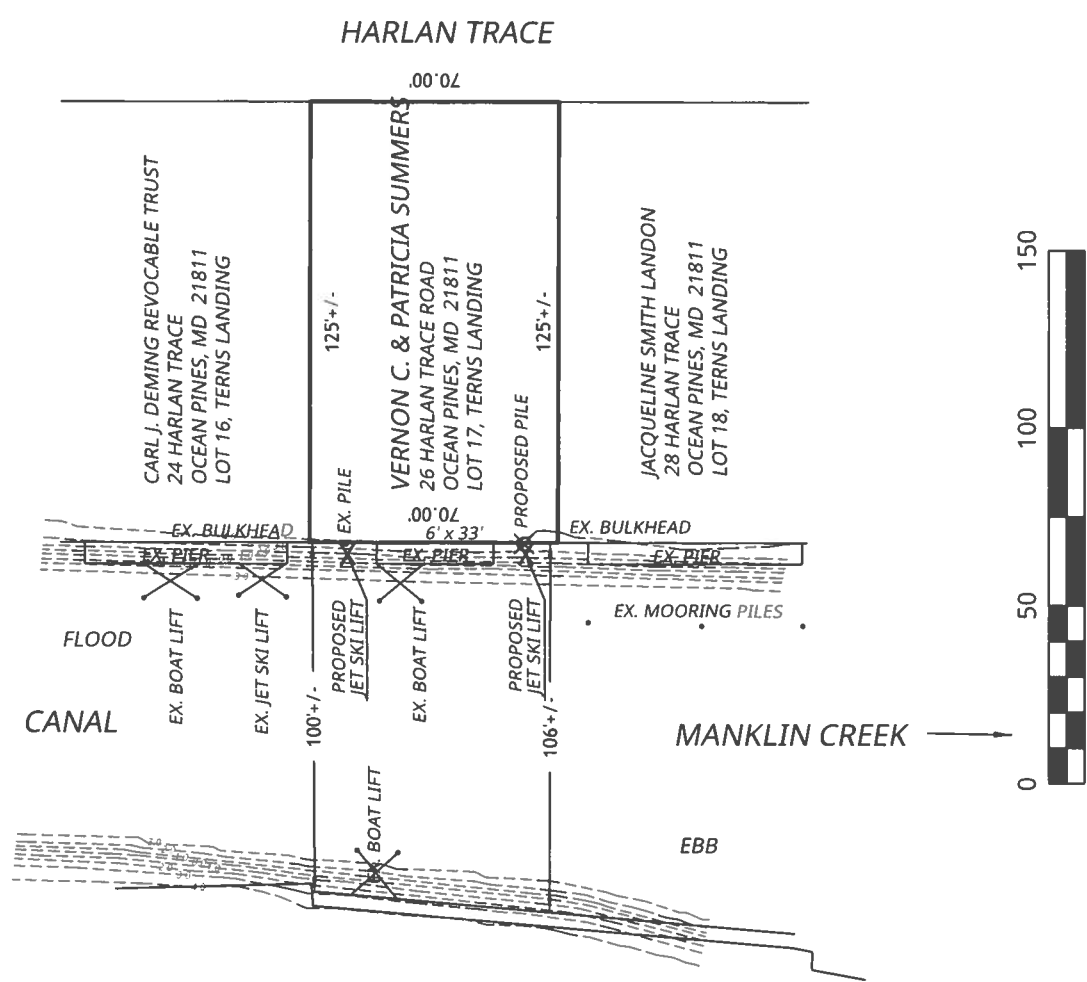
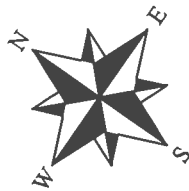

### PROPOSED SITE CONDITIONS

PROJECT: JET SKI LIFT

PROPOSED PROJECT FOR:  
VERNON C. & PATRICIA SUMMERS PROPERTY ADDRESS:  
26 HARLAN TRACE  
OCEAN PINES, MD 21811



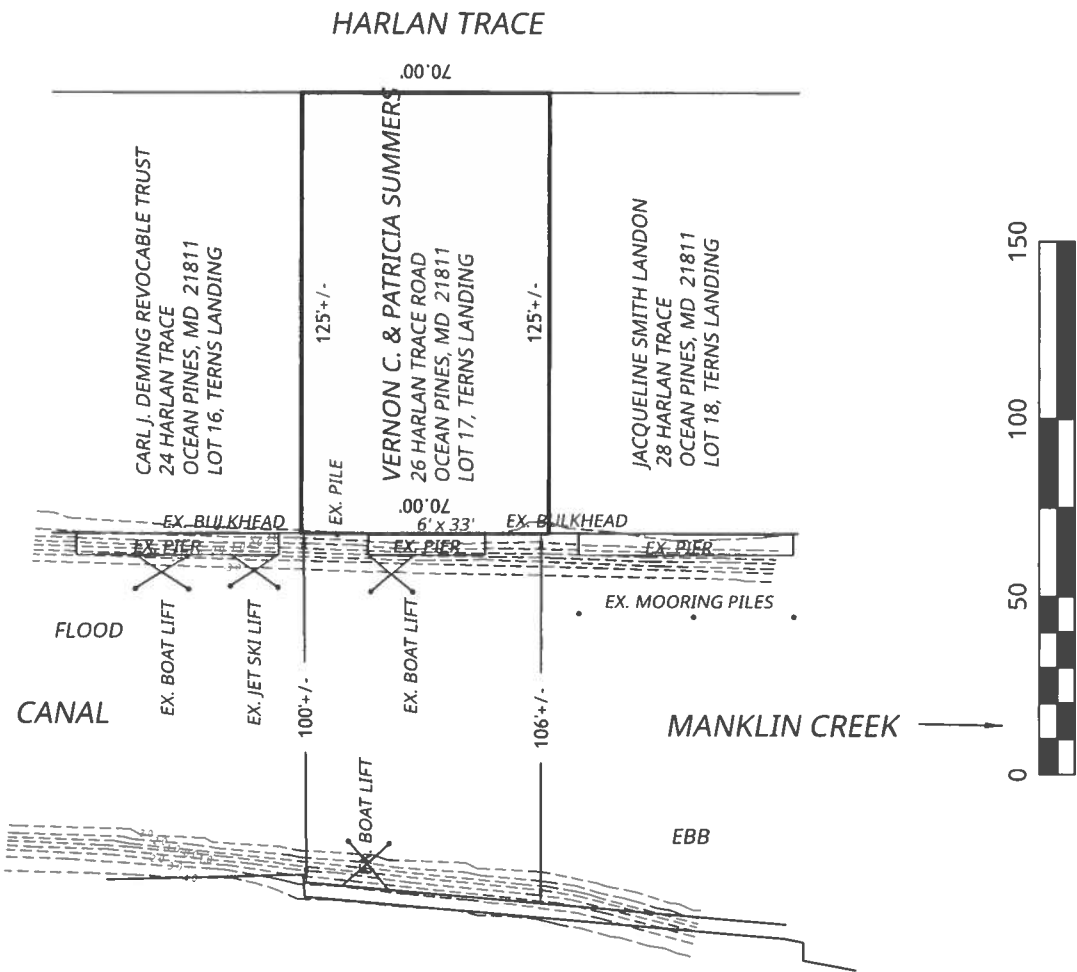
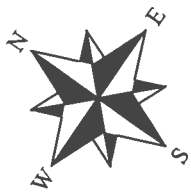

HARLAN TRACE

CARL J. DEMING REVOCABLE TRUST  
24 HARLAN TRACE  
OCEAN PINES, MD 21811  
LOT 16, TERNS LANDING

VERNON C. & PATRICIA SUMMERS  
26 HARLAN TRACE ROAD  
OCEAN PINES, MD 21811  
LOT 17, TERNS LANDING

JACQUELINE SMITH LANDON  
28 HARLAN TRACE  
OCEAN PINES, MD 21811  
LOT 18, TERNS LANDING

CANAL

FLOOD

EX. BOAT LIFT

EX. JET SKI LIFT

100 +/-

BOAT LIFT

EX. BOAT LIFT

106 +/-

EX. MOORING PILES

MANKLIN CREEK

EBB



**EXISTING SITE CONDITIONS**

PROJECT: JET SKI LIFT

PROPOSED PROJECT FOR:

VERNON C. & PATRICIA SUMMERS PROPERTY ADDRESS:  
26 HARLAN TRACE  
OCEAN PINES, MD 21811

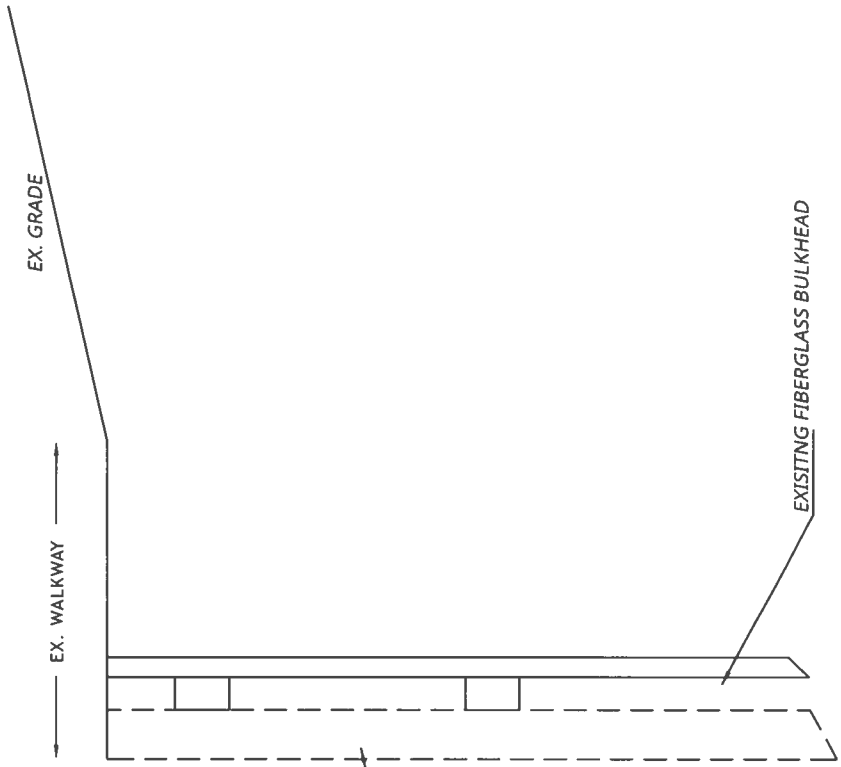

**PROPOSED PILE**

CLASS "B" WOOD PILE BOLTED TO  
 EXISTING WHALERS FOR JET SKI  
 LIFT  
 L=25' (TOTAL) - 12'-14' EMBEDDED  
 JET SKI LIFT TO EXTEND CHANNEL  
 WARD 4'+/-

MHHW = 0.86 (NAVD 88)

MLLW = -1.71 (NAVD 88)

ELEVATIONS FOR MHHW AND MLLW ARE BASED ON  
 NOAA TIDES & CURRENTS FOR OCEAN CITY, MD  
 BATHYMETRIC SURVEY FROM NOAA ELEVATION/LIDAR

**PROPOSED SITE CONDITIONS**

PROJECT: JET SKI LIFT

PROPOSED PROJECT FOR:  
 VERNON C. & PATRICIA SUMMERS    PROPERTY ADDRESS:  
 26 HARLAN TRACE                    26 HARLAN TRACE  
 OCEAN PINES, MD 21811            OCEAN PINES, MD 21811