



DEPARTMENT OF  
ENVIRONMENTAL PROGRAMS

## Worcester County

GOVERNMENT CENTER  
ONE WEST MARKET STREET, ROOM 1306  
SNOW HILL, MARYLAND 21863  
TEL:410.632.1220 / FAX: 410.632.2012

LAND PRESERVATION PROGRAM  
STORMWATER MANAGEMENT  
SEDIMENT AND EROSION CONTROL  
SHORELINE CONSTRUCTION  
AGRICULTURAL PRESERVATION  
ADVISORY BOARD

WELL & SEPTIC  
WATER & SEWER PLANNING  
PLUMBING & GAS  
CRITICAL AREAS/FORESTRY  
COMMUNITY HYGIENE

February 22, 2022

This notification is to advise you that the Department has received and is presently reviewing the following request for a shoreline construction project:

Martin Willamosky - Request No. 2022-015 – Installation of 5'x13' pier with 5'x 30' angled L section. Install 13'x13' four piling boat lift with associated pilings. Maximum channelward extension 25'. This project is located at 10 Pintail Drive, Ocean Pines, also known as Tax Map 16, Parcel 50, Sec 14A, Lot 84. Third Tax District of Worcester County, Maryland.

The Department in considering this application will make specific findings of fact with regard to the environmental impact, navigational impact, recreational potential, commercial benefit to Worcester County, impact of the proposed construction upon the surrounding neighborhood and upon property values therein, and any other pertinent issues. Approval from the Department does not guarantee approval from any other applicable regulatory agencies.

**If you have an interest which may be adversely affected by the issuance of this permit, you are requested to notify this Department in writing within fifteen (15) calendar days which will end on March 9, 2022.**

Sincerely,

Brandy Whitlock  
Environmental Inspector

cc: Interested Parties  
David Bradford, Deputy Director  
File



WORCESTER COUNTY
SHORELINE CONSTRUCTION
APPLICATION

Request No.: 2022-015
Submission Date: 2/22/22

Major Construction (\$300.00) Minor Construction (\$150.00)

Written Description of Proposed Improvement (include channelward distance):

Installation of 5' x 13' pier with 5' x 30' angled L section. Maximum Channelward Extension 25'. Installation of 13' x 13' 4 piling boat lift with associate pilings.

Property Description:

Map: 0016 Parcel: 0050 Lot: 84 Section: 14A Block: Tax District: 03
Street Address: 10 Pintail Drive Ocean Pines MD 21811
Subdivision: 014A
 Dwelling on lot: Dwelling under construction: Vacant: Commercial:

Owner: Martin Williamowsky Phone No.
Mailing Address: 31 Beacon Hill Court Gaithersburg MD 20878
E-Mail Address: martinmosky@gmail.com

Contractor: Ocean City Boat Lifts Phone No.: 410-352-5095
Mailing Address: 12010 Industrial Park Rd. Unit 11 Bishopville MD 21813
E-Mail Address: oceancitylifts@aol.com

Recorded Adjacent Property Owner: Robert Vandornick 914 Pickett Lane Newark DE 19711
Property Address: 12 Pintail Drive Ocean Pines MD 21811
Tax Map: 0016 Parcel: 0050 Lot: 83 Section: 14A Block:

Recorded Adjacent Property Owner: Sandra and Fury Fecondo 63 Woodchuck Way Glen Mills PA 19342
Property Address: 8 Pintail Drive Ocean Pines MD 21811
Tax Map: 0016 Parcel: 0050 Lot: 85 Section: 14A Block:

As the applicant, I attest that the information presented on this application, site plan and any written documentation attached hereto is known to be accurate. I understand that the proposed shoreline improvement will be constructed to meet or exceed minimum design standards adopted by the Department. Any deviation from these standards will require construction plans sealed by an engineer registered in the State of Maryland. I acknowledge that any falsification of information presented may result in revocation of this approval and of the subsequent Shoreline Construction Permit.

Kayla Short 01-31-22
Owner/Applicant's Signature Date

\*\*\*\*\*

DEPT. USE ONLY:
Notification Distribution Date: 2/22/22 Public Comment Deadline: 3/9/22 (15 calendar days)
Department Approval Date: Expiration:

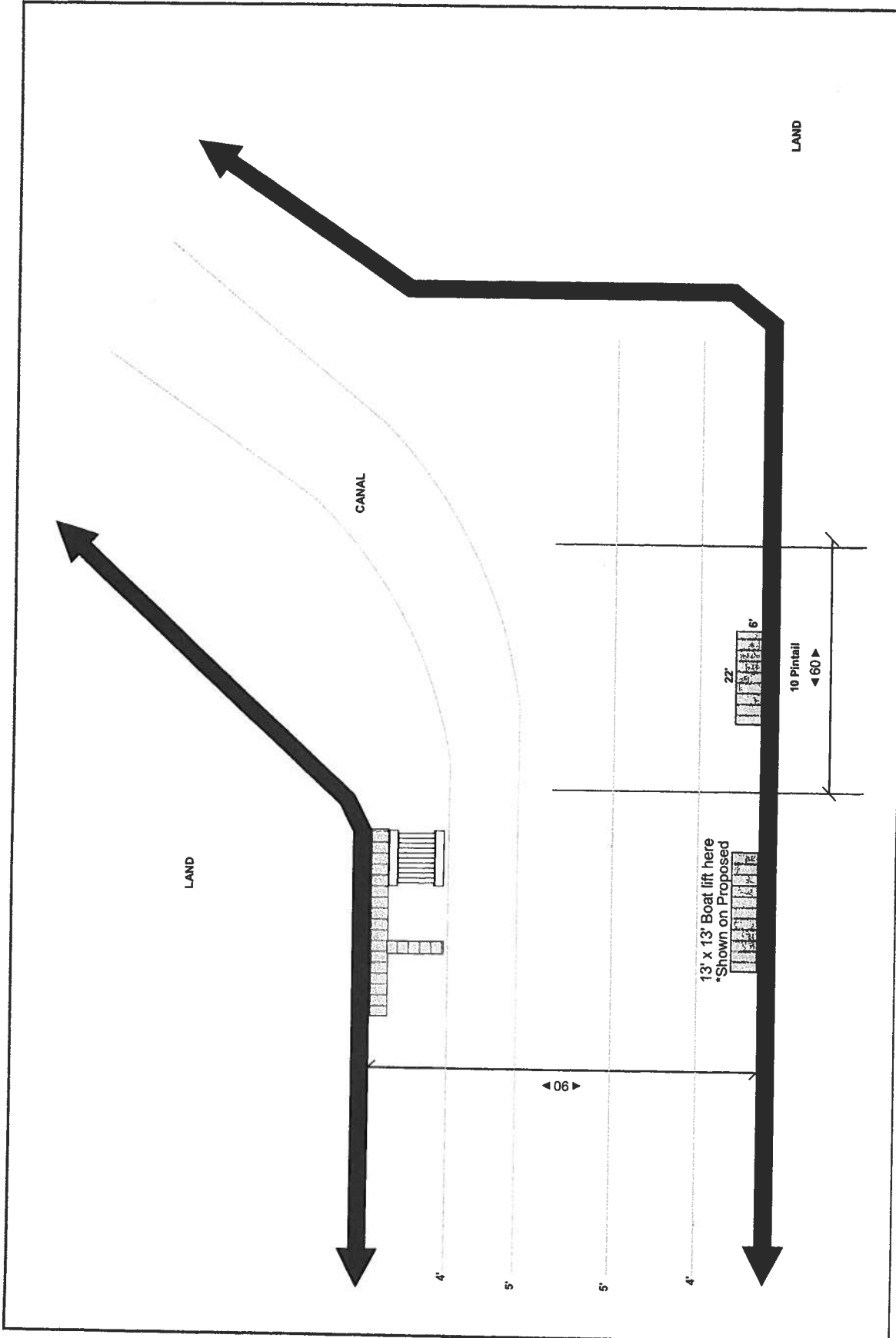

<b>Site:</b> 10 Pintail Drive Ocean Pines Work: Remove existing pier - Install 5' x 10' pier with 5' x 30' angled L and 4 pilings for 4 piling boat lift	<b>Customer:</b> Williamowsky Scale: 1/32" = 1'0"	<b>Project:</b> Existing Date: 01/26/2022	<b>Drawn:</b> K. Short Page: 1 of 3	443-614-8477 Pristine Permitting @AOL.com	Pristine Permitting 12010 Industrial Park RD Unit 11 Bishopville MD 21813
---	--	--	--	---	--

No known SAV

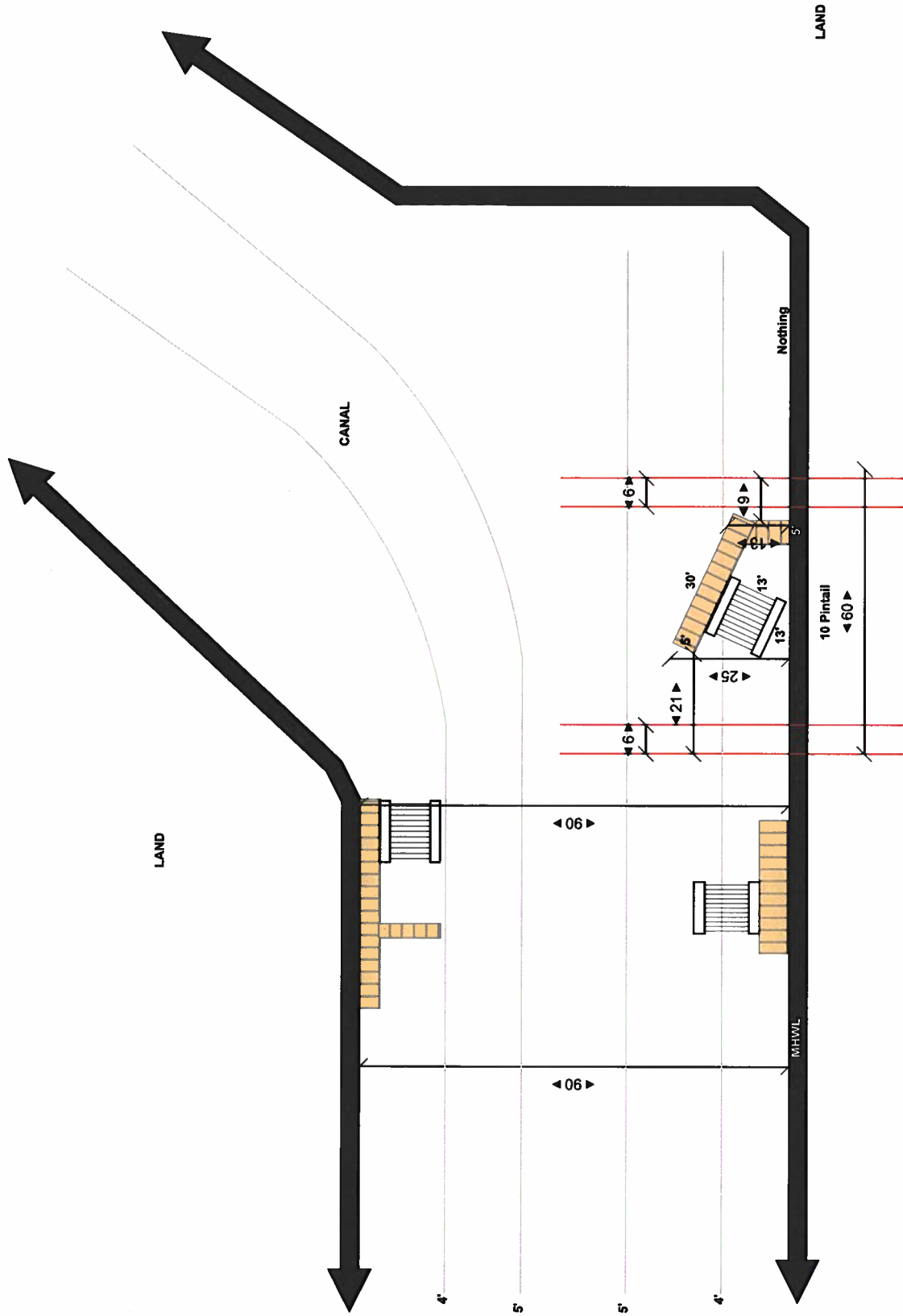

Site: **10 Pintail Drive Ocean Pines**  
Work: Remove existing pier - Install 5' x 10' pier with 5' x 30' angled L and 4 pilings for 4 piling boat lift

Customer: **Williamowsky**  
Scale: **1/32" : 1'0"**

Project: **Proposed**  
Date: **01/26/2022**

Drawn: **K. Short**  
Page: **2 of 3**

443-614-8477  
Pristine Permitting  
@AOL.com

Pristine Permitting  
12010 Industrial Park RD  
Unit 11  
Bishopville MD 21813

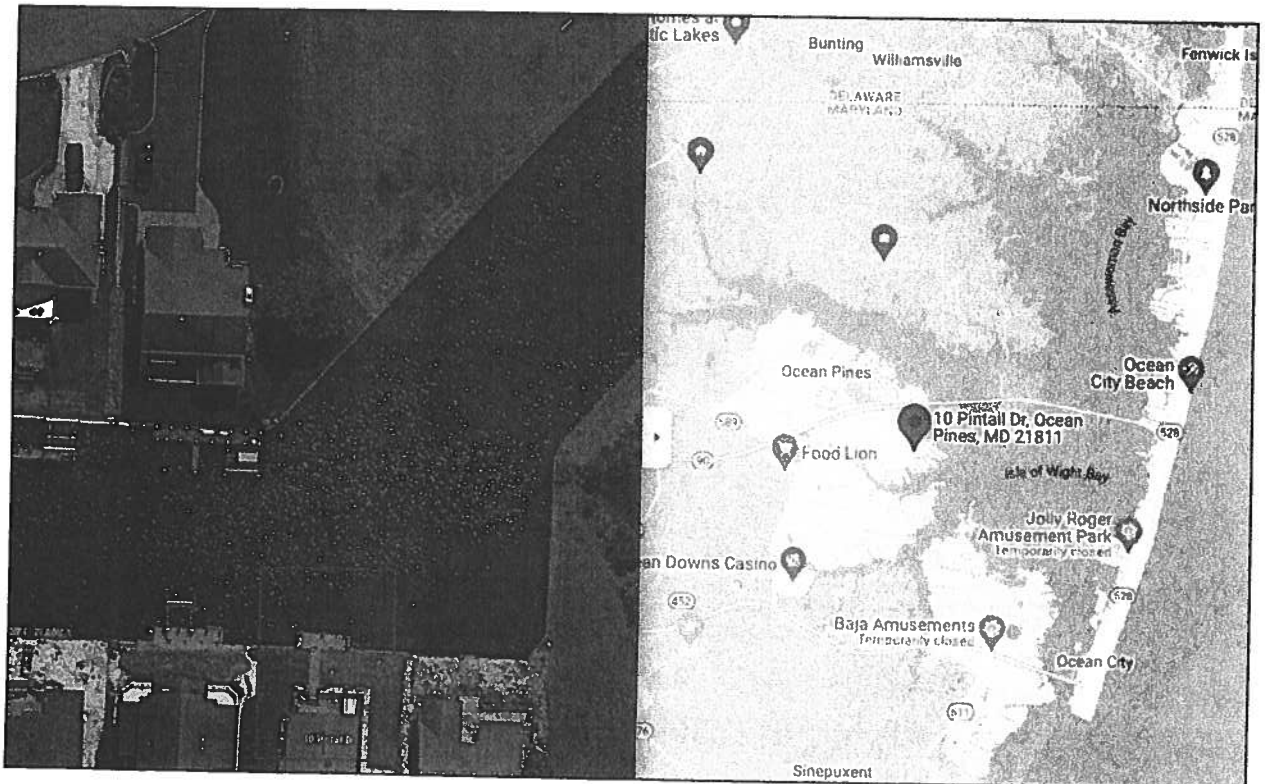
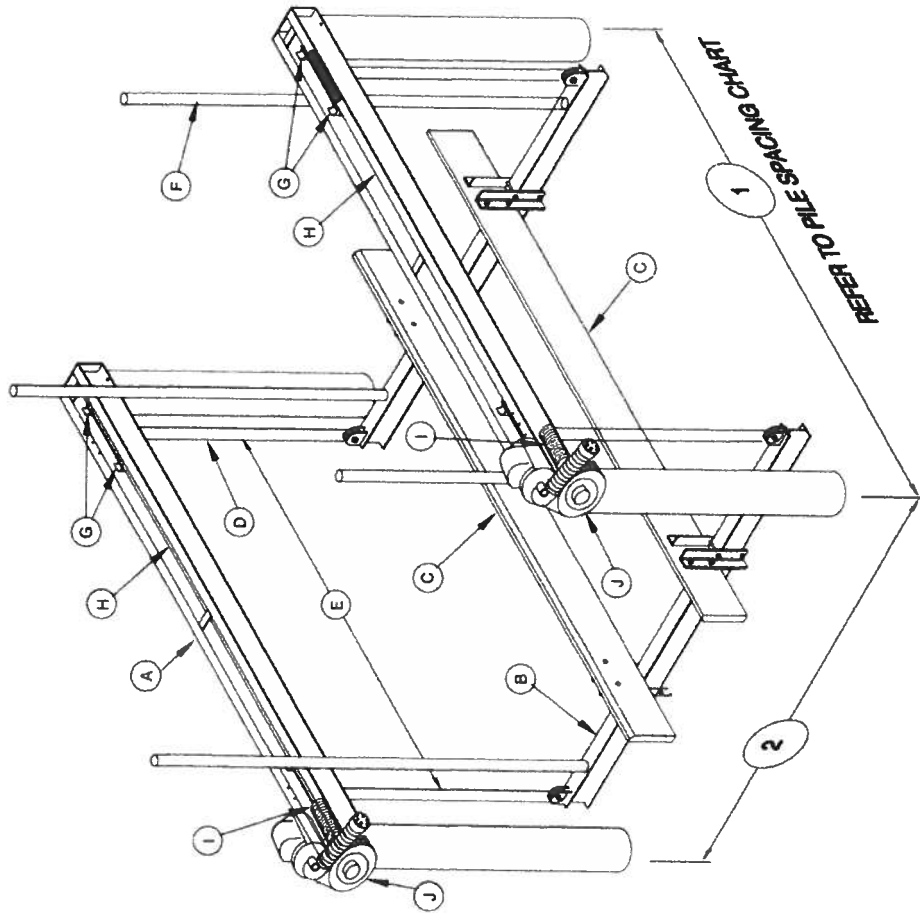

Williamstown

10



<b>FOR AGENCY USE ONLY</b>	<b>ABBREVIATED JOINT FEDERAL / STATE APPLICATION FOR THE ALTERATION OF ANY TIDAL WETLAND AND/OR TIDAL WATERS IN MARYLAND</b>						MDE Permit #:	
							Tracking #:	
MDSPPG Category:	<input type="checkbox"/> Major	<input type="checkbox"/> Minor	<input type="checkbox"/> 240-day	<input type="checkbox"/> 90-Day	<input type="checkbox"/> MHT	<input type="checkbox"/> WHD	<input type="checkbox"/> PN	MDE AI #:
This abbreviated application should only be used for projects that are eligible for federal authorization under the Maryland State Programmatic General Permit (MDSPPG).							MDE Reviewer:	County:

Pre-Application Meeting Held? <input type="checkbox"/> with MDE <input type="checkbox"/> with USACE	AI#(if given):	*MAILING INSTRUCTIONS LOCATED ON 2 <sup>ND</sup> PAGE OF THIS APPLICATION*
Reviewer's Name(s):		

Applying for:	<input type="checkbox"/> Authorization <input type="checkbox"/> Modification	<b>MDE APPLICATION REVIEW FEE REQUIRED: PLEASE REFER TO THE MDE WEBSITE:</b> <a href="http://mde.maryland.gov/programs/Water/WetlandsandWaterways/Documents/Fee-Schedule-July2017.pdf">http://mde.maryland.gov/programs/Water/WetlandsandWaterways/Documents/Fee-Schedule-July2017.pdf</a>
---------------	---	---

**(Applicant will be copied on all correspondence, unless they opt out, BY INITIAL AND SIGNATURE, in Section 12)**

**1. APPLICANT INFORMATION:** (Please note that the applicant is not the contractor/agent applying on behalf of a property owner)

Name: Martin Williamowsky Home Telephone: ( ) 301-641-8516

Address: 31 Beacon Hill Court Email Address: \_\_\_\_\_

City: Gaithersburg State: MD Zip: 20878

**2. PROPERTY OWNER INFORMATION:** (If different from the Applicant)

Name: \_\_\_\_\_ Home Telephone: ( ) \_\_\_\_\_

Address: \_\_\_\_\_ Email Address: \_\_\_\_\_

City: \_\_\_\_\_ State: MD Zip: \_\_\_\_\_

**3. AUTHORIZED AGENT / PRINCIPAL CONTACT INFORMATION:**

Name: Pristine Permitting, LLC Telephone: ( ) 443-614-8477

Address: 12010 Industrial Park Rd. Unit 11 Email Address: pristinepermitting@aol.com

City: Bishopville MD 21813 State: \_\_\_\_\_ Zip: \_\_\_\_\_

**4. CONTRACTOR INFORMATION** (If currently unknown, required to be provided to MDE's Tidal Wetland Division prior to construction of project)

Company Name: Ocean City Boat Lifts & Marine Construction Inc.

Principal Contact: Jessica Short Email Address: oceancitylifts@aol.com

Marine Contractor MDE License #: 228(E) Telephone: ( ) 410-352-5095

**5. PROJECT DESCRIPTION:** (Attach additional pages if necessary)

Installation of 5' x 13' pier with 5' x 30' angled L. Max Channelward Ext. 25' Installation of 4 pilings for 13' x 13' 4 piling boat lift

**6. PROJECT PURPOSE:** (Check all that apply)

<input type="checkbox"/> Improve Navigable Access	<input type="checkbox"/> Shore Erosion Control	<input type="checkbox"/> Fill
<input type="checkbox"/> Beach Nourishment	<input type="checkbox"/> Create/Improve Habitat	<input type="checkbox"/> Erosion/Sediment Control
<input type="checkbox"/> Create/Improve Infrastructure	<input type="checkbox"/> Utility Installation	<input checked="" type="checkbox"/> Residential/Commercial Development
<input type="checkbox"/> Other: (describe) _____		

**7. PROJECT LOCATION:** (If project site has no address, please include the lot # and/or nearest address with a clear description of the site)

County: Worcester Name of Waterway: Isle of Wight Bay

Site Address or Location: 10 Pintail Drive Ocean Pines MD 21811

Latitude: 38.38 Longitude: 75.13

Directions from nearest intersection of two state roads: Left onto Beauchamp Rd , right onto St. Martins Ln, Ocean Pines pkwy, left onto Pintail Drive, destination is on right.

**8. FEDERALLY AUTHORIZED CIVIL WORKS PROJECTS:** Is the project located in, on, or adjacent to a U.S. Army Corps of Engineers' federally authorized civil works project, structure, property, or easement (e.g., federal navigation channel, flood control levees, dams and reservoirs, lake property, etc.)?  Yes  No

If yes, has a review pursuant to 33 U.S.C. 408 (Section 408) been initiated?  Yes  No

**9. BEST MANAGEMENT PRACTICES VERIFICATION:** I verify that my project will meet all Endangered Species Act Best Management Practices applicable to work in tidal waters and wetlands as required by the MDSPPG (see Section VII.B.4.c.i-iii).

Yes  No  Unknown

*Refer to the application instructions and the MDSPPG for additional information regarding these Best Management Practices.*

**10. TYPE OF PROJECT** (check all that apply and provide all applicable information):

**This abbreviated application should only be used for projects that are eligible for federal authorization under the Maryland State Programmatic General Permit (MDSPGP). Please refer to the MDSPGP for eligible activities.**

Work Proposed	Overall Length	Average Width	Volume of Fill Material	Total Area Impacted (Sq. Ft.)		Maximum Distance Channelward from Mean High Water Line (Ft.)	New Work	Maintenance /Repair	Work Started/Completed
	(Ft.)	(Ft.)	(cu. yards.)	Permanent	Temporary				
<input type="checkbox"/> Bulkhead							<input type="checkbox"/>	<input type="checkbox"/>	<input type="checkbox"/>
<input type="checkbox"/> Revetment							<input type="checkbox"/>	<input type="checkbox"/>	<input type="checkbox"/> *
<input type="checkbox"/> Breakwater							<input type="checkbox"/>	<input type="checkbox"/>	<input type="checkbox"/> *
<input type="checkbox"/> Groins, Jetties, or Low Profile Sill							<input type="checkbox"/>	<input type="checkbox"/>	<input type="checkbox"/> *
<input type="checkbox"/> Living Shoreline (vegetated area)							<input type="checkbox"/>	<input type="checkbox"/>	<input type="checkbox"/> *
<input type="checkbox"/> Pier							<input type="checkbox"/>	<input type="checkbox"/>	<input type="checkbox"/> *
<input type="checkbox"/> Finger Pier							<input type="checkbox"/>	<input type="checkbox"/>	<input type="checkbox"/> *
<input type="checkbox"/> Platform							<input type="checkbox"/>	<input type="checkbox"/>	<input type="checkbox"/> *
<input type="checkbox"/> Pile(s) (#: )   <input type="checkbox"/> Osprey Pole							<input type="checkbox"/>	<input type="checkbox"/>	<input type="checkbox"/> *
<input type="checkbox"/> Boat Lift (including support piles)	13	13					<input type="checkbox"/>	<input type="checkbox"/>	<input type="checkbox"/> *
<input type="checkbox"/> Boat Ramp							<input type="checkbox"/>	<input type="checkbox"/>	<input type="checkbox"/> *
<input type="checkbox"/> Utility Line							<input type="checkbox"/>	<input type="checkbox"/>	<input type="checkbox"/> *
<input type="checkbox"/> Construction Access/Mats							<input type="checkbox"/>	<input type="checkbox"/>	<input type="checkbox"/> *
<input type="checkbox"/> Dredging (Maintenance or New Minor)							<input type="checkbox"/>	<input type="checkbox"/>	<input type="checkbox"/> *
<input type="checkbox"/> Hydraulic / <input type="checkbox"/> Mechanical							<input type="checkbox"/>	<input type="checkbox"/>	<input type="checkbox"/> *
<input type="checkbox"/> Other:							<input type="checkbox"/>	<input type="checkbox"/>	<input type="checkbox"/> *

\*For any work started or completed, please clearly and accurately depict those portions of the project on the plans

**11. DESCRIPTION OF AVOIDANCE, MINIMIZATION, AND COMPENSATION:** Please be advised that unavoidable losses of tidal wetlands and/or aquatic resources may require compensatory mitigation. Please provide a separate sheet(s) that addresses the proposed project's avoidance, minimization, and compensation (if required) which includes any clearing, grading, or excavation required before, during, and after the proposed project.

**12. STATE CERTIFICATION AND FEDERAL PRIVACY ACT STATEMENT:**

Application is hereby made for a permit or permits to authorize the work described in this application. I hereby designate and authorize the agent named above to act on my behalf in the processing of this application and to furnish any information that is requested. I certify that the information on this form and on the attached plans and specifications is true and accurate to the best of my knowledge and belief. I understand that any of the agencies involved in authorizing the proposed works may request information in addition to that set forth herein as may be deemed appropriate in considering this proposal. I grant permission to the agencies responsible for authorization of this work, or their duly authorized representative, to enter the project site for inspection purposes during working hours. I will abide by the conditions of all permit(s) or license(s) if issued and will not begin work without the appropriate authorization. I also certify that the proposed works are consistent with Maryland's Coastal Zone Management Plan.

Authorities: Rivers and Harbors Act, Section 10, 33 USC 403; Clean Water Act, Section 404, 33 USC 1344; Marine Protection, Research, and Sanctuaries Act, Section 103, 33 USC 1413; Regulatory Programs of the Corps of Engineers, 33 CFR 320-332. Principal Purpose: Information provided on this JPA will be used in evaluating the application for a permit. Routine Uses: This information may be shared with the Department of Justice and other federal, state, and local government agencies, and the public and may be made available as part of a public notice. Submission of requested information is voluntary, however, if information is not provided, the permit application cannot be evaluated nor can a permit be issued.

I am the property owner/applicant and do not want to be contacted by MDE. All correspondence should occur with my authorized agent/principal contact designated in Section 3, located on the 1<sup>st</sup> page of this application. (By initializing the box, you are acknowledging that you will not receive any correspondence directly from MDE). I understand a copy of MDE's final decision regarding this application will be sent to me. This opt-out option does not apply to the U.S. Army Corps' correspondence, which will continue to be with the applicant/permittee.

**PROPERTY OWNER MUST SIGN:** *Martin Williamowsky*      **Date** 01-31-22

**IMPORTANT:**

PLEASE MAIL SEVEN COPIES OF THE APPLICATION, SITE PLAN, AND VICINITY MAP (WITH PROJECT LOCATION PINPOINTED) TO:  
MDE/WATER AND SCIENCE ADMINISTRATION  
REGULATORY SERVICES SECTION  
MONTGOMERY PARK BUSINESS CENTER – ST 430  
1800 WASHINGTON BOULEVARD  
BALTIMORE, MD 21230-1708  
(410) 537-3752

SEND THE APPLICABLE APPLICATION FEE, ALONG WITH A COPY OF THE FIRST PAGE OF THE APPLICATION TO:  
MDE  
P.O. BOX 2057  
BALTIMORE, MD 21203-2057  
PCA: 13910 OBJ: 4142  
PLEASE REFER TO OUR WEBSITE  
<http://mde.maryland.gov/programs/Water/WetlandsandWaterways>  
FOR FURTHER INSTRUCTIONS.